

RECEIVED

AUG 21 1997

MPCA - DULUTH  
DULUTH, MN.

# Excavation Report

for the

Former Gravel Pit  
6812 Hwy 194

Saginaw, Minnesota  
MPCA Leak #10326

279

Prepared for:

Coons Aggregate Supply  
4607 Canosia Road  
Saginaw, MN 55779

Prepared by:

Earth Burners, Inc.  
PO Box 16083  
Duluth, MN 55816  
(218) 628-0454

August 20, 1997

# EXCAVATION REPORT WORKSHEET FOR PETROLEUM RELEASE SITES

Fact Sheet #3.7

April 1997

Complete the information below and submit to the Minnesota Pollution Control Agency (MPCA) Tanks and Emergency Response Section to document excavation and treatment of petroleum contaminated soil. Conduct excavations in accordance with "Excavation of Petroleum Contaminated Soil" (Fact Sheet #3.6). Please attach any available preliminary site investigation reports to this excavation report. Attach additional pages if necessary. Please type or print clearly.

The excavation reporting deadline is 10 months from the date of receipt of the standard letter. A shorter deadline may be established by MPCA staff for high priority sites.

## I. BACKGROUND

**A. Site:** Former gravel pit  
**Location/Address:** 6812 Highway 194  
Saginaw, MN 55779  
**County:** St. Louis  
**MPCA Site ID#:** Leak 00010279  
**Project Manager:** Steve Leppala

**B. Tank Owner/Operator:** Coons Aggregate Supply  
**Mailing Address:** 4607 Canosia Road  
Saginaw, MN 55779  
**Telephone:** (218) 729-7544

**C. Excavating Contractor:** Wisconsin Companies  
**Contact:** Chris Larson  
**Telephone:** (218) 729-7544  
**Tank Contractor Certification Number:** NA

**D. Consultant:** Earth Burners, Inc.  
**Contact:** Jim Warren  
**Address:** PO Box 16083  
Duluth, MN 55816-0083  
**Telephone:** (218) 628-0454

**E. Others on-site during site work (e.g., fire marshal, local officials, MPCA staff, etc.):** \_\_\_\_\_

**NOTE:** *If person other than tank owner and/or operator is conducting the cleanup, provide name, address, and relationship to site on a separate attached sheet.*

## II. DATES

- A. Date release reported to MPCA: June 27, 1997
- B. Site work performed

Work performed	Date
Supervised the excavation of 200 cubic yards of soil. Conducted field screening and soil sample collection.	July 24, 1997

## III. SITE AND RELEASE INFORMATION

- A. Describe the land use and pertinent geographic features within 1,000 feet of the site. The site is located in a rural area northwest of Duluth, Minnesota. The site was operated in the past as a borrow pit. A fairly large surface water created as a result of the gravel mining is located south and southeast of the excavation basin. Single family residences are scattered within 1,000 feet of the site. There was no potable water service at the site.
- B. Provide the following information for all the tanks at the site at the time of release.

Tank	Type	Capacity	Contents	Age	Status	Condition
001	AST	12,000	Fuel oil	25+/-	Removed	Good

- C. Describe the status of other components of the tank system(s) for the tanks listed above. No significant problem areas were observed with the piping of the tank.
- D. Identify and describe the source or suspected source(s) of the release: Based on field observation the release originated from spillage from delivering the product to equipment over the period of operation of the borrow pit. The petroleum migrated down slope into and beneath the tank basin.
- E. What was the volume of the release? Unknown
- F. When did the release occur? Over the time of operation of the pit.
- G. Describe source of on-site drinking water. No water service of the site.

#### IV. EXCAVATION INFORMATION

- A. **Dimensions of excavation:** 43' x 40' x 3.5' average dimensions. A 0.5 to 3.0 foot layer of overburden was removed to access the contaminated soil.
- B. **Original tank backfill material (sand, gravel, etc.):** NA
- C. **Native soil type (clay, sand, etc.):** Gravel
- D. **Quantity of contaminated soil removed for treatment (cubic yards):** 200
- E. **Were new tanks installed at the site? No** If yes how much soil was excavated to accomodate the installation of the new tanks?
- F. **Was groundwater encountered or was there evidence of a seasonally high groundwater table?** No
- G. **If groundwater was not encountered during the excavation, what is the expected depth of groundwater.** 15'
- H. **If a soil boring was required (see Fact Sheet #3.6, "Excavation of Petroleum Contaminated Soil", Part VI Additional Investigation) describe the soil screening and analytical results. Attach the boring logs and laboratory results to this report.** No soil boring was completed at the time of the excavation.
- I. **If no soil boring was required, explain.** All of the contaminated soils above MPCA action levels were removed from the basin.
- J. **If ground water was encountered or if a soil boring was conducted, was there evidence of ground water contamination? Describe this evidence of contamination, e.g., free product (specify thickness), product sheen, groundwater in contact with petroleum contaminated soil, water analytical results, etc.** NA

**NOTE:** *If free product was observed, contact MPCA staff immediately as outlined in "Fact Sheet #3.3, "Free Product: Evaluation and Recovery."*

- K. **Was bedrock encountered in the excavation? At what depth? Bedrock was not encountered during the excavation.**
- L. **Were there other unique conditions associated with this site? If so, explain.**  
None

## V. SAMPLING INFORMATION

**A. Briefly describe the field screening methods used to distinguish contaminated from uncontaminated soil:** Contaminated soils were distinguished from clean soils using a Hnu Model DL-101 Photoionization Detector (PID). Headspace analysis was accomplished following MPCA Fact Sheet #3.22 "Soil Sample Collection and Analysis Procedures". The samples were allowed to develop for at least 10 minutes before PID readings were recorded.

**B. List all soil vapor headspace analysis results. Indicate sampling locations using sample codes. Samples collected at different depths at the same location should be labeled R-1A (2 feet), R-1B (4 feet), R-1C (6 feet), etc. If the sample was collected from the sidewall or bottom after excavation was complete, label it S-1 (for "sidewall") or B-1 (for "bottom"). Be sure the sample codes correspond with the site map required in Part VI, below.**

Sample Code	Soil Type	PID Reading	Comments
R1-5'	Silty gravel	0.0	TP-1
R2-3'	Gravel	60.0	Center
R3-4'	Silty gravel	16.7	NW corner
R4-5'	Silty gravel	0.0	TP-2
R5-3'	Silty gravel	22.7	TP-3
R6-5'	Silty gravel	0.0	TP-4
R7-3'	Silty gravel	0.5	North sidewall
R8-3'	Pea gravel	0.2	West sidewall
R9-7'	Silty gravel	2.0	Bottom
R10-3'	Pea gravel	22.1	East sidewall
R11-6'	Silty gravel	1.6	Bottom
R12-3'	Pea gravel	16.7	NE corner
R13-6'	Silty gravel	6.7	Bottom
R14-2'	Pea gravel	81.0	Bottom
R15-2'	Pea gravel	80.0	Bottom
R16-4'	Hardpan	1.2	Bottom
R17-4.5	Hardpan	0.1	Bottom
R18-2'	Pea gravel	66.2	NE Bottom
R19-1'	Hardpan	2.1	NE Bottom

Sample Code	Soil Type	PID Reading	Comments
R20-1.5'	Pea gravel	15.1	SW Bottom
R21-2'	Hardpan	1.0	SW Bottom
R22-1'	Hardpan	2.1	NW Bottom
R23-1'	Hardpan	2.5	SE Bottom

NOTE: All readings are above the background level of 1.0 ppm.

- C. Was the removed soil placed back into the excavation basin? No  
 If no, please complete Part VIII: Soil Treatment Information section. If yes, a Limited Site Investigation is necessary. No
- D. Briefly describe the soil analytical sampling and handling procedures used: Analytical soil samples were collected following MPCA Fact Sheet #3.22 - "Excavation of Petroleum Contaminated Soil." The BTEX analytical samples were preserved with methanol in tared 60 ml bottles from the analytical lab. Approximately 25 grams of soil were collected for the DRO and BTEX samples.
- E. List below the soil sample analytical results from bottom and sidewall samples. Code the samples with sampling depths in parentheses as follows: sidewall samples S-1 (8 feet), S-2 (4 feet), etc.; bottom samples B-1 (13 feet), B-2 (14 feet), etc. Be sure the sample codes correspond to the site map required in Part VI. Do not include analyses from the stockpiled soils.

Table 1 Analytical results from petroleum related compounds (ppm)

Sample	DRO	Benzene	Toluene	E-benzene	Xylene
97057 B1 - 13'	<10.0	<0.05	<0.05	<0.05	<0.15
97057 B2 - 13'	<10.0	<0.05	<0.05	<0.05	<0.15

NOTE: Copies of laboratory reports and chain of custody forms are attached

## VI. FIGURES

Attach the following figures to this report:

1. Site location map.
2. Site map(s) drawn to scale illustrating the following:
  - a. Location (or former location) of all present and former tanks, lines, and dispensers;
  - b. location of other structures (buildings, canopies, etc.);
  - c. Adjacent city, township, or county roadways;
  - d. Final extent and depth of excavation;

- e. Location of soil screening samples (e.g. R-1), soil analytical samples (e.g., S-1 or B-1), and soil borings (e.g. SB-1). Also, attach all boring logs.
- f. North arrow, bar scale and map legend.
- g. Provide location of any on-site water wells. If on-site water wells exist please provide well logs and/or construction diagrams.

## VII. SUMMARY

**Briefly summarize evidence indicating whether additional investigation is necessary at the site, as discussed in Parts VI and VII of "Excavation of Petroleum Contaminated Soil" (Fact Sheet #3.6). If no further action is recommended, the MPCA staff will review this report following notification of soil treatment. Based on the results obtained from field screening and analytical analysis, Earth Burners Inc. recommends no additional work be performed in conjunction with this leak site. The majority of soil contaminated above MPCA soil vapor and analytical action levels were removed from the basin. Any residual contamination should not pose a significant risk to the environment. This leak site should be considered for closure.**

## VIII. SOIL TREATMENT INFORMATION

- A. **Soil treatment method used (thermal, land application, composting, other). If you choose "other" specify treatment method: Thermal**
- B. **Location of treatment site/facility: Hallett Dock #7**
- C. **Date MPCA approved soil treatment: August 19, 1997**
- D. **Identify the location of any stockpiled contaminated soil: Hallett Dock #7**

## IX. CONSULTANT (OR OTHER) PREPARING THIS REPORT

By signing this document, I/we acknowledge that we are submitting this document on the behalf of and as agents of the responsible person or volunteer for this leak site. I/we acknowledge that if information in this document is inaccurate or incomplete, it will delay the completion of remediation and may harm the environment and may result in reduction of reimbursement awards. In addition, I/we acknowledge on behalf of the responsible person or volunteer for this leak site that if this document is determined to contain a false material statement, representation or certification, or if it omits material information, the responsible person or volunteer may be found in violation of Minn Stat §115.075 (1994) or Minn. Rules 7000.0300 (Duty of Candor), and that the responsible person or volunteer may be liable for civil penalties.

**Company Name:**

**Earth Burners, Inc.**

**Street/Box:**

**PO Box 16083**

**City, Zip:**

**Duluth, MN 55816-0083**

**Telephone:**

**(218) 628-0454**

**Fax:**

**(218) 628-0455**

**Date:**

**August 20, 1997**

**Prepared by:**

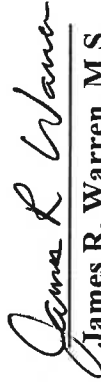
  
**James R. Warren, M.S.**  
**Hydrologist**

If additional investigation is not required at the site, please mail this form and all necessary attachments to:

**Minnesota Pollution Control Agency  
Tanks and Emergency Response Section  
520 Lafayette Road North  
St. Paul, Minnesota 55155**

If additional investigation is required at the site, include this form as an appendix to the "Remedial Investigation Report Form". Excavation reports indicating a limited site investigation (LSI) is necessary will not be reviewed by MPCA staff until the LSI has been completed.



## **Application to Treat Contaminated Soil**



Tanks and Emergency Response Section  
Minnesota Pollution Control Agency

APPLICATION TO THERMALLY TREAT PETROLEUM  
CONTAMINATED SOIL

Fact Sheet #3.16

April 1996

I. Minnesota Pollution Control Agency (MPCA) Site ID Number: LEAK# 10137

II. MPCA Project Manager: Steve Leppala

III. Source of Soil:

Facility Name: Coons Aggregate Supply  
Street Address: 6812 Hwy 194  
City, State, Zip: Saginaw, MN 55779

Contact Name: Chris Larsson  
Telephone: 218 739-7544

IV. Date of soil excavation: July 24, 1997

V. Contamination Details:

Weight of Soil (tons): (One cubic yard of soil is approximately equivalent to 1.4 tons.)  
280 tr.

Type Petroleum Contamination: (circle one)

Gasoline, diesel fuel, No. 1 fuel oil, No. 2 fuel oil, kerosene, aviation gas, used oil,  
(hydraulic fluid, cutting oil, motor oil, quench oil).

Contaminant Concentration (parts per million)\*  
 ATTACH LABORATORY ANALYTICAL SHEETS  
 P1 P2

Benzene	< 0.05	0.153		
Toluene	< 0.05	0.085		
Ethyl Benzene	< 0.05	0.205		
Xylene	< 0.15	0.487		
Total Lead	NA	NA		
Total Hydrocarbons (GRODRO)	555.0	519.0		
Soil Type (sand, silt, clay, etc.)	Gravel / clay	Gravel / Clay		

\*Note: See Tanks and Emergency Response Section fact sheet #3.22. "Soil Sample Collection and Analysis Procedures" for additional necessary analysis.

VI. Thermal Treatment Unit

Name: Earth Burners, Inc  
 Address: Hallett Dock #7  
 (if portable, where will plant be located)

City, State, Zip: Deluth, MN 55307

Plant Number or Model: AM PS-15  
 (if portable, separation distance in feet from nearest residence(s): 2000.)

Contact Name: Tim Warren Title: Office Manager  
 Telephone: (ph) 628-0454 Site Telephone: (ph) 628-0248  
 Air Quality Permit Number: 13700001-004

8/19/97 " Janna R Warren "  
 Date Signature of Authorized Thermal Treatment  
 Unit Representative Accepting Soil

VII. Date treatment will be completed: 9/30/97

## VIII. Individual Submitting Request

Company Name: Coors Aggregates Supply  
Address: 4607 Cassia Rd  
City, State, Zip: Saginaw MN 55779

Contact Name: Chris Larson  
Telephone: (218) 739-7544

Signature: Christopher Larson

Date: August 19, 1997

This completed application, if confirmed by the monthly thermal treatment facility log, constitutes an acceptable soil corrective action plan. The individual submitting the request and the authorized thermal treatment unit representative certify that soil contaminant concentrations fall within the limits established in "Thermal Treatment of Petroleum Contaminated Soil" (fact sheet #33), and that the thermal treatment facility is operating in compliance with its Air Quality emission permit.

Mail to:  
(Project Manager)  
Minnesota Pollution Control Agency  
Hazardous Waste Division  
Tanks and Emergency Response Section  
520 Lafayette Road North  
St. Paul, Minnesota 55155-4194  
Fax No.: 612/297-8676

Upon request, this document can be made available in other formats, including Braille, large print and audio-tape. TTY users call 612/282-5332 or Greater Minnesota 1-800-657-3864.

Printed on recycled paper containing at least 10 percent fibers from paper recycled by consumers.

330 SO. CLEVELAND ST.  
P.O. BOX 349  
CAMBRIDGE, MN 55008

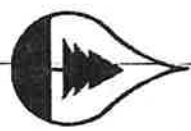

**MIDWEST ANALYTICAL SERVICES**  
MINNESOTA CERTIFIED LABORATORY  
NUMBER 027-059-156

LAB  
METRO  
FAX

(612) 689-2175  
(612) 444-9270  
(612) 689-3660

August 13, 1997

Janes Warren  
Earth Burners, Inc.  
P.O. Box 16083  
500 Leisure Street  
Duluth, MN 55816-0083

Project ID: Coons Aggregate  
Chain of Custody: 21930  
Date Sampled: 07-24-97  
Date Received: 07-29-97  
Date Analyzed: 08-06-97  
Matrix: Soil  
Sample Identification:  
Lab ID: 18728 97057 P2  
18729 97057 P1

Samples were analyzed for DRO by the Wisconsin Modified DRO procedure. The results are reported below.

Parameter:	Benzene	Toluene	Ethyl Benzene	Xylenes	Total Hydrocarbons as DRO	Percent Moisture
Units: (mg/kg)	(mg/kg)	(mg/kg)	(mg/kg)	(mg/kg)	(mg/kg)	(%)
MDL: 18728	0.050	0.050	0.050	0.150	10.0	
P2	0.253	0.085	0.205	0.487	519	7.4
18729 P1	BDL	BDL	BDL	BDL	555	13.0

BDL = Below Detection Limit, MDL = Method Detection Limit

Sincerely,

Lon Jones  
Organic/Bio Group Leader

# EARTH BURNERS, INC.

SAGINAW, MINN

NA645-W9222.5/7.5

1953

PHOTOREVISED 1969

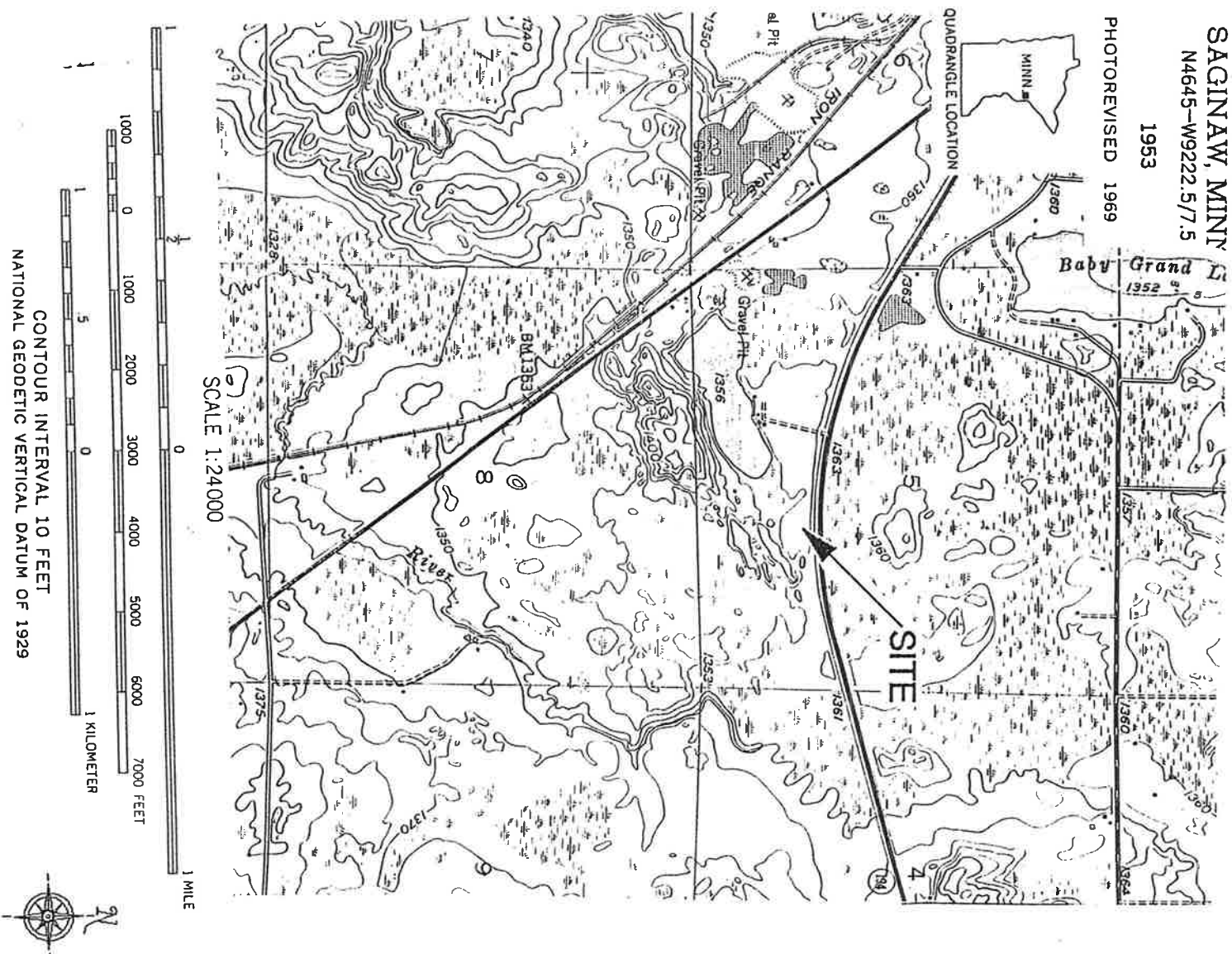

# EARTH BURNERS, INC.

HIGHWAY 194

~75'



TRAILER OFFICE  
6812 HWY 194

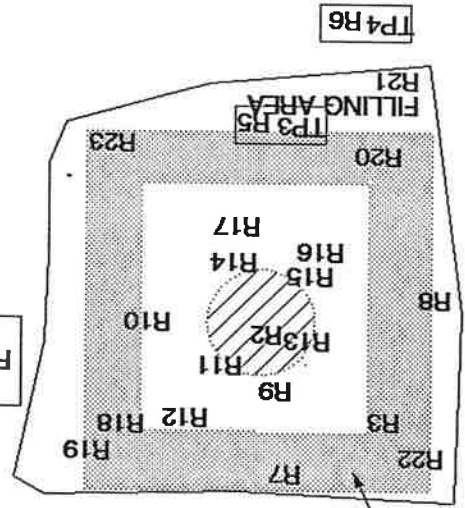

- LEGEND
- S1-25 SOIL VAPOR SAMPLE
  - B1-2 ANALYTICAL SOIL SAMPLE
  - FORMER BERM WITH FORMER AST



1 INCH = 20 FEET

0 10 20

## SITE LAYOUT AND SOIL SAMPLE LOCATIONS

FIGURE 2

## Laboratory Analytical Results



330 SO. CLEVELAND ST.  
P.O. BOX 349  
CAMBRIDGE, MN 55008

**MIDWEST ANALYTICAL SERVICES**

MINNESOTA CERTIFIED LABORATORY  
NUMBER 027-059-156

LAB (612) 689-2175  
METRO (612) 444-9270  
FAX (612) 689-3660



August 13, 1997

James Warren  
Earth Burners, Inc.  
P.O. Box 16083  
500 Leisure Street  
Duluth, MN 55816-0083

Project ID: Coons Aggregate  
Chain of Custody: 21931  
Date Sampled: 07-24-97  
Date Received: 07-29-97  
Date Analyzed: 08-06-97  
Matrix: Soil  
Sample Identification:  
Lab ID: 18730 97057 B1-7'  
18731 97057 B2-4'

Samples were analyzed for DRO by the Wisconsin Modified DRO procedure. The results are reported below.

Parameter:	Benzene	Toluene	Ethyl Benzene	Xylenes	Total Hydrocarbons as DRO	Percent Moisture
Units:	(mg/kg)	(mg/kg)	(mg/kg)	(mg/kg)	(mg/kg)	(%)
MDL:	0.050	0.050	0.050	0.150	10.0	
18730	BDL	BDL	BDL	BDL	0.2	10.7
B1-7'						
18731	BDL	BDL	BDL	BDL	0.2	11.8
B2-4'						

BDL = Below Detection Limit, MDL = Method Detection Limit

Sincerely,

Lon Jones  
Organic/Bio Group Leader

## Status of Aboveground Storage Tanks

# APPROVEGROUND TANK FACILITY NOTIFICATION FORM

**CHECK ONE**

**FIRST TIME FACILITY REGISTRATION ?**

**UPDATED INFORMATION** (Check action from table to the right)

- Add tank
- Remove tank
- Change tank info
- Change owner
- Change add, phone
- Other

### FACILITY INFORMATION

TANK LOCATION (SITE ADDRESS)	TANK OWNER/OPERATOR (MAILING ADDRESS)
NAME: Coons Aggregate Supply	NAME: Coons Aggregate Supply
STREET: 6812 Hwy 194	STREET: 4607 Cassia Road
CITY: Saginaw	CITY: Saginaw
COUNTY: St. Louis	STATE: Minnesota
PHONE (218) 729-7544	ZIP: 55779
CONTACT PERSON: Chris Larson	CONTACT PERSON: Chris Larson

**PLEASE CHECK THE TERM THAT BEST DESCRIBES YOUR FACILITY OPERATION**

- |  |   |
|--|---|
| <input type="checkbox"/> SERVICE STATION/BULK FACILITY (34)<br><input type="checkbox"/> CHEMICAL STORAGE (35)<br><input type="checkbox"/> INDUSTRY/MANUFACTURING (19)<br><input type="checkbox"/> AUTO CARE/AUTO PARTS (44)<br><input type="checkbox"/> VEHICLE/TRAILER DEALER/CAR RENTAL (2)<br><input type="checkbox"/> TRANSPORTATION (37)<br><input type="checkbox"/> RAILROAD (47)<br><input type="checkbox"/> UTILITY (39)<br><input checked="" type="checkbox"/> CONSTRUCTION (9) Former Borrow Pit<br><input type="checkbox"/> RESIDENTIAL (8)<br><input type="checkbox"/> FAMILY FARM (3)<br><input type="checkbox"/> GOVERNMENT/CITY (12)<br><input type="checkbox"/> GOVERNMENT/COUNTY (13)<br><input type="checkbox"/> GOVERNMENT/STATE (15)<br><input type="checkbox"/> GOVERNMENT/FEDERAL (14)<br><input type="checkbox"/> GOVERNMENT/INDIAN (16)<br><input type="checkbox"/> OFFICE/MALL/PARKING LOT (40) | <input type="checkbox"/> FOOD PROCESSING (49)<br><input type="checkbox"/> AGRICULTURAL (1)<br><input type="checkbox"/> SCHOOL/UNIVERSITY/NOTECH (10)<br><input type="checkbox"/> ENTERTAINMENT/RADIO/TV/NEWSPAPER (11)<br><input type="checkbox"/> HOSPITAL/MEDICAL CENTER/<br><input type="checkbox"/> NURSING HOME/CHILDREN (17)<br><input type="checkbox"/> LANDFILL/RUBBISH (20)<br><input type="checkbox"/> WASTEWATER/WATER TREATMENT (21)<br><input type="checkbox"/> HOTEL/MOTEL/RESTAURANT (18)<br><input type="checkbox"/> MARINA/RESORT/CAMPGROUND/BAIT (23)<br><input type="checkbox"/> WASTE OIL STORAGE/RECYCLING (33)<br><input type="checkbox"/> RETAIL STORE (31)<br><input type="checkbox"/> BANK/FINANCE/BROKER/INSURANCE (4)<br><input type="checkbox"/> CHURCH/CEMETARY/SOCIAL SERVICES (43)<br><input type="checkbox"/> PIPELINE TERMINAL (48)<br><input type="checkbox"/> REFINERY (50)<br><input type="checkbox"/> OTHER (describe) _____ |
|--|---|

LOADING RACK (FOR TRANSFERS)? Y \_\_\_ N X PAVED? Y \_\_\_ N X CURBED? Y \_\_\_ N X

SPEL RESPONSE PLAN ON SITE? Y \_\_\_ N X The Ast was not in operation since about 1988

**IF MORE THAN 10 TANKS ARE AT THIS SITE, PHOTOCOPY THE BACK SIDE OF THIS FORM PRIOR TO COMPLETION AND INCLUDE AS ADDITIONAL TANK INFORMATION**

**IF THERE ARE ANY CHANGES TO THE REPORTED INFORMATION, THE MPCA MUST BE NOTIFIED OF THE CHANGE IN STATUS WITHIN 30 DAYS OF THE CHANGE. YOU MAY USE THIS FORM BY INDICATING IN THE UPPER LEFT CORNER THAT IT IS UPDATED INFORMATION**

**MPCA Use**

Owner ID #: \_\_\_\_\_

Site ID #: \_\_\_\_\_



**MINNESOTA POLLUTION  
CONTROL AGENCY**

*Return completed form to:*  
 Joan d'Amour  
 Tanks and Spills Section  
 Hazardous Waste Division  
 Minnesota Pollution Control Agency  
 520 Lafayette Road  
 St. Paul, Minnesota 55155

# COMPLETE ALL ITEMS FOR EACH TANK ON SITE

(see explanations below)

TANK	STORED PRODUCT	CAPACITY OF TANK	THRUPUT PER MONTH	STATUS	AGE OF TANK	DATE TANK INSTALL	TANK MATERIAL	DIKE BOTTOM	DIKE SIDE	TANK BASE (indicate if tank is indoors)	PIPE MATERIAL	PIPE LOCATION
1	Diesel Fuel	12,000	Unknown	Removed	1972	1972	Metal	Clay	clay/ground	Concrete	None	NA
2												
3												
4												
5												
6												
7												
8												
9												
10												

TANK # USE NUMBER GIVEN, UNLESS YOU HAVE DIFFERENT NUMBERING SYSTEM IF SO, LIST YOUR NUMBER TO THE LEFT OF THE NUMBER GIVEN

STORED PRODUCT LIST SUBSTANCES STORED (E.G. FUEL OIL 2, GASOLINE)

CAPACITY MAXIMUM TANK CAPACITY IN GALLONS

THROUGHPUT APPROXIMATE NUMBER OF GALLONS OF PRODUCT PASSING THROUGH EACH TANK PER MONTH

STATUS ACT (FOR ACTIVE) IN (FOR TEMPORARILY INACTIVE) CLOSED (FOR PERMANENTLY OUT OF SERVICE) REMOVED

AGE OF TANK USE APPROXIMATE DATE IF UNKNOWN E.G.: 1-1-68 OR 1968 (DO NOT PUT DATE IN YEARS - E.G.: 40 YEARS OLD)

DATE TANK INSTALLED DATE THE TANK WAS PUT INTO SERVICE AT THIS SITE OFTEN WILL BE THE SAME DATE AS AGE OF TANK

TANK MATERIALS (M) METAL (FRP) FIBERGLASS REINFORCED PLASTIC (C) CONCRETE (DW) DOUBLE WALLED (O) OTHER

DIKE BOTTOM/SIDE BLOCK CONCRETE CLAY SYNTHETIC LINER DOUBLE WALLED EARTH NONE OTHER

TANK BASE WHAT THE TANK IS SITTING ON EX: ON GROUND ON SUPPORTS ON CEMENT ON LINER DOUBLE BOTTON INDOORS OTHER

PIPE MATERIAL STEEL/IRON COPPER FRP GALVANIZED NONE OTHER

PIPE LOCATION ABOVEGROUND UNDERGROUND NA (NOT APPLICABLE)

Please keep a copy of this form for your records. When changes are made to the current information, please contact the MPCA at (612) 297-8618 for additional notification forms.

I certify under penalty of law that I have personally examined and am familiar with the information submitted on this and all attached documents.  
I believe that the submitted information is true, accurate and complete.

Print name and official title of owner or owner's representative

CHRISTOPHER LARSON PRESIDENT

Owner/representative signature

Christopher Larson President

Date

August 13, 1997