

29-JUL-1997 10:45:37  
tss074

LEAK REMARKS

Leak ID: 1338  
Site Name: MNDOT TRUCK STATION DIST #5  
Site City: JORDAN

7/31/91- inherit site MEK  
11/05/91- Information on site situation received from MNDOT to JRL  
11/08/91- review of project/ status;further work/comments JRL  
11/13/91- comments letter on RI to typing (Brian Kamnikar is contact)  
11/18/91- comments letter mailed  
05/08/92- JRL- conv. w/ Brian Kamnikar; memo in file; progress report  
forthcoming in June of 1992;  
01/03/93- MEK- wake up call mailed;  
02/17/94- MEK- rec'd Closure Request report;  
03/03/95 KWD-Mailed closure letter  
4/21/97 LC CSR Adequate sent to Commerce.  
07/29/97 sent to archives kl

MINNESOTA POLLUTION CONTROL AGENCY  
TANKS AND SPILLS SECTIC  
ABOVE/BELOW GROUND RELEASE REPORT

4/89

Report taken by: WALT HAAS Date/time occurred: —  
Date/time of report: 7-19-89 AM Date/time discovered: —

CALLER\*  
name: CONNOR KRAENESS  
phone: 218-828-2460 MESSAGE  
296-8085

INSTALLATION\*  
name: MIN DOT TRUCK STATION  
street: HIWAY 169 DIST. 5  
city, zip: JORDAN, 55352  
SCOTT

relationship to site:  
EMPLOYEE of DOT.

MATERIAL RELEASED/AMOUNT\*  
DIESEL / UNK

LEAK # 2600001338  
USTIS # MINIST0004468  
STATE OR FEDERAL  
EMERGENCY DECLARED? YES/NO  
RP/FF

SITUATION (HOW/WHY)  
UST

VAPOR/WATER/OTHER  
SITE INVESTIGATION - NO BUT NEEDED  
ACTIVE: RP  
CORRECTIVE ACTION - NO BUT NEEDED  
ACTIVE: FF  
ENFORCEMENT - NO/YES (documented)

- BAKWES PILING WORK -

ACTIVITIES TO DATE (circle)\*  
tank removed, size \_\_\_\_\_  
age \_\_\_\_\_, contents \_\_\_\_\_  
above ground/below ground \_\_\_\_\_  
soil borings \_\_\_\_\_  
digging, why? \_\_\_\_\_  
contamination detected \_\_\_\_\_  
odor, instrument, analysis \_\_\_\_\_  
soil excavated \_\_\_\_\_  
stockpiled properly \_\_\_\_\_  
disposal arranged \_\_\_\_\_  
samples collected \_\_\_\_\_  
other (specify) \_\_\_\_\_

SITE OWNER/RESPONSIBLE PARTY\*  
name: POT - PIST S

street: MDOT ATT: maintenance Sup  
2055 N Lila e Drive 6660  
city, zip: Cal is dealing with land app  
Cal Lucas = 593-8514  
contact person: PAN ERICKSON  
phone: 593-8400

SITE OPERATOR\*  
name: \_\_\_\_\_  
street: \_\_\_\_\_

INSTRUCTIONS GIVEN (circle)\*  
hire consultant \_\_\_\_\_  
submit report \_\_\_\_\_  
staff will call \_\_\_\_\_  
contact staff \_\_\_\_\_

city, zip: \_\_\_\_\_  
contact person: \_\_\_\_\_  
phone: \_\_\_\_\_

AREAS AFFECTED\*  
surface water \_\_\_\_\_  
groundwater \_\_\_\_\_  
sanitary sewer \_\_\_\_\_  
storm sewer \_\_\_\_\_  
soil \_\_\_\_\_  
wells \_\_\_\_\_  
other \_\_\_\_\_

CONTACTS  
Local Fire/Police \_\_\_\_\_  
Local Officials \_\_\_\_\_  
Emergency Services \_\_\_\_\_  
MPCA Region \_\_\_\_\_  
MDA \_\_\_\_\_  
MDOT \_\_\_\_\_  
Other \_\_\_\_\_  
ADDITIONAL INFO - continue on back

~~RELEASE REPORT - ADDITIONAL INFORMATION~~

Blank lined area for reporting information.

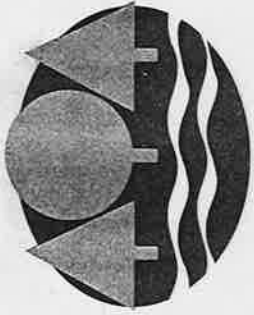

# Minnesota Pollution Control Agency

March 3, 1995

Mr. Brian Kamnikar  
Minnesota Department of Transportation  
3485 Hadley Avenue North  
Oakdale, Minnesota 55128

RE: Petroleum Tank Release Site File Closure  
Site: Minnesota Department of Transportation Truck Station, District 5,  
Jordan  
Site ID#: LEAK00001338

Dear Mr. Kamnikar:

We are pleased to let you know that the Minnesota Pollution Control Agency (MPCA) Tanks and Spills Section (T&S) staff has determined that your investigation and/or cleanup has adequately addressed the petroleum tank release at the site listed above. Based on the information provided, the T&S staff has closed the release site file.

Closure of the file means that the T&S staff does not require any additional investigation and/or clean-up work at this time or in the foreseeable future. Please be aware that file closure does not necessarily mean that all petroleum contamination has been removed from this site. However, the T&S staff has concluded that any remaining contamination, if present, does not appear to pose a threat to public health or the environment.

The MPCA reserves the right to reopen this file and to require additional investigation and/or clean-up work if new information or changing regulatory requirements make additional work necessary. If you or other parties discover additional contamination (either petroleum or non-petroleum) that was not previously reported to the MPCA, Minnesota law requires that the MPCA be immediately notified.

You should understand that this letter does not release any party from liability for the petroleum contamination under Minn. Stat. ch. 115C (1992) or any other applicable state or federal law. In addition, this letter does not release any party from liability for non-petroleum contamination, if present, under Minn. Stat. ch. 115B (1992), the Minnesota Superfund Law.

The monitoring wells for this site should be abandoned in accordance with the Minnesota Department of Health (MDH) Well Code, Chapter 4725. If you choose to keep the monitoring wells, the MDH will continue to assess a maintenance fee for each well.

520 Lafayette Rd. N.; St. Paul, MN 55155-4194; (612) 296-6300 (voice); (612) 282-5332 (TTY)  
Regional Offices: Duluth • Brainerd • Detroit Lakes • Marshall • Rochester

Equal Opportunity Employer • Printed on recycled paper containing at least 10% fibers from paper recycled by consumers.

Mr. Brian Kammikar

Page 2

March 3, 1995

Because you performed the requested work, the state may reimburse you for a major portion of your costs. The Petroleum Tank Release Cleanup Act establishes a fund which may provide partial reimbursement for petroleum tank release clean-up costs. This fund is administered by the Department of Commerce Petro Board. Specific eligibility rules are available from the Petro Board at 612/297-1119 or 612/297-4203.

If future development of this property or the surrounding area is planned, it should be assumed that petroleum contamination may still be present. If petroleum contamination is encountered during future development work, the MPCA staff should be notified immediately.

For specific information regarding petroleum contamination that may remain at this leak site, please call the T&S File Request Program at 612/297-8499. The "Leak/Spill and Underground Storage Tank File Request Form" (T&S Fact Sheet #36) must be completed prior to arranging a time for file review.

Thank you for your response to this petroleum tank release and for your cooperation with the MPCA to protect public health and the environment. If you have any questions regarding this letter, please call me at 612/297-8611. For questions involving ground water, please contact staff hydrogeologist David Scheer at 612/297-8601.

Sincerely,



Mark Koplitz  
Project Manager  
Cleanup Unit I  
Tanks and Spills Section

MK:vb

cc: Kay Kuhlmann, Administrator, Jordan  
William Busch, Fire Chief, Jordan  
Al Frechette, Scott County Solid Waste Officer  
Ronald Weaver, Braun-Intertec  
Petrofund Staff, Minnesota Department of Commerce

LEAKSITE#: 1338

Minnesota Pollution Control Agency  
Hazardous Waste Division  
Tanks and Spills Section

DATE: 2/27/95

BY: David A. Scheer

\*\*\*\*\* Hydrologic Site Review \*\*\*\*\*

LEAKSITE NAME AND LOCATION: MN DOT Truck Station

LEAK OR SPILL REPORTED DATE: July 19, 1989

CONTRACTOR: Braun Intertech

REPORT NAME: Progress Report

REPORT DATE: February 1995

PROJECT MANAGER: M. Edwin Koplitz

HYDROLOGIST: David A. Scheer

VAX FILE: [Scheer DJ1338HYRE.TXT

\*\*\*\*\*

The Minnesota Pollution Control Agency (MPCA) staff have reviewed the Progress Report received 27 February 1995. Information provided in the report indicates that petroleum contaminant concentrations in the apparent down gradient wells MW-2 and MW-4 have not exceeded the Minnesota Health Risk Limits during any of the previous sample events. The wells have been sampled and analyzed on a periodic basis since 20 August 1990. The low petroleum contaminant concentrations in the down gradient wells indicate that the plume is not migrating and therefore should not be considered a risk to potential receptors.

Based on the information provided and based on current land use, the MPCA staff concur with the recommendations of Braun Intertech. The site should be closed. No additional investigation nor corrective action will be required at this time.

LEAKSITE NO. 1338

Date: 2/17/95

Site Name: MNDOT Truck Stop #5 (Jordan, MN)

Hydro: Kriste Davenport

Leak Report Date: 7/19/89

Report Titles: Progress Report 2/17/94

Consultants: Braun Intertec

Tank Info:	Capacity	Contents	Type	Date Removed	Condition	Age
331	1200 gal	gas	steel	10/20/89	good	1956
332	3000 gal	diesel	steel	10/20/89	good	1956

Soil Excavation Info: (volume, treatment, remaining contamination)  
100 yd<sup>3</sup> excavated. Thermally treated

Soil Borings: (Stratigraphy, contam. levels)

9 borings ⇒ sandy lean clay interbedded with poorly graded sand w/silt and organic silt with sand,

Most borings had PID < 16 ppm. ST-2 had PID of 120-150 ppm (7.5-11.5 ft).

ST-5 had low levels of contam at 10-11.5 ft (PID=30 ppm)

ST-3 → PID = 70 at 10-11.5

Ground Water Status: (no. of wells, max contam levels, definition of extent)

4 MW. - level of extent defined vertically, & horizontally.  
Appears to have low levels of contam.

	6/1/93	Benzene	9/8/93	gas <sup>total</sup> TPH	6/1/93	9/8/93
MW-1	ND		ND	ND		ND
MW-2	1.4		8	GRD-.57, DRD=1.1		GRD=.2, DRD=5.3
MW-3	ND		ND	ND		ND
MW-4	ND		ND	ND		ND
MW-5						

ppb

ppm

Depth to GW: 7.5-9.5 ft

GW flow direction: N to NW

GW velocity:  $2.25 \times 10^{-6}$  cm/sec Well screen elevations: 5ft deep.  
to  $1.4 \times 10^{-4}$  cm/sec

RISK -

Receptor Survey:

- MGS shows 13 wells within 1 mile. Only 1 downgradient (4600 ft) but none are within same consolidated till. (all at least 120 ft deep).
- City of Jordan personnel identified 30 wells. None are downgradient. 2 are close, but can only be used for outdoor activities. (hooked up to city water)

Vapor Survey:

- no onsite buildings w/ sumps or basements
- low conc of soil contain encountered
- fine grained soil prevents vapor migration
- sewer, water, gas, & phone near LST basin

Comments and Cleanup Goal:

Dates of Major Events:                      FP Recovery                      GW Recovery                      Long Term Monitoring  
Soil Treatment

6/27/90

CAD Implemented:

Justification for closure:

Appears to have very little soil & water contain.

Recommend: closure. KMD 2/17/95





# Minnesota Pollution Control Agency

January 3, 1994

Mr. Brian Kamnikar  
Department of Transportation  
Environmental Services Section  
375 John Ireland Boulevard, Room 124  
St. Paul, Minnesota 55155

Dear Mr. Kamnikar:

RE: Petroleum Storage Tank Release Investigation and Corrective Action  
Site: Minnesota Department of Transportation, Truck Stop, Jordan  
Site ID# LEAK00001338

On July 19, 1989, the Minnesota Pollution Control Agency (MPCA) staff was notified that a release of petroleum occurred from storage tank facilities that you own and/or operate at the site referenced above.

A recent review of our files shows that we have not received a progress report as required. MPCA staff request that the report be submitted within 90 days of receipt of this letter. Please include current ground water data in a comprehensive table as discussed in a telephone call on May 8, 1992. Failure to comply with this requirement may result in reduced reimbursement from the Petrofund and/or enforcement action taken against you by the MPCA.

If you have any questions concerning this letter or need additional information, please call me at 612/297-8611. Please reference the above LEAK number in all correspondence.

Sincerely,

Mark Koplitz  
Project Manager  
Cleanup Unit 1  
Tanks and Spills Section

MK:mk

cc: Ronald C. Weaver, Braun Intertec Environmental, Inc., Mendota Heights  
Coralee Fox, City Administrator, Jordan  
Al Frechette, Scott County, Shakopee

Route to:

- (1) \_\_\_\_\_  
 (2) \_\_\_\_\_  
 (3) \_\_\_\_\_  
 (4) \_\_\_\_\_

OFFICE MEMORANDUMFile: 1338

Location: Jordan  
 (City, Village, Township, Section, Range, County, etc.)

Subject: MNDOT TRUCK STATION

By Whom: Jim Condy Date: May 8, 1992

Investigation \_\_\_\_\_ Conference Field \_\_\_\_\_ Hearing \_\_\_\_\_ Meeting \_\_\_\_\_ Phone X

Office \_\_\_\_\_

- Items to be Covered: (1) Those present and/or those interviewed  
 (2) Situation  
 (3) Further action, follow-up, recommendations

1) Brian Kamnikar, MNDOT 297-2703

2) Dismissed the 2-18-92 report with him. Concentrations in MW-2 look pretty ~~low~~ low - probably indicates no free product present (if there had been a substantial volume, concentrations would likely have been higher), therefore the requested 4th well (MPCA correspondence of 11-18-91) is not necessary at this time.

Brian K. will continue quarterly monitoring, and will submit a progress rpt. after 6-92 sampling event, with a comprehensive table of raw data. We will reconsider sampling requirements at that time.

3) No further action.

*Mark - do you have this file?  
I can't find it*

PRIORITY: 2  
UNIT No.: 7

HYDROLOGIST REVIEW SUBMITTAL

SITE NAME: Avdot Truck Station CITY: Jordan  
LEAK No.: 1388 NAME OF REPORT: PROGRESS REPORT  
PROJECT MANAGER: MEK DATE MPCA RECEIVED: 2/19/92  
HYDROGEOLOGIST: JRL DATE HYDRO RECEIVED: \_\_\_\_\_  
DATE HYDRO REVIEWED: \_\_\_\_\_

1388

PRIORITY SYSTEM	
I IMMEDIATE PRIORITY	II GENERAL PRIORITY
<input type="checkbox"/> ACTUAL/POTENTIAL DRINKING WATER IMPACT	<input type="checkbox"/> RI/CAD FREE PRODUCT recovery begun
<input type="checkbox"/> EMERGENCY, Vapor impact(s)	<input type="checkbox"/> RI/CAD - CA required
<input type="checkbox"/> FREE PRODUCT	<input type="checkbox"/> RI/CAD - monitor/no action
<input type="checkbox"/> OTHER, explain	<input type="checkbox"/> CLOSURE REPORT
	<input checked="" type="checkbox"/> PROGRESS/MONITORING REPORT
	<input type="checkbox"/> STATE CONTRACTORS
	<input checked="" type="checkbox"/> OTHER, explain

COMMENTS:

*Quick Review of GW Progress Report.  
ProposAC for 2 more 1/4's, if so  
+ decrease: then rec. closure*



## Minnesota Pollution Control Agency

520 Lafayette Road, Saint Paul, Minnesota 55155-3898

Telephone (612) 296-6300

November 18, 1991

Mr. Brian Kamnikar  
Department of Transportation  
Environmental Services Section  
375 John Ireland Boulevard, Room 124  
St. Paul, Minnesota 55155

Dear Mr. Kamnikar:

RE: Petroleum Storage Tank Release Investigation and Corrective Action  
Site: Minnesota Department of Transportation, Truck Station, Jordan  
Site ID#: LEAK00001338

On November 5, 1991, the Minnesota Pollution Control Agency (MPCA) staff received a copy of the Ground Water Sampling Report for the Jordan Truck Station.

Based on the information provided in this report, additional Remedial Investigation (RI) work may be necessary at your site to define the magnitude and extent of petroleum contamination. Upon receipt of the upcoming round of sampling, similar data for monitoring well-2 will warrant need for an additional monitoring well in the vicinity of ST-2.

When your round of sampling is completed please submit the information. When the RI phase is completed, please submit a report following the MPCA "Petroleum Tank Release Investigation Report" (PTR). This report should summarize the RI and propose either a corrective action design to complete the cleanup or recommend and justify that no further action is necessary. A copy of the PTR document was included with the initial letter and packet of information you received from the MPCA regarding the petroleum release at your site.

Thank you for your cooperation. If you have any questions, or if you did not receive a copy of the PTR, please feel free to call me at 612/297-8611.

Sincerely,

A handwritten signature in dark ink, appearing to read "Mark G. Koplitz".

Mark Koplitz  
Pollution Control Specialist  
Tanks and Spills Section  
Hazardous Waste Division

MK:np

Route to:

FILE  
 (1) \_\_\_\_\_  
 (2) \_\_\_\_\_  
 (3) \_\_\_\_\_  
 (4) \_\_\_\_\_

OFFICE MEMORANDUMFile: 1338

Location: Jordan  
 (City, Village, Township, Section, Range, County, etc.)  
 Subject: MaDOT Truck Station District 5  
 By Whom: Jim Lindy Date: November 8, 1979

Investigation \_\_\_\_\_ Office \_\_\_\_\_  
 Conference Field \_\_\_\_\_ Hearing \_\_\_\_\_ Meeting \_\_\_\_\_ Phone \_\_\_\_\_

Items to be Covered: (1) Those present and/or those interviewed  
 (2) Situation  
 (3) Further action, follow-up, recommendations

1) Review of MaDOT correspondence dated 11-4-79.

2) Sample results from May and September 1979 indicate low C<sub>1</sub>'s for VOCs, but greatly increased TPH/FO C<sub>1</sub>'s compared to 8-90 results (11-12 ppm). No fp reported, but these levels are high enough that fp may be present close to MW-2. MaDOT doesn't want to install the add'l mw I requested. I suggest ~~one~~ after next sample round if similar C<sub>1</sub>'s in MW-2 are present. We are likely then missing a slug of near fp further east of MW-2, and an additional well should be drilled for possible fp recovery in the approximate position of ~~MW-2~~ ST-2.

DATE: November 4, 1991

TO: Jim Lundy  
Tanks and Spills Section, MPCA

FROM: Brian Kamnikar, Project Manager  
Environmental Compliance and Investigation

PHONE: 297-2703

SUBJECT: GROUNDWATER SAMPLING REPORT - MNDOT JORDAN TRUCK STATION  
MPCA LEAK #1388

Enclosed for your review are results of quarterly monitoring well sampling collected from the above noted site. Braun Intertec installed the wells and performed the first round of groundwater sampling on 20 August 1990. MNDOT personnel sampled the wells again on May 30 and September 5, 1991.

Total petroleum hydrocarbons as fuel oil has increased 7.5 times over the sampling period. Benzene, ethylbenzene, xylene, and toluene have not exceeded RAL's in any sampling event. MTBE has not been detected above method detection limits in any samples. I believe the increased fuel oil concentrations may be attributed to a fluctuating water table. The water table rose about two feet in the time interval between the initial and intermediate sampling events. This could result in groundwater leaching petroleum contamination from overlying soils that may have been impacted by the tank release.

According to the groundwater receptor survey conducted by Braun, it is unlikely that a possible receptor is in the area. Braun also has not indicated any potential risks associated with vapor migration.

Upon study of the groundwater flow direction and soil boring analyses, it is MNDOT's opinion that an additional well is not needed at this site. Soil boring ST-5 revealed 1600 ppm total hydrocarbons as fuel oil at a depth of 10 feet. This was the highest soil impact discovered during the remedial investigation. As shown on the enclosed map, boring ST-5 is located directly upgradient of monitoring well #2. Therefore, monitoring well #2 should intercept the flow of the more heavily impacted groundwater on site.

Based on the lab results and receptor surveys, MNDOT proposes to collect two more rounds of ground water samples, one to include lead determination.

If you need any further information or have any questions, please call me at 297-2703.

NOV 10 1991  
MPCA HAZARDOUS WASTE DIVISION  
BRIAN KAMNIKAR

arc of fuel  
oil -  
low

TABLE I

Groundwater Measurements (Ft)  
30 May 1991

<u>WELL</u>	<u>CASING ELEVATION</u>	<u>DEPTH TO GROUNDWATER</u>	<u>GROUNDWATER ELEVATION</u>
MW-1	757.78	8.25	749.53
MW-2	757.08	7.85	749.23
MW-3	757.25	7.87	749.38

TABLE II

Groundwater Measurements (Ft)  
5 Sept 1991

<u>WELL</u>	<u>CASING ELEVATION</u>	<u>DEPTH TO GROUNDWATER</u>	<u>GROUNDWATER ELEVATION</u>
MW-1	757.78	11.16	746.62
MW-2	757.08	10.72	746.36
MW-3	757.25	10.80	746.45

TABLE III

Groundwater Analyses  
30 May 1991

<u>Parameter</u>	<u>Units</u>	<u>RAL</u>	<u>MW-1</u>	<u>MW-2</u>	<u>MW-3</u>	<u>Field Blank</u>
Benzene	ug/L	10	0.6	4.8	<0.2	<0.2
Ethyl Benzene	ug/L	700	<0.2	15.0	<0.2	<0.2
Toluene	ug/L	1000	<0.2	2.8	<0.2	0.2
m+p-Xylene	ug/L	10000	<0.2	5.4	<0.2	<0.2
o-Xylene	ug/L	10000	<0.2	6.7	<0.2	<0.2
MTBE	ug/L	*	<2.0	<2.0	<2.0	<2.0
THC as Gasoline	ug/L	*	<30	700	<30	<30
THC as Fuel Oil	ug/L	*	<200	11000	<200	<200

\* No RAL exists for this parameter.

TABLE IV

Groundwater Analyses  
5 Sept 1991

<u>Parameter</u>	<u>Units</u>	<u>RAL</u>	<u>MW-1</u>	<u>MW-2</u>	<u>MW-3</u>	<u>Field Blank</u>
Benzene	ug/L	10	<0.2	1.4	<0.2	0.4
Ethyl Benzene	ug/L	700	<0.2	10.0	<0.2	<0.2
Toluene	ug/L	1000	<0.2	0.4	<0.2	<0.2
m+p-Xylene	ug/L	10000	<0.2	2.4	<0.2	<0.2
o-Xylene	ug/L	10000	<0.2	3.3	<0.2	<0.2
MTBE	ug/L	*	<2.0	<4.0	<2.0	<2.0
THC as Gasoline	ug/L	*	<30	800	<30	<30
THC as Fuel Oil	ug/L	*	<200	12000	<200	<200

\* No RAL exists for this parameter.



TABLE V

Summary of MW-2 sampling to date

<u>Parameter</u>	<u>Units</u>	<u>RAL</u>	<u>8-20-90</u>	<u>5-30-91</u>	<u>9-5-91</u>
Benzene	ug/L	10	2.5	4.8	1.4
Ethyl Benzene	ug/L	700	2.2	15	10
Toluene	ug/L	1000	1.8	2.8	0.4
Xylene <sup>^</sup>	ug/L	10000	1.9	6.7	3.3
MTBE	ug/L	*	<1.0	<2.0	<2.0
THC as Gasoline	ug/L	*	a	700	800
THC as Fuel Oil	ug/L	*	1600	11000	12000

<sup>^</sup> Represents Total, m+p, or o-Xylene; whichever is higher in concentration.

\* No RAL exists for this parameter.

a Total Hydrocarbons calculated as fuel oil.

GROUNDWATER FLOW DIRECTION  
30 MAY 1991

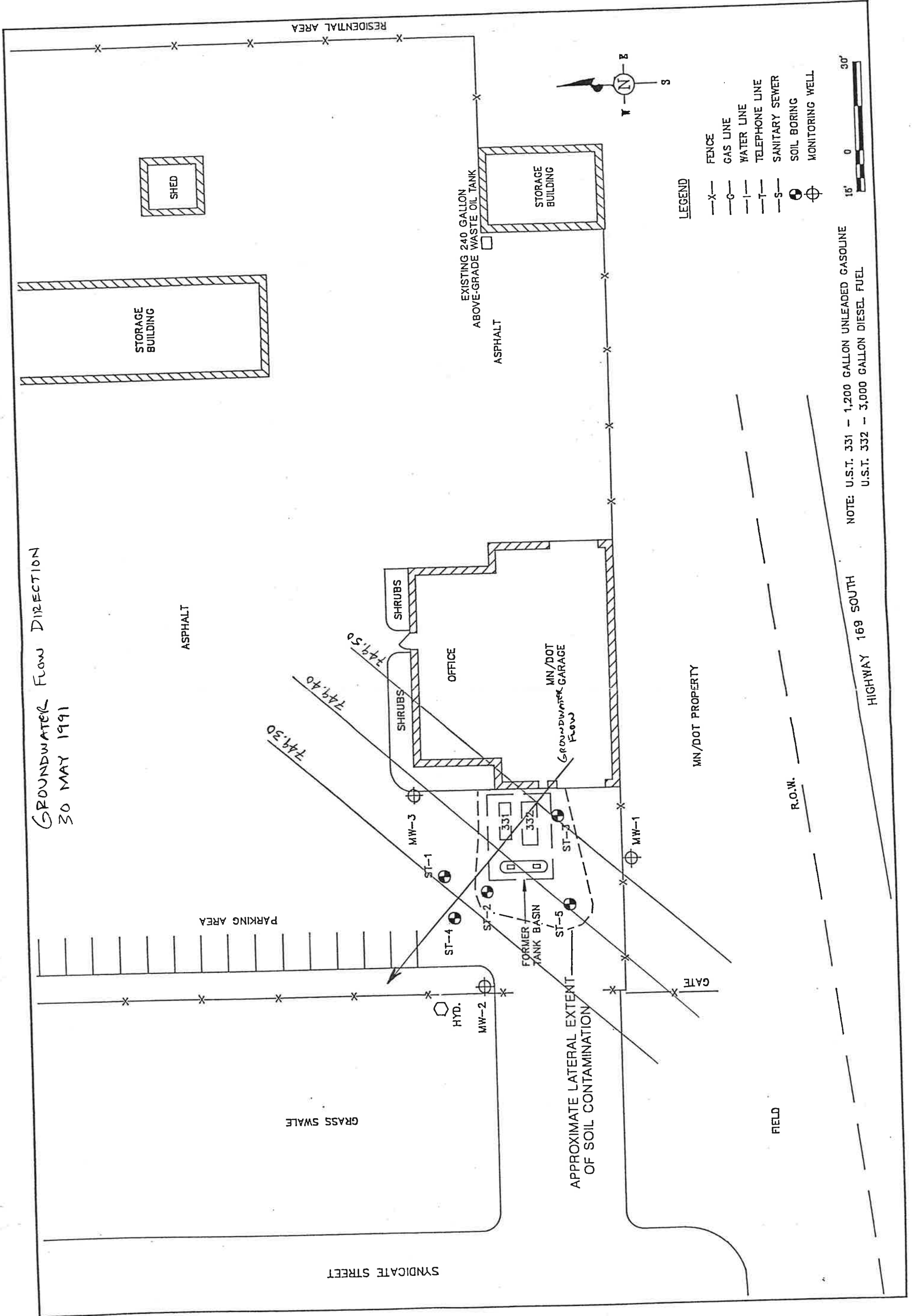

LEGEND

- X — FENCE
- C — GAS LINE
- I — WATER LINE
- T — TELEPHONE LINE
- S — SANITARY SEWER
- ⊕ — SOIL BORING
- ⊙ — MONITORING WELL



NOTE: U.S.T. 331 - 1,200 GALLON UNLEADED GASOLINE  
U.S.T. 332 - 3,000 GALLON DIESEL FUEL

HIGHWAY 169 SOUTH

R.O.W.

FIELD

APPROXIMATE LATERAL EXTENT  
OF SOIL CONTAMINATION

SYNDICATE STREET

GRASS SWALE

PARKING AREA

ASPHALT

STORAGE BUILDING

SHED

STORAGE BUILDING

EXISTING 240 GALLON  
ABOVE-GRADE WASTE OIL TANK

ASPHALT

OFFICE

MN/DOT GARAGE

MN/DOT PROPERTY

GROUNDWATER FLOW

SHRUBS

SHRUBS

SHRUBS

MW-3

ST-1

ST-4

ST-2

ST-3

ST-5

FORMER TANK BASIN

MW-2

HYD.

MW-1

CAFF

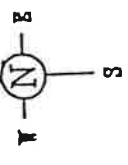

GROUNDWATER FLOW DIRECTION  
5 SEPTEMBER 1991

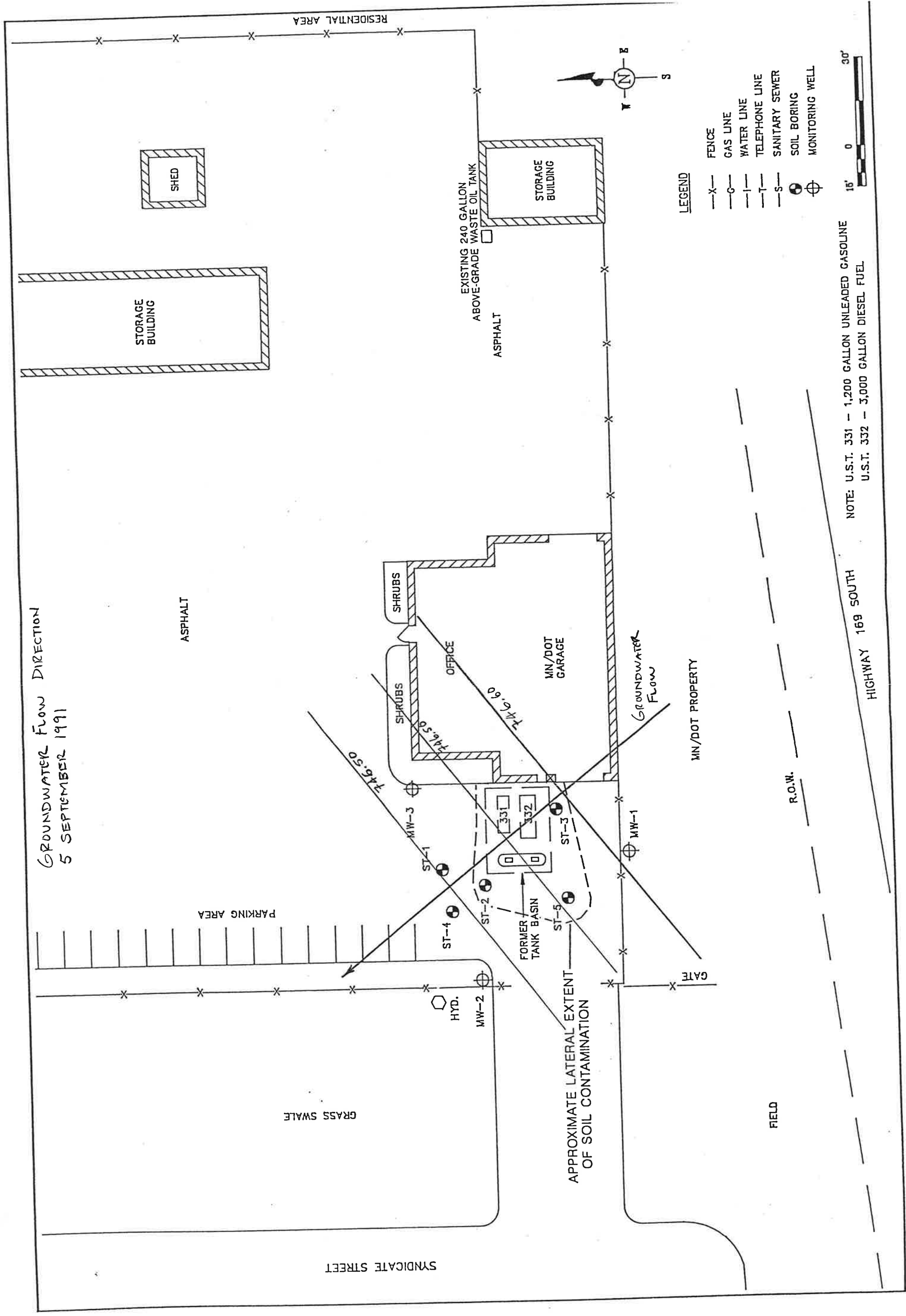

LEGEND

- X— FENCE
- O— GAS LINE
- |— WATER LINE
- T— TELEPHONE LINE
- S— SANITARY SEWER
- ⊕ SOIL BORING
- ⊕ MONITORING WELL

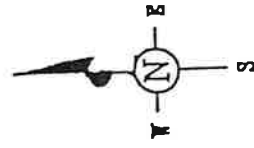

NOTE: U.S.T. 331 - 1,200 GALLON UNLEADED GASOLINE  
U.S.T. 332 - 3,000 GALLON DIESEL FUEL.

HIGHWAY 169 SOUTH

MN/DOT PROPERTY

R.O.W.

FIELD

SYNDICATE STREET

ASPHALT

STORAGE BUILDING

SHED

GRASS SWALE

PARKING AREA

HYD.

MW-2

ST-4

ST-2

ST-1

FORMER TANK BASIN

ST-5

MW-3

SHRUBS

OFFICE

MN/DOT GARAGE

GROUNDWATER FLOW

EXISTING 240 GALLON ABOVE-GRADE WASTE OIL TANK

ASPHALT

STORAGE BUILDING

RESIDENTIAL AREA