

Service esota

d GeoProbe Points

DRAWN BY: CAD
 CHECKED BY: DJW
 PROJECT NO.: 5815-001
 REVISION NO.: 2
 DATE: March 3, 2003
 REFERENCE: Survey Data

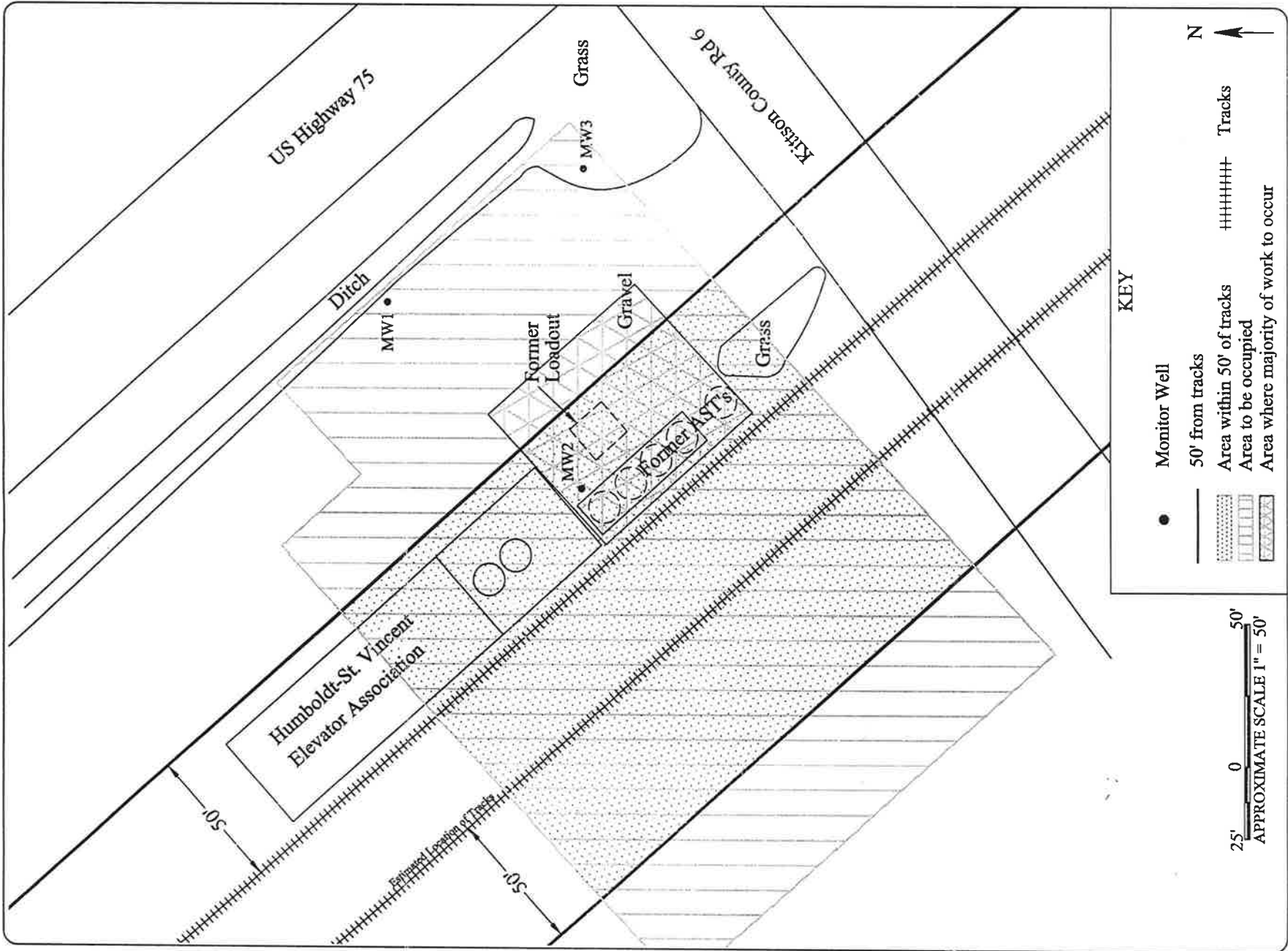



wccc, wccc 8/20/2002 9:20 AM 0405.mxd



PROJECT No. : 92-405-30 Former Cooperative Services, Humboldt Bulk Facility

FIGURE 2: Detailed Site Map Showing Occupied and Work Area

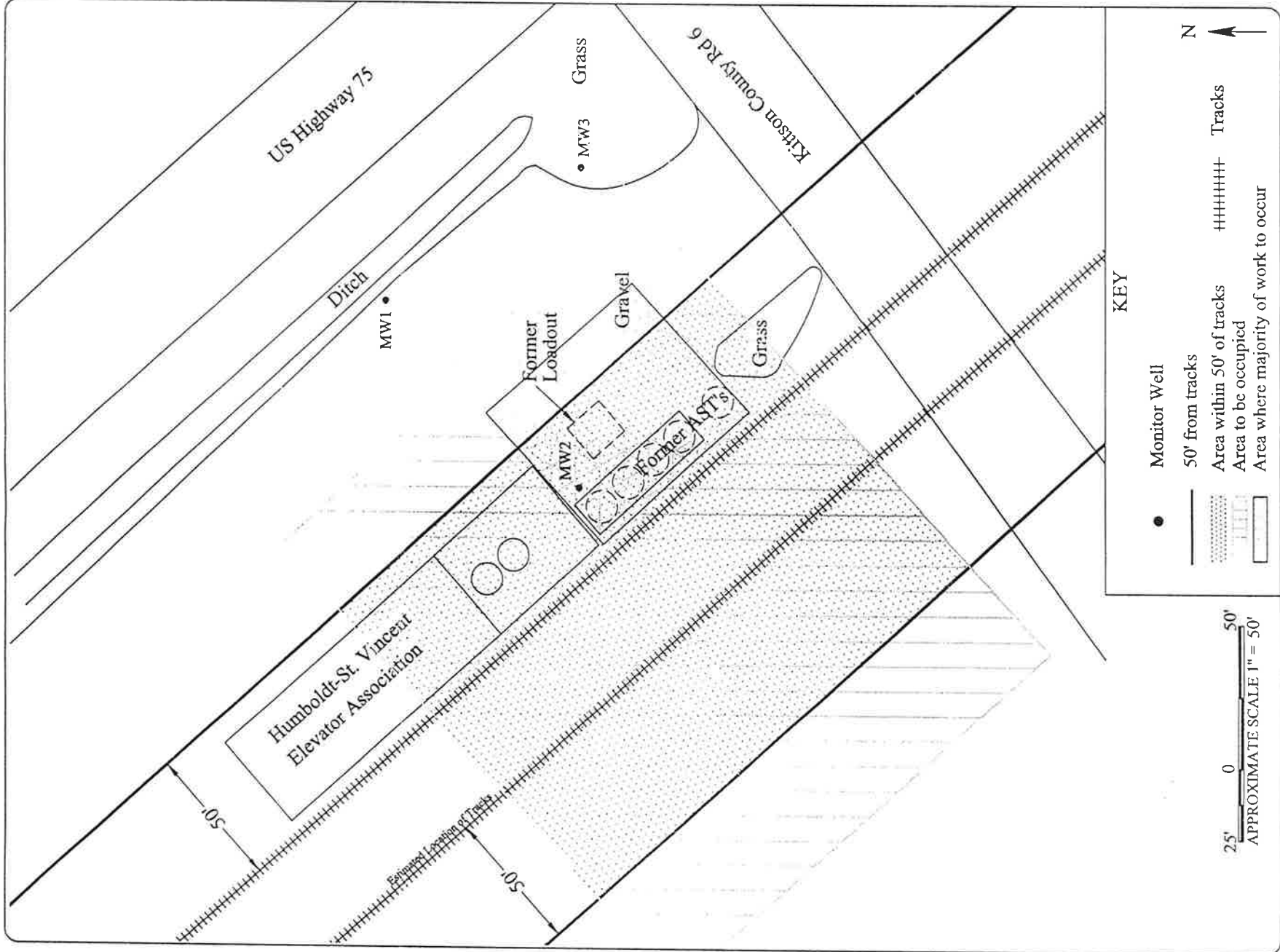

WCC, WCC
8/20/2002 9:20 AM
0405m.dwg



PROJECT No. : 92-405-30 Former Cooperative Services, Humboldt Bulk Facility

FIGURE 2: Detailed Site Map Showing Occupied and Work Area

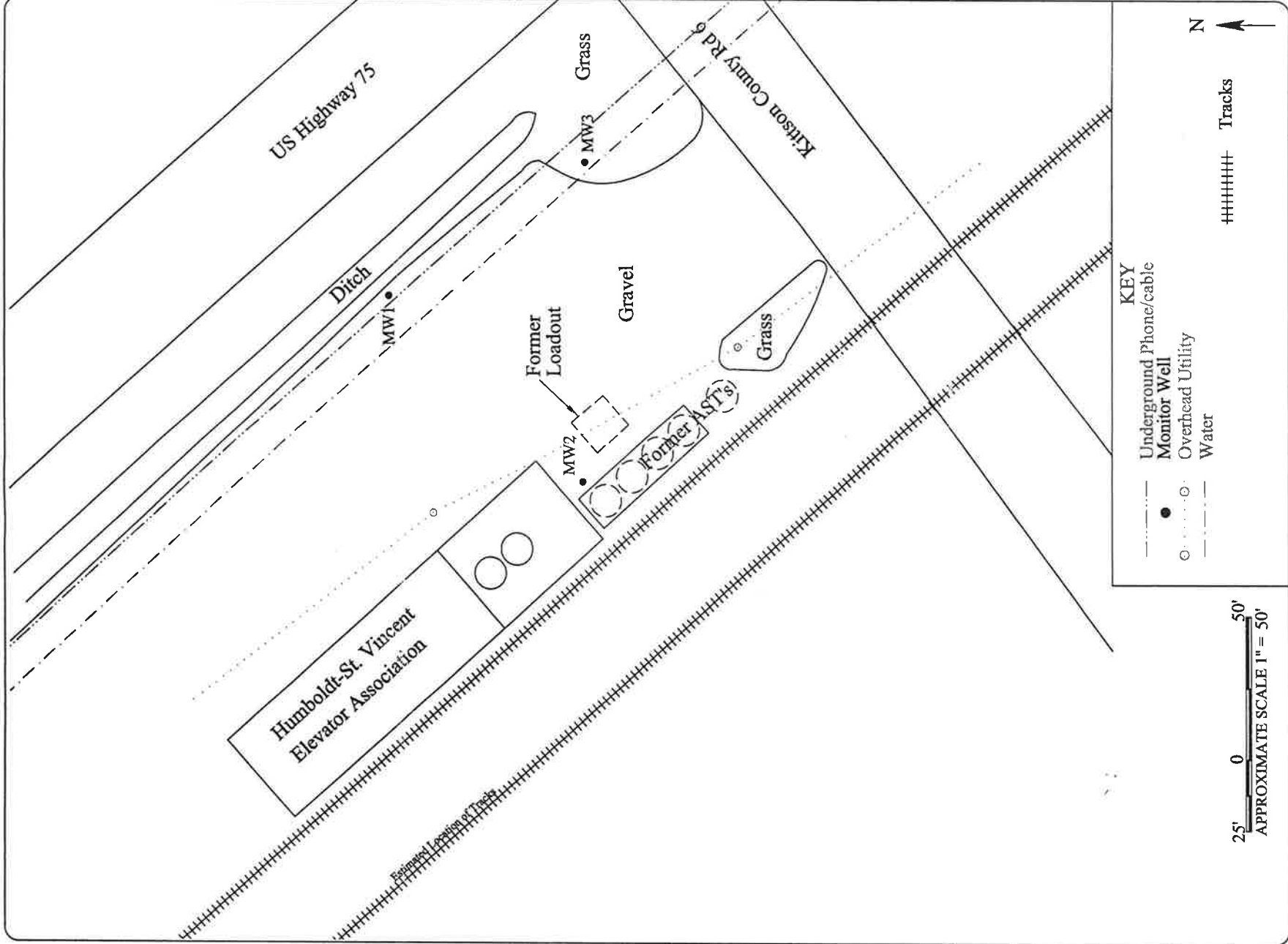

0405mm.dwg 8/20/2002 9:20 AM

PROJECT No.: 92-405-30 Former Cooperative Services, Humboldt Bulk Facility

FIGURE 1: Detailed Site Map



West Central Environmental Consultants

32713

BALANCE

8/19/02 Processing Fee - WCEC Job #405 \$250.00

DEDUCTION

INVOICE AMOUNT

DESCRIPTION

REC'D DATE 8/19/02 CHECK NUMBER 32713 TOTALS \$250.00

West Central Environmental Consultants
14 Green River Road • P.O. Box 594
Morris, MN 56267-0594
320-589-2039

BREMER BANK NATIONAL ASSOCIATION
MORRIS, MN 56267

75-1446919

***Two hundred fifty dollars and 00/100-

PAY TO THE ORDER OF

Burlington Northern Santa Fe Railway Company

DATE 8/19/02

CHECK NO. 32713

AMOUNT \$250.00

Buck Bergman
AUTHORIZED SIGNATURE

⑈032713⑈ ⑆091914464⑆ 0000⑈8088⑈

Security features are included. Write on back.