



January 24, 2014

Jack Curtis, President
Curtis Oil Company
4985 Miller Trunk Hwy
Hermantown MN 55811

Re: Junction Food-N-Fuel Hermantown MN
Additional Air Sampling and Historic Records Examination
MPCA Leak Site 3534
MSA Proj. No 00625001

I. INTRODUCTION

The Junction Food and Fuel site recently received the completion of a corrective action activity involving the replacement of two petroleum-impacted water supply wells, with the project managed under the direct supervision of MSA Professional Services (MSA). In its follow-up report to the Minnesota Pollution Control Agency (MPCA) MSA stated that though the site retained remnant petroleum impacts to its soils and groundwater, the site's receptors of significant concern had been eliminated, and the site's associated hazards to human health, property and the environment appeared reduced to negligible levels. MSA submitted its report with a recommendation for case closure to the MPCA in September, 2013.

Upon its review of MSA's report, the MPCA indicated a concern regarding the presence of various compounds detected in air samples collected at the site's former Junction Food-N-Fuel building – specifically from the sub-slab footprint area beneath the building, from inside the building, and areas outside of the building – detected over the course of the site's past seven years of record. Though the compound detections generally appeared sporadic and of very low concentrations, some of the compounds bore association to solvents not generally found in strictly petroleum-fuel-related contamination sites. A question was put forth as to whether the site had hosted a dry-cleaning operation at some time. In consideration of this concern, the MPCA requested the following additional tasks be completed:

- Collection and analyses of three additional air samples: one from the building's sub-slab area, one from the building's interior, and one from the building's exterior area;
- A limited investigation and review of potential sources of the petroleum and chlorinated compounds that have appeared in the site's record of air analyses.

II. PROJECT METHODS AND PROCEDURES

The Junction Food-N-Fuel site was initially visited by MSA on the afternoon of December 24th, 2013, with three summa canisters provided by ESC laboratories. During the visit, one summa canister was placed within the building's interior; one canister was placed adjacent to and outside of the building, and one

Offices in Illinois, Iowa, Minnesota, and Wisconsin

301 WEST FIRST STREET, SUITE 408 * DULUTH, MINNESOTA 55802
218-722-3915 • 800-777-7380 • FAX: 218-722-4548

WEB ADDRESS: www.msa-ps.com

canister was placed within the building with tubing installed to collect an air sample from the building's sub-slab area (updated Figure 4, attached). For the sub-slab air sample collection, a preexisting access port extending through the building's concrete floor was used: a ¼" hole was drilled through the port's lid; the canister's ¼" plastic sampling tube was inserted; and seals were made around the insertion hole and sampling tube, and around the entire lid of the access port as well as the port's fastenings. The sealant used was an ethylene vinyl acetate (EVA) emulsion, a fast-drying, water-soluble, reversible adhesive. The three canisters, each equipped with a 24-hour regulator, were activated just prior to the tenant business's Christmas holiday closing. The site was then revisited by MSA on the morning of December 26th, 2013; the canister regulators were closed; and the canisters were repacked for immediate return shipment to ESC Laboratories for TO-15 analysis. The period of the air sample collections thus coincided with the building being closed up, with no traffic from customers or employees to contribute to the building's air exchange. Following the air sample collections, the drilled opening in the floor access port's lid was patched using a malleable Epoxy compound.

At the time of MSA's canister collection, an inventory was made of compounds kept on hand within the building by its current tenant.

Following the site visits, MSA visited the Duluth Public Library and reviewed available historic sources regarding the Junction Food-N-Fuel property's former tenants and uses. No historic map coverage of the area was found indicating former tenants or uses of the property. Duluth city directories were found to list such information back to 1960 however, and were reviewed in five-year intervals from 1955 to 2010.

In addition to the Duluth Public Library visit, MSA visited the St. Louis County Assessor's Office and gained information regarding dates of the property's development and building improvements.

III. RESULTS AND DISCUSSION

A. ANALYTICAL RESULTS

Results of this project's air sample analyses are presented along with historical data in an updated version of Table 2 (attached) with divisions a, b and c, according to the subject property building's three areas of air sampling. Current MPCA intrusion screening values (ISVs) for residential sites are included with the interior air data for comparison in Table 2a.

Regarding the building's full record of interior air analyses, a general decline in concentrations appears evident for most compound detections over the past seven years. For the most recent interior air sample, the limited numbers of compounds detected were all revealed in trace concentrations, with not one exceeding or even approaching the MPCA's current ISVs.

The building's full record of sub-slab air sample analyses (Table 2b) shows some similar evidences of overall trends. Time-progressions for some compound concentrations in the building's sub-slab area appear complex, however:

- Concentrations of 'petroleum-fuel marker' compounds, namely benzene; ethylbenzene; toluene; 1,2,4-trimethylbenzene; and total xylenes appear to be diminishing in a fairly uniform manner, in correspondence to their records of detections in the building's interior air.
- Concentrations of 'solvent-associated marker' compounds, namely carbon tetrachloride and trichloroethane /-ethylene (associated with older dry cleaning operations at some sites) also appear to be diminishing over time. With one anomalous exception (trichloroethylene: July 2013) these compounds have not been detected in the building's interior air at any time. (It may be noted that trichloroethylene has been detected in only three out of the five of the site's sub-slab samples, with such detections at concentrations well below the single interior air result of July, 2013. It may be noted that the July 2013 interior air detection of trichloroethylene was not accompanied with a corresponding detection in the sub-slab air sample of the same date.)
- Concentrations of many of the other compounds detected in the building's sub-slab samples appear erratic over time (example: naphthalene) and non-uniform in their relative spikes relative to the specific samples collected and analyzed (example: the elevated concentration of naphthalene in July, 2008 was accompanied with a depressed concentration of 2-butanone in the same sample; for the February 2009 sub-slab air sample, the reverse was true.)
- The erratic appearances of trace concentrations of many of the other compounds detected in the building's sub-slab air samples appear somewhat related to the site's historical groundwater record. Within the site's full span of groundwater collection and analysis data (33 sampling events from 1996 to 2008) some similarly anomalous detections have appeared although rarely, but also sporadically, and also in trace concentrations (Table 12, attached). The lacks of consistency in the groundwater detections as well as the lowness of the constituent concentrations when detected suggest little likelihood of determining a clearly definable source for these compounds.
- Some of the compounds revealed appear to have multiple sources: In the latest sub-slab air sample analyses results, dichlorodifluoromethane and ethanol were detected in trace concentrations. These compounds were also detected in the building's latest interior air sample (along with chloromethane) at concentrations higher than those revealed in the building's sub-slab air sample.

The building's record of outdoor air samples (Table 2c) indicates a fairly consistent presence of several compounds throughout the past seven years: trace concentrations of acetone and dichlorodifluoromethane have been detected in every outdoor air sample collected at the site to date, with 2-butanone, chloromethane, ethanol, and toluene detected in at least half of the site's outdoor air samples.

B. INVENTORY OF SUBSTANCES OBSERVED WITHIN THE SUBJECT PROPERTY BUILDING

Substances observed within the subject property building by MSA during its December 26th, 2013 subject property visit are listed below. All of these substances appeared to be regular cleaning compounds, stocked by the building's current tenant, Casa Latte.

Clorox Disinfecting Wipes

ProForce Sanitizer
Challenge Heavy Duty Degreaser
Stera Sheen Sanitizer and Cleaner
Lysol Toilet Bowl Cleaner
Household Crystals Drain Opener
Bleach
Spray Wax Glass Cleaner
Hot Shot Roach and Ant Killer
Afflab Multi-Purpose Disinfectant
Pro Espresso Machine Cleaning Powder
Dawn Dishwashing Soap
Mr. Clean Magic Eraser Pads

In general, all of the substances were observed in their original, labeled and lidded containers. No unidentifiable substances were observed. No open containers of substances were observed. The substances were shelved in an orderly fashion, reflecting good-housekeeping practices.

C. HISTORICAL RECORD FINDINGS

It appears from the available public record that the subject property was first developed in 1946 with an automobile service station (County Assessor Record). The facility appears to have served as such through at least 2000 under the following business names (Duluth City Directory record; note: no address coverage of the subject property neighborhood's was found for 1955 or earlier; Miller Trunk Highway address numbers changed between 1985 and 1990):

Junction Milage / Junction Service gas station	1960, 1965, 1970
Miller Trunk Fasgas / Jet gas station	1975, 1980
Food-N-Fuel Convenience Store gas station	1985, 1990
Junction Food-N-Fuel / Curtis Convenience store gas station	1995, 2000

After 2000, the subject property's use as filling station facility was discontinued and the building received a retail business, Hearth and Home Fireplaces, as a tenant. In 2008, its tenancy changed again, with the Casa Latte Coffee Shop (its current occupant) taking up residence.

The full range of automotive services that were offered at the subject property's original facility could not be determined from the available record. It is possible that mechanical work may have been conducted on the premises, with such work involving the use of limited quantities of petroleum-related solvents. Mishandling of any such solvents may have occurred on the premises during the service station business' tenure.

City directory entries for the neighborhood immediately surrounding the subject property indicate a diner, a restaurant, and another petroleum distributor (Arrowhead Oil) existed near the subject property, with low-density residential development extending beyond the immediate commercial area in 1960. From 1965 to 1970, the neighborhood appears to have remained largely commercial with residential development on its outskirts, with brief business

tenancies appearing (Gibraltar Homes, Inc., Luomas Custom Kitchens, and McDonald Construction). The neighborhood appears to have experienced a moderate succession of commercial tenant transitions over the next several decades: Arrow Homes, Clarklift of Duluth, Twin Ports Asphalt, Twin Ports Seal Systems, CMP Enterprises, Tropical Pool Constructors, Arrowhead Sales and Service, Northern Fabrication Fire Apparatus and Equipment, Mac's Landscaping Service, Radco Toppers and Truck Accessories, Mac's Rentals and Sales, and most recently, MMT Heating and Cooling, and Turbo Diesel and Electric are recorded to have resided or to be currently residing in the subject property neighborhood through the present. Several of these businesses may have stored and used, or currently store and use small quantities of solvents on their premises. None of the former or current businesses identified appear likely to have stored and used, or currently store and use large quantities of solvents.

IV. CONCLUSIONS

The subject property building's full record of interior air sample collections and analyses appear to have received varying influences over time by the site's subsurface remnant contaminants, by the current tenant's storage and use of cleaning compounds, and by the neighborhood's ambient air. Attempts at bracketing such influences in a source-specific manner continue to yield only a limited understanding of the building as a receptor due to cross-over of compounds among the potential sources, and from many anomalies occurring sporadically within the record itself. Generalities and specific points that can be made from the available records however, appear as follows:

- From the building's latest sampling round, the December, 2013 interior air sample analysis reveals no MPCA intrusion screening value exceedences;
- The building's record of interior air sample analyses shows a general decrease in contaminant concentrations of both 'petroleum-fuel marker' compounds and 'solvent-related' compounds over time.
- Regarding the solvent-related and potential solvent-related compounds identified in the site's sub-slab air samples over the years, their erratic appearances as well as their generally trace concentrations when detected do not appear indicative of a conventional solvent plume beneath the property, as from a release associated with an underground tank. None of the historical information observed during this investigation suggests a likelihood of solvent storage and use on a large scale. The possibility of a former dry-cleaning operation on the premises as suggested earlier thus seems unlikely.

Page 6
Jack Curtis, President
Curtis Oil Company
January 24, 2014

It may be further noted that the significantly lower number of detections and lower concentrations of contaminants revealed in the building's interior air as opposed to those corresponding detections and concentrations from the building's sub-slab area imply an effectiveness of the building's concrete-slab flooring as a barrier to anticipated vapor infiltration from beneath the building into the building's interior.

MSA recommends that the Junction Food-N-Fuel site be reconsidered for case closure by the MPCA.

This report was completed 24th January 2014.

	01/24/2014
Jon Hinkel, P.G.	Date
Senior Project Hydrologist	
Environmental Department	
MSA Professional Services, Inc.	

Attachments: Figure 4 (updated)
Table 2 (updated, divided to a, b, and c)
Table 12
Laboratory Report
Duluth City Directory excerpts, St. Louis County Assessor record

FIGURE 4

**VAPOR INTRUSION ASSESSMENT MAP
(UPDATED)**

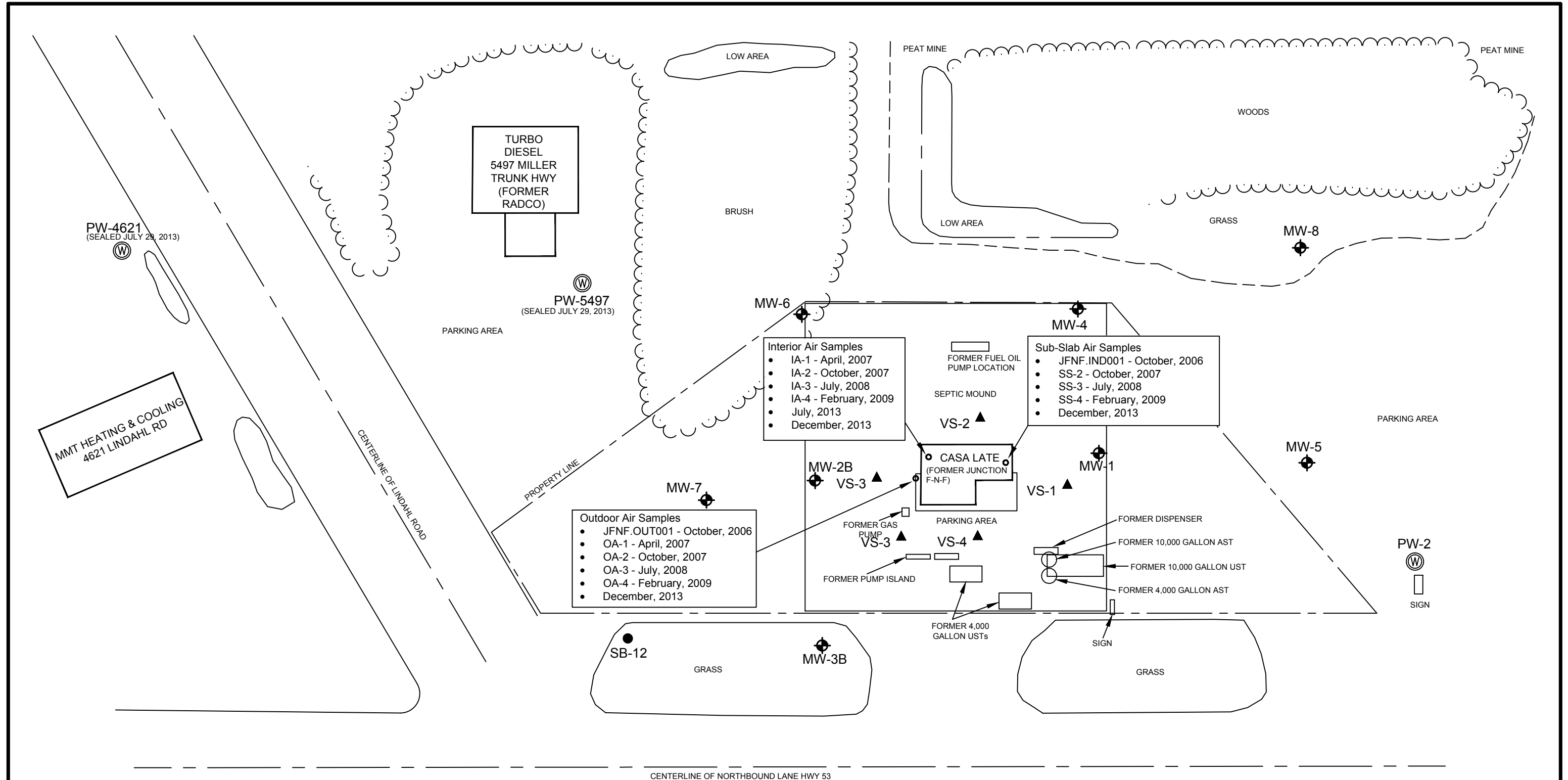

FIGURE 4
VAPOR INTRUSION ASSESSMENT MAP
 JUNCTION FOOD N FUEL
 5493 MILLER TRUNK HWY
 HERMANTOWN, MN

MSA
 TRANSPORTATION • MUNICIPAL
 DEVELOPMENT • ENVIRONMENTAL
 1835 N. Stevens St., Rhinelander, WI 54501
 715-362-3244 • 1-800-844-7854 Fax: 715-362-4116
 Web Address: www.msa-ps.com
 © MSA Professional Services, Inc.

DRAWN BY	CAR	DATE	9/2013	SHEET NO.	2
CHECKED BY	RJH	SCALE	AS SHOWN	FILE NO.	625001

TABLE 2

**AIR SAMPLE ANALYSES RESULTS
(UPDATED)**

Table 2a
Air Sample Analyses: Casa Latte Restaurant
Junction Food-N-Fuel Site

Parameter	Interior Air Samples						MPCA Intrusion Screening Value (Residential)
	concentrations in micrograms per cubic meter						
	April 2007	October 2007	July 2008	February 2009	July 2013	December 2013	
	IA-1	IA-2	IA-3	IA-4			
Acetone	82.6	61.2	96.6	32.6	45	12	31,000
Benzene	< 0.93	1.5	1.8	0.91	< 0.64	0.70	4.5
2-Butanone (MEK)	8.6	9.5	8.9	4.7	5.0	< 3.7	5,000
Carbon Disulfide	< 0.9	0.89	2.1	3.2	0.68	< 0.62	700
Carbon Tetrachloride	< 1.9	< 1.8	< 2.2	< 1.7	< 1.3	< 1.3	0.7
Chloroform	--	--	--	--	13	< 0.97	100
Chloromethane	1.1	1.1	1.5	< 0.56	1.6	1.2	90
Cyclohexane	13.7	< 0.94	< 1.1	9.0	< 0.69	< 0.69	6,000
Dichlorodifluoromethane	2.6	2.5	3.6	2.4	1.7	2.2	200
1,2- Dichloroethane	--	3.7	5.3	1.1	1.3	< 0.81	0.4
Ethanol	--	1,270	675	485	1300	410	15,000
Ethylbenzene	2.8	< 1.2	< 1.5	< 1.2	< 0.87	< 0.87	1,000
4-Ethyltoluene	20.9	4.7	5.9	< 3.4	< 0.98	< 0.98	--
n-Heptane / Heptane	3.3	< 1.1	4.3	6.0	1.2	< 0.82	--
n-Hexane	5.9	1.9	4.9	8.0	1.2	< 0.71	2,000
Isopropylbenzene	--	--	--	--	< 0.98	< 0.98	--
Methylene Chloride	< 1.0	< 0.98	< 1.2	1.0	2.0	< 0.69	20
4-Methyl 2-Pentanone	< 1.2	1.6	1.4	< 1.1	< 5.1	< 5.1	3,000
Methyl Tertiary Butyl Ether	--	--	--	--	< 0.72	< 0.72	3,000
Naphthalene	--	--	--	--	< 3.3	< 3.3	9
2-Propanol	--	92.0	83.4	79.9	54	32	7,000
Propylene	< 0.5	< 0.48	< 0.58	< 0.47	--	--	3,000
Styrene	17.4	11.3	24.3	< 1.2	3.7	< 0.85	1,000
Tetrachloroethylene	--	--	--	--	< 1.4	< 1.4	20
Tetrahydrofuran	< 0.86	< 0.83	< 1.0	< 0.80	0.65	< 0.59	--
Toluene	7.2	4.8	12.6	5.5	5.3	1.2	5,000
Trichlorofluoromethane	--	--	--	--	--	--	700
Trichloroethylene	< 1.6	< 1.5	< 1.8	< 1.5	19	< 1.1	3
1,2,4-Trimethylbenzene	119	25.5	13.0	< 3.4	1.1	< 0.98	7
1,3,5-Trimethylbenzene	48.1	10.0	6.5	< 3.4	< 0.98	< 0.98	6
Vinyl Acetate	--	18.3	< 1.2	< 0.95	< 0.70	< 0.70	200
m & p-Xylene	10.8	4.0	3.8	< 2.4	< 1.7	< 1.7	100
o-Xylene	6.5	2.3	1.7	< 1.2	< 0.87	< 0.87	100
TPH -- Low Fraction	--	--	--	--	< 210	< 210	--

Notes:

Only detected compounds and standard petroleum compounds are included above; see lab reports for full list of analyses.

All analyses results are provided in in micrograms per cubic meter (ug/m3).

-- = analysis not conducted / regulatory standards not yet established / not included in earlier tables

Bold type indicates MPCA Intrusion Screening Value exceedence.

< = below laboratory detection limits

Table 2b

Air Sample Analyses: Casa Latte Restaurant

Junction Food-N-Fuel Site

Parameter	Sub-Slab Samples				
	concentrations in micrograms per cubic meter				
	October 2006	October 2007	July 2008	February 2009	December 2013
JFNF.IND001	SS-2	SS-3	SS-4		
Acetone	252	8.8	46.5	24.9	36
Benzene	3.4	1.4	2.6	0.94	2.3
2-Butanone (MEK)	81.9	2.5	7.6	952	8.8
Carbon Disulfide	2.8	< 1.2	0.94	19.1	8.4
Carbon Tetrachloride	1.9	< 2.6	< 1.9	< 1.7	< 1.3
Chloroform	--	--	--	--	< 0.97
Chloromethane	< 0.56	< 0.83	< 0.60	< 0.56	< 0.41
Cyclohexane	< 0.91	2.8	< 0.97	< 0.91	< 0.69
Dichlorodifluoromethane	5.5	6.0	3.2	< 1.3	1.7
1,2- Dichloroethane	< 1.1	< 1.6	1.3	< 1.1	< 0.81
Ethanol	--	< 3.7	330	< 2.5	53
Ethylbenzene	10	< 1.7	5.2	< 1.2	23
4-Ethyltoluene	25	< 4.9	6.6	< 3.4	< 0.98
n-Heptane / Heptane	5.5	< 1.6	5.5	< 1.1	1.2
n-Hexane	40.2	6.2	3.5	< 0.96	< 0.71
Isopropylbenzene	--	--	--	--	1.1
Methylene Chloride	2.9	5.5	< 1.0	17.0	< 0.69
4-Methyl 2-Pentanone	2.4	< 1.6	< 1.2	1.4	< 5.1
Methyl Tertiary Butyl Ether	--	--	--	--	< 0.72
Naphthalene	< 3.6	< 5.3	300	11.0	< 3.3
2-Propanol	--	14.3	5.5	16.8	44
Propylene	< 0.47	< 0.69	< 0.50	< 0.47	--
Styrene	< 1.2	< 1.7	6.9	2.3	2.6
Tetrachloroethylene	--	--	--	--	1.5
Tetrahydrofuran	471	< 1.2	< 0.86	101	29
Toluene	96.6	14.1	21.3	5.3	53
Trichlorofluoromethane	< 1.5	< 2.2	3.0	< 1.5	--
Trichloroethylene	2.9	7.2	1.7	< 1.5	< 1.1
1,2,4-Trimethylbenzene	134	< 4.9	25.0	< 3.4	2.0
1,3,5-Trimethylbenzene	43.2	< 4.9	6.7	< 3.4	< 0.98
Vinyl Acetate	--	--	--	--	< 0.70
m & p-Xylene	35.5	< 3.5	27.9	3.2	29
o-Xylene	13.8	< 1.7	8.6	< 1.2	7.8
TPH -- Low Fraction	--	--	--	--	450

Notes:

Only detected compounds and standard petroleum compounds are included above; see lab reports for full list of analyses.

All analyses results are provided in in micrograms per cubic meter (ug/m3).

-- = analysis not conducted / regulatory standards not yet established / not included in earlier tables

< = below laboratory detection limits

Table 2c

Air Sample Analyses: Casa Latte Restaurant

Junction Food-N-Fuel Site

Parameter	Outdoor Air Samples					
	concentrations in micrograms per cubic meter					
	October 2006 JFNF.OUT001	April 2007 OA-1	October 2007 OA-2	July 2008 OA-3	February 2009 OA-4	December 2013
Acetone	4.8	8.6	12.4	6.7	42.5	3.1
Benzene	< 0.87	< 1.0	< 0.87	< 1.0	1.8	0.64
2-Butanone (MEK)	< 0.8	< 0.95	1.2	1.1	6.4	< 3.7
Carbon Disulfide	< 0.84	< 1.0	< 0.84	< 1.0	< 0.84	< 0.62
Carbon Tetrachloride	< 1.7	< 2.1	< 1.7	< 2.1	< 1.7	< 1.3
Chloroform	--	--	--	--	--	< 0.97
Chloromethane	< 0.56	< 0.67	0.78	1.1	1.1	1.1
Cyclohexane	< 0.91	< 1.1	< 0.91	< 1.1	3.1	< 0.69
Dichlorodifluoromethane	2.5	2.1	2.6	2.8	3.6	2.1
1,2- Dichloroethane	< 1.1	--	< 1.1	< 1.3	< 1.1	< 0.81
Ethanol	--	--	8.7	< 3.0	13.6	5.1
Ethylbenzene	< 1.2	< 1.4	< 1.2	< 1.4	2.1	< 0.87
4-Ethyltoluene	< 3.4	< 4.0	< 3.4	< 4.0	< 3.4	< 0.98
n-Heptane / Heptane	< 1.1	< 1.3	< 1.1	< 1.3	4.7	< 0.82
n-Hexane	< 0.96	< 1.1	11.4	< 1.1	1.9	< 0.71
Isopropylbenzene	--	--	--	--	--	< 0.98
Methylene Chloride	< 0.95	< 1.1	247	< 1.1	19.6	< 0.69
4-Methyl 2-Pentanone	< 1.1	< 1.3	< 1.1	< 1.3	< 1.1	< 5.1
Methyl Tertiary Butyl Ether	--	--	--	--	--	< 0.72
Naphthalene	< 3.6	--	--	--	--	< 3.3
2-Propanol	--	--	< 3.4	< 4.0	< 3.4	< 3.1
Propylene	< 0.47	< 0.56	< 0.47	< 0.56	< 0.47	--
Styrene	< 1.2	< 1.4	< 1.2	< 1.4	< 1.2	< 0.85
Tetrachloroethylene	--	--	--	--	--	< 1.4
Tetrahydrofuran	< 0.8	< 0.95	< 0.80	< 0.95	< 0.80	< 0.59
Toluene	< 1.0	< 1.2	6.5	1.7	6.1	< 0.75
Trichlorofluoromethane	< 1.5	--	--	--	--	--
Trichloroethylene	< 1.5	< 1.7	< 1.5	< 1.7	5.8	< 1.1
1,2,4-Trimethylbenzene	< 3.4	< 4.0	< 3.4	< 4.0	< 3.4	< 0.98
1,3,5-Trimethylbenzene	< 3.4	< 4.0	< 3.4	< 4.0	< 3.4	< 0.98
Vinyl Acetate	--	--	< 0.95	< 1.1	< 0.95	< 0.70
m & p-Xylene	< 2.4	< 2.8	< 2.4	< 2.8	6.9	< 1.7
o-Xylene	< 1.2	< 1.4	< 1.2	< 1.4	1.8	< 0.87
TPH -- Low Fraction	--	--	--	--	--	< 210

Notes:

Only detected compounds and standard petroleum compounds are included above; see lab reports for full list of analyses.

All analyses results are provided in in micrograms per cubic meter (ug/m3).

-- = analysis not conducted / regulatory standards not yet established / not included in earlier tables

< = below laboratory detection limits

TABLE 12

**OTHER CONTAMINANTS DETECTED IN
WATER SAMPLES COLLECTED FROM WELLS**

Table 12 - Other Contaminants Detected in Water Samples Collected from Wells
Junction Food-N-Fuel, MPCA Leak #3534

Well #	Date sampled	Methyl isobutyl ketone ug/L	Acetone ug/L	1,2,4-trimethylbenzene ug/L	Styrene ug/L	Chloroform ug/L	Ethyl ether ug/L	n-Butyl benzene ug/L	Chloro-methane ug/L	Trichloro-trifluoro-ethane ug/L	Dichloro-difluoro-methane ug/L	1,2-Di-chloro-ethane ug/L	naph-thalene ug/L	bromo-dichloro-methane ug/L	Tri-chloro-fluoro-methane ug/L	Iso-propyl benzene ug/L	n-Propyl benzene ug/L	1,3,5-tri-methyl-benzene ug/L	tert-Butyl benzene ug/L	sec-Butyl benzene ug/L	p-Iso-propyl toluene ug/L
MW-1	1/6/1998	<	<	<	0.8*	11.6*	<	1.2*	<	<	<	<	<	<	1.5*	<	<	<	<	0.7*	<
MW-2a	1/6/1998	<	<	0.9*	0.8*	12.7*	<	1.2*	<	<	<	<	<	<	1.5*	<	<	<	<	0.7*	<
	4/6/1998	<	<	7.7	<	<	<	<	<	<	<	<	<	<	<	<	1.5*	2.0*	<	<	<
MW-2b	2/12/2003		<250	530	<50	<50	<50	<50	<50	<50	<50	<50	66	<50	<50	<50	65	140	<50	<50	<50
	5/21/2003		<100	380	<20	<20		<20	<20		<20	<20	24	<20	<20	26	26	140	<20	<20	<20
MW-3a	1/6/1998	<	<	<	0.8*	12.1*	<	0.5*	<	<	<	<	<	<	1.3*	<	<	<	<	<	<
MW-3b	2/12/2003		<50	850	<10	<10	<10	<10	<10	<10	<10	<10	150	<10	<10	110	280	460	<10	<10	23
	5/21/2003		80	55	<1	<1		6.6	<1		<1	<1	2.4	<1	<1	1.9	6.1	31	<1	<1	<1
MW-4	1/6/1998	<	<	29.5	0.8*	<	<	14.2	<	<	<	<	<	<	1.3*	2.8*	4.2*	8.6	1.4*	3.9	3.1*
	4/6/1998	<	<	0.6*	<	<	5.4*	4	<	<	<	<	10	<	<	1.0*	1.5*	0.8*	<	1.5*	<
MW-5	1/6/1998	<	<	1.4*	0.8*	<	<	2.3*	<	1.3*	<	<	<	<	<	0.8*	0.9*	0.5*	<	<	0.6*
	4/6/1998	<	<	3.8*	0.7*	<	<	0.4*	<	<	<	<	11.8	<	<	1.7*	1.4*	0.6*	<	1.6*	<
MW-6	1/6/1998	<	<	<	0.8*	<	<	1.4*	<	<	<	<	<	<	<	<	<	<	<	<	<
	4/6/1998	<	<	7.7	<	<	<	<	<	<	<	<	<	<	<	<	1.5*	2.0*	<	<	<
MW-7	1/6/1998	<	<	<	0.8*	<	<	1.3*	<	1.2*	<	2.4*	<	1.3*	<	<	<	0.6*	<	<	<
	4/6/1998	<	<	0.9*	<	<	<	<	<	<	<	3.5	<	<	<	<	<	<	<	<	<
MW-8	2/12/2003		<10	81	<2	<2		<2	<2	<2	<2	<2	7.4	<2	<2	3.4	4.2	18	<2	<2	<2
	5/21/2003		5.2	5.3	<1	<1		<1	<1	<1	<1	<1	<1	<1	<1	<1	<1	1.5	<1	<1	<1
Field Blank	12/17/1997		8.8	<1	<1	2.5	<5	<1	<2	<1	<2	<1	<2	<1	<1	<1	<1	<1	<1	<1	<1
PW-1	8/4/1997	1.4	<	<	<	<	<	<	<	<	<	<	<	<	1.4	<	<	<	<	<	<
	1/6/1998	<	<	<	0.8*	11.3*	<	0.5*	54.1	1.5*	<	<	<	<	<	<	<	0.8*	<	11.3*	<
	4/9/1998	<	<	<	1.0*	1.1*	<	<	12.4*	<	32.9*	0.8*	<	<	<	<	<	1.0*	<	1.1*	<
PW-2	12/17/1997		<5	<1	<1	1.1		<1	<2	<1	<2	<1	<2	<1	<1	<1	<1	<1	<1	<1	<1
	2/12/2003		350*	<2	<2	<2		<2	<2	<2	<2	<2	<2	<2	<2	<2	<2	<2	<2	<2	<2
PW-5506A	7/14/2008		<5	<1	<1	<5	<1	<1	<1		7.0	<1	<5	<1	<1	<1	<1	<1	<1	<1	<1

Notes:

< = below detection limits.

* = see individual laboratory report for notes concerning results.

Results in bold equal or exceed the HRL.

█ = Not analyzed for.

LABORATORY REPORT



12065 Lebanon Rd.
Mt. Juliet, TN 37122
(615) 758-5858
1-800-767-5859
Fax (615) 758-5859

Tax I.D. 62-0814289

Est. 1970

Jon Hinkel
MSA Professional Services
301 West First St. Ste 408
Duluth, MN 55802

Report Summary

Monday January 06, 2014

Report Number: L676046

Samples Received: 12/30/13

Client Project: R-00625001

Description: Junction F-N-F

The analytical results in this report are based upon information supplied by you, the client, and are for your exclusive use. If you have any questions regarding this data package, please do not hesitate to call.

Entire Report Reviewed By:

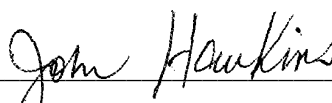
John Hawkins , ESC Representative

Laboratory Certification Numbers

A2LA - 1461-01, AIHA - 100789, AL - 40660, CA - 01157CA, CT - PH-0197,
FL - E87487, GA - 923, IN - C-TN-01, KY - 90010, KYUST - 0016,
NC - ENV375/DW21704/BIO041, ND - R-140. NJ - TN002, NJ NELAP - TN002,
SC - 84004, TN - 2006, VA - 460132, WV - 233, AZ - 0612,
MN - 047-999-395, NY - 11742, WI - 998093910, NV - TN000032011-1,
TX - T104704245-11-3, OK - 9915, PA - 68-02979, IA Lab #364, EPA - TN002

Accreditation is only applicable to the test methods specified on each scope of accreditation held by ESC Lab Sciences.

Note: The use of the preparatory EPA Method 3511 is not approved or endorsed by the CA ELAP.

This report may not be reproduced, except in full, without written approval from ESC Lab Sciences. Where applicable, sampling conducted by ESC is performed per guidance provided in laboratory standard operating procedures: 060302, 060303, and 060304.



12065 Lebanon Rd.
 Mt. Juliet, TN 37122
 (615) 758-5858
 1-800-767-5859
 Fax (615) 758-5859

Tax I.D. 62-0814289

Est. 1970

REPORT OF ANALYSIS

Jon Hinkel
 MSA Professional Services
 301 West First St. Ste 408
 Duluth, MN 55802

January 06, 2014

Date Received : December 30, 2013
 Description : Junction F-N-F

ESC Sample # : L676046-01

Sample ID : OUTDOOR AIR SAMPLE

Site ID :

Collected By : Jon Hinkel
 Collection Date : 12/26/13 08:46

Project # : R-00625001

Parameter	Cas#	Mol Wght	RDL1	RDL2	ppbv	ug/m3	Method	Date	Dil.
Volatile Organics									
Acetone	67-64-1	58.1	1.25	3.00	1.3	3.1	TO-15	01/03/14	1
Allyl chloride	107-05-1	76.53	0.200	0.630	< 0.20	< 0.63	TO-15	01/03/14	1
Benzene	71-43-2	78.1	0.200	0.640	0.20	0.64	TO-15	01/03/14	1
Benzyl Chloride	100-44-7	127	0.200	1.00	< 0.20	< 1.0	TO-15	01/03/14	1
Bromodichloromethane	75-27-4	164	0.200	1.30	< 0.20	< 1.3	TO-15	01/03/14	1
Bromoform	75-25-2	253	0.600	6.20	< 0.60	< 6.2	TO-15	01/03/14	1
Bromomethane	74-83-9	94.9	0.200	0.780	< 0.20	< 0.78	TO-15	01/03/14	1
1,3-Butadiene	106-99-0	54.1	2.00	4.40	< 2.0	< 4.4	TO-15	01/03/14	1
Carbon disulfide	75-15-0	76.1	0.200	0.620	< 0.20	< 0.62	TO-15	01/03/14	1
Carbon tetrachloride	56-23-5	154	0.200	1.30	< 0.20	< 1.3	TO-15	01/03/14	1
Chlorobenzene	108-90-7	113	0.200	0.920	< 0.20	< 0.92	TO-15	01/03/14	1
Chloroethane	75-00-3	64.5	0.200	0.530	< 0.20	< 0.53	TO-15	01/03/14	1
Chloroform	67-66-3	119	0.200	0.970	< 0.20	< 0.97	TO-15	01/03/14	1
Chloromethane	74-87-3	50.5	0.200	0.410	0.55	1.1	TO-15	01/03/14	1
2-Chlorotoluene	95-49-8	126	0.200	1.00	< 0.20	< 1.0	TO-15	01/03/14	1
Cyclohexane	110-82-7	84.2	0.200	0.690	< 0.20	< 0.69	TO-15	01/03/14	1
Dibromochloromethane	124-48-1	208	0.200	1.70	< 0.20	< 1.7	TO-15	01/03/14	1
1,2-Dibromoethane	106-93-4	188	0.200	1.50	< 0.20	< 1.5	TO-15	01/03/14	1
1,2-Dichlorobenzene	95-50-1	147	0.200	1.20	< 0.20	< 1.2	TO-15	01/03/14	1
1,3-Dichlorobenzene	541-73-1	147	0.200	1.20	< 0.20	< 1.2	TO-15	01/03/14	1
1,4-Dichlorobenzene	106-46-7	147	0.200	1.20	< 0.20	< 1.2	TO-15	01/03/14	1
1,2-Dichloroethane	107-06-2	99	0.200	0.810	< 0.20	< 0.81	TO-15	01/03/14	1
1,1-Dichloroethane	75-34-3	98	0.200	0.800	< 0.20	< 0.80	TO-15	01/03/14	1
1,1-Dichloroethene	75-35-4	96.9	0.200	0.790	< 0.20	< 0.79	TO-15	01/03/14	1
cis-1,2-Dichloroethene	156-59-2	96.9	0.200	0.790	< 0.20	< 0.79	TO-15	01/03/14	1
trans-1,2-Dichloroethene	156-60-5	96.9	0.200	0.790	< 0.20	< 0.79	TO-15	01/03/14	1
1,2-Dichloropropane	78-87-5	113	0.200	0.920	< 0.20	< 0.92	TO-15	01/03/14	1
cis-1,3-Dichloropropene	10061-01-5	111	0.200	0.910	< 0.20	< 0.91	TO-15	01/03/14	1
trans-1,3-Dichloropropene	10061-02-6	111	0.200	0.910	< 0.20	< 0.91	TO-15	01/03/14	1
1,4-Dioxane	123-91-1	88.1	0.200	0.720	< 0.20	< 0.72	TO-15	01/03/14	1
Ethanol	64-17-5	46.1	0.630	1.20	2.7	5.1	TO-15	01/03/14	1
Ethylbenzene	100-41-4	106	0.200	0.870	< 0.20	< 0.87	TO-15	01/03/14	1
4-Ethyltoluene	622-96-8	120	0.200	0.980	< 0.20	< 0.98	TO-15	01/03/14	1
Trichlorofluoromethane	75-69-4	137.4	0.200	1.10	< 0.20	< 1.1	TO-15	01/03/14	1
Dichlorodifluoromethane	75-71-8	120.92	0.200	0.990	0.43	2.1	TO-15	01/03/14	1
1,1,2-Trichlorotrifluoroethane	76-13-1	187.4	0.200	1.50	< 0.20	< 1.5	TO-15	01/03/14	1
1,2-Dichlorotetrafluoroethane	76-14-2	171	0.200	1.40	< 0.20	< 1.4	TO-15	01/03/14	1
Heptane	142-82-5	100	0.200	0.820	< 0.20	< 0.82	TO-15	01/03/14	1
Hexachloro-1,3-butadiene	87-68-3	261	0.630	6.70	< 0.63	< 6.7	TO-15	01/03/14	1
n-Hexane	110-54-3	86.2	0.200	0.710	< 0.20	< 0.71	TO-15	01/03/14	1
Isopropylbenzene	98-82-8	120.2	0.200	0.980	< 0.20	< 0.98	TO-15	01/03/14	1
Methylene Chloride	75-09-2	84.9	0.200	0.690	< 0.20	< 0.69	TO-15	01/03/14	1
Methyl Butyl Ketone	591-78-6	100	1.25	5.10	< 1.3	< 5.1	TO-15	01/03/14	1

RDL1 = ppbv , RDL2 = ug/m3

Note:

Units are based on (STP) - Standard Temperature and Pressure

The reported analytical results relate only to the sample submitted.

This report shall not be reproduced, except in full, without the written approval from ESC.

Reported: 01/06/14 11:06 Printed: 01/06/14 12:15



12065 Lebanon Rd.
 Mt. Juliet, TN 37122
 (615) 758-5858
 1-800-767-5859
 Fax (615) 758-5859

Tax I.D. 62-0814289

Est. 1970

REPORT OF ANALYSIS

Jon Hinkel
 MSA Professional Services
 301 West First St. Ste 408
 Duluth, MN 55802

January 06, 2014

Date Received : December 30, 2013
 Description : Junction F-N-F

ESC Sample # : L676046-01

Sample ID : OUTDOOR AIR SAMPLE

Site ID :

Collected By : Jon Hinkel
 Collection Date : 12/26/13 08:46

Project # : R-00625001

Parameter	Cas#	Mol Wght	RDL1	RDL2	ppbv	ug/m3	Method	Date	Dil.
2-Butanone (MEK)	78-93-3	72.1	1.25	3.70	< 1.3	< 3.7	TO-15	01/03/14	1
4-Methyl-2-pentanone (MIBK)	108-10-1	100.1	1.25	5.10	< 1.3	< 5.1	TO-15	01/03/14	1
Methyl methacrylate	80-62-6	100.12	0.200	0.820	< 0.20	< 0.82	TO-15	01/03/14	1
MTBE	1634-04-4	88.1	0.200	0.720	< 0.20	< 0.72	TO-15	01/03/14	1
Naphthalene	91-20-3	128	0.630	3.30	< 0.63	< 3.3	TO-15	01/03/14	1
2-Propanol	67-63-0	60.1	1.25	3.10	< 1.3	< 3.1	TO-15	01/03/14	1
Propene	115-07-1	42.1	0.400	0.690	< 0.40	< 0.69	TO-15	01/03/14	1
Styrene	100-42-5	104	0.200	0.850	< 0.20	< 0.85	TO-15	01/03/14	1
1,1,2,2-Tetrachloroethane	79-34-5	168	0.200	1.40	< 0.20	< 1.4	TO-15	01/03/14	1
Tetrachloroethylene	127-18-4	166	0.200	1.40	< 0.20	< 1.4	TO-15	01/03/14	1
Tetrahydrofuran	109-99-9	72.1	0.200	0.590	< 0.20	< 0.59	TO-15	01/03/14	1
Toluene	108-88-3	92.1	0.200	0.750	< 0.20	< 0.75	TO-15	01/03/14	1
1,2,4-Trichlorobenzene	120-82-1	181	0.630	4.70	< 0.63	< 4.7	TO-15	01/03/14	1
1,1,1-Trichloroethane	71-55-6	133	0.200	1.10	< 0.20	< 1.1	TO-15	01/03/14	1
1,1,2-Trichloroethane	79-00-5	133	0.200	1.10	< 0.20	< 1.1	TO-15	01/03/14	1
Trichloroethylene	79-01-6	131	0.200	1.10	< 0.20	< 1.1	TO-15	01/03/14	1
1,2,4-Trimethylbenzene	95-63-6	120	0.200	0.980	< 0.20	< 0.98	TO-15	01/03/14	1
1,3,5-Trimethylbenzene	108-67-8	120	0.200	0.980	< 0.20	< 0.98	TO-15	01/03/14	1
2,2,4-Trimethylpentane	540-84-1	114.22	0.200	0.930	< 0.20	< 0.93	TO-15	01/03/14	1
Vinyl chloride	75-01-4	62.5	0.200	0.510	< 0.20	< 0.51	TO-15	01/03/14	1
Vinyl Bromide	593-60-2	106.95	0.200	0.870	< 0.20	< 0.87	TO-15	01/03/14	1
Vinyl acetate	108-05-4	86.1	0.200	0.700	< 0.20	< 0.70	TO-15	01/03/14	1
m&p-Xylene	1330-20-7	106	0.400	1.70	< 0.40	< 1.7	TO-15	01/03/14	1
o-Xylene	95-47-6	106	0.200	0.870	< 0.20	< 0.87	TO-15	01/03/14	1
TPH (GC/MS) Low Fraction	8006-61-9	101	50.0	210.	< 50.	< 210	TO-15	01/03/14	1
1,4-Bromofluorobenzene	460-00-4				91.7	% Rec.	TO-15	01/03/14	1

RDL1 = ppbv , RDL2 = ug/m3

Note:

Units are based on (STP) - Standard Temperature and Pressure

The reported analytical results relate only to the sample submitted.

This report shall not be reproduced, except in full, without the written approval from ESC.

Reported: 01/06/14 11:06 Printed: 01/06/14 12:15



12065 Lebanon Rd.
 Mt. Juliet, TN 37122
 (615) 758-5858
 1-800-767-5859
 Fax (615) 758-5859

Tax I.D. 62-0814289

Est. 1970

REPORT OF ANALYSIS

Jon Hinkel
 MSA Professional Services
 301 West First St. Ste 408
 Duluth, MN 55802

January 06, 2014

Date Received : December 30, 2013
 Description : Junction F-N-F

ESC Sample # : L676046-02

Sample ID : INTERIOR AIR SAMPLE

Site ID :

Collected By : Jon Hinkel
 Collection Date : 12/26/13 08:50

Project # : R-00625001

Parameter	Cas#	Mol Wght	RDL1	RDL2	ppbv	ug/m3	Method	Date	Dil.
Volatile Organics									
Acetone	67-64-1	58.1	1.25	3.00	5.0	12.	TO-15	01/03/14	1
Allyl chloride	107-05-1	76.53	0.200	0.630	< 0.20	< 0.63	TO-15	01/03/14	1
Benzene	71-43-2	78.1	0.200	0.640	0.22	0.70	TO-15	01/03/14	1
Benzyl Chloride	100-44-7	127	0.200	1.00	< 0.20	< 1.0	TO-15	01/03/14	1
Bromodichloromethane	75-27-4	164	0.200	1.30	< 0.20	< 1.3	TO-15	01/03/14	1
Bromoform	75-25-2	253	0.600	6.20	< 0.60	< 6.2	TO-15	01/03/14	1
Bromomethane	74-83-9	94.9	0.200	0.780	< 0.20	< 0.78	TO-15	01/03/14	1
1,3-Butadiene	106-99-0	54.1	2.00	4.40	< 2.0	< 4.4	TO-15	01/03/14	1
Carbon disulfide	75-15-0	76.1	0.200	0.620	< 0.20	< 0.62	TO-15	01/03/14	1
Carbon tetrachloride	56-23-5	154	0.200	1.30	< 0.20	< 1.3	TO-15	01/03/14	1
Chlorobenzene	108-90-7	113	0.200	0.920	< 0.20	< 0.92	TO-15	01/03/14	1
Chloroethane	75-00-3	64.5	0.200	0.530	< 0.20	< 0.53	TO-15	01/03/14	1
Chloroform	67-66-3	119	0.200	0.970	< 0.20	< 0.97	TO-15	01/03/14	1
Chloromethane	74-87-3	50.5	0.200	0.410	0.60	1.2	TO-15	01/03/14	1
2-Chlorotoluene	95-49-8	126	0.200	1.00	< 0.20	< 1.0	TO-15	01/03/14	1
Cyclohexane	110-82-7	84.2	0.200	0.690	< 0.20	< 0.69	TO-15	01/03/14	1
Dibromochloromethane	124-48-1	208	0.200	1.70	< 0.20	< 1.7	TO-15	01/03/14	1
1,2-Dibromoethane	106-93-4	188	0.200	1.50	< 0.20	< 1.5	TO-15	01/03/14	1
1,2-Dichlorobenzene	95-50-1	147	0.200	1.20	< 0.20	< 1.2	TO-15	01/03/14	1
1,3-Dichlorobenzene	541-73-1	147	0.200	1.20	< 0.20	< 1.2	TO-15	01/03/14	1
1,4-Dichlorobenzene	106-46-7	147	0.200	1.20	< 0.20	< 1.2	TO-15	01/03/14	1
1,2-Dichloroethane	107-06-2	99	0.200	0.810	< 0.20	< 0.81	TO-15	01/03/14	1
1,1-Dichloroethane	75-34-3	98	0.200	0.800	< 0.20	< 0.80	TO-15	01/03/14	1
1,1-Dichloroethene	75-35-4	96.9	0.200	0.790	< 0.20	< 0.79	TO-15	01/03/14	1
cis-1,2-Dichloroethene	156-59-2	96.9	0.200	0.790	< 0.20	< 0.79	TO-15	01/03/14	1
trans-1,2-Dichloroethene	156-60-5	96.9	0.200	0.790	< 0.20	< 0.79	TO-15	01/03/14	1
1,2-Dichloropropane	78-87-5	113	0.200	0.920	< 0.20	< 0.92	TO-15	01/03/14	1
cis-1,3-Dichloropropene	10061-01-5	111	0.200	0.910	< 0.20	< 0.91	TO-15	01/03/14	1
trans-1,3-Dichloropropene	10061-02-6	111	0.200	0.910	< 0.20	< 0.91	TO-15	01/03/14	1
1,4-Dioxane	123-91-1	88.1	0.200	0.720	< 0.20	< 0.72	TO-15	01/03/14	1
Ethanol	64-17-5	46.1	15.8	30.0	220	410	TO-15	01/04/14	25
Ethylbenzene	100-41-4	106	0.200	0.870	< 0.20	< 0.87	TO-15	01/03/14	1
4-Ethyltoluene	622-96-8	120	0.200	0.980	< 0.20	< 0.98	TO-15	01/03/14	1
Trichlorofluoromethane	75-69-4	137.4	0.200	1.10	< 0.20	< 1.1	TO-15	01/03/14	1
Dichlorodifluoromethane	75-71-8	120.92	0.200	0.990	0.44	2.2	TO-15	01/03/14	1
1,1,2-Trichlorotrifluoroethane	76-13-1	187.4	0.200	1.50	< 0.20	< 1.5	TO-15	01/03/14	1
1,2-Dichlorotetrafluoroethane	76-14-2	171	0.200	1.40	< 0.20	< 1.4	TO-15	01/03/14	1
Heptane	142-82-5	100	0.200	0.820	< 0.20	< 0.82	TO-15	01/03/14	1
Hexachloro-1,3-butadiene	87-68-3	261	0.630	6.70	< 0.63	< 6.7	TO-15	01/03/14	1
n-Hexane	110-54-3	86.2	0.200	0.710	< 0.20	< 0.71	TO-15	01/03/14	1
Isopropylbenzene	98-82-8	120.2	0.200	0.980	< 0.20	< 0.98	TO-15	01/03/14	1
Methylene Chloride	75-09-2	84.9	0.200	0.690	< 0.20	< 0.69	TO-15	01/03/14	1
Methyl Butyl Ketone	591-78-6	100	1.25	5.10	< 1.3	< 5.1	TO-15	01/03/14	1

RDL1 = ppbv , RDL2 = ug/m3

Note:

Units are based on (STP) - Standard Temperature and Pressure

The reported analytical results relate only to the sample submitted.

This report shall not be reproduced, except in full, without the written approval from ESC.

Reported: 01/06/14 11:06 Printed: 01/06/14 12:15



12065 Lebanon Rd.
 Mt. Juliet, TN 37122
 (615) 758-5858
 1-800-767-5859
 Fax (615) 758-5859

Tax I.D. 62-0814289

Est. 1970

REPORT OF ANALYSIS

Jon Hinkel
 MSA Professional Services
 301 West First St. Ste 408
 Duluth, MN 55802

January 06, 2014

Date Received : December 30, 2013
 Description : Junction F-N-F
 Sample ID : INTERIOR AIR SAMPLE
 Collected By : Jon Hinkel
 Collection Date : 12/26/13 08:50

ESC Sample # : L676046-02
 Site ID :
 Project # : R-00625001

Parameter	Cas#	Mol Wght	RDL1	RDL2	ppbv	ug/m3	Method	Date	Dil.
2-Butanone (MEK)	78-93-3	72.1	1.25	3.70	< 1.3	< 3.7	TO-15	01/03/14	1
4-Methyl-2-pentanone (MIBK)	108-10-1	100.1	1.25	5.10	< 1.3	< 5.1	TO-15	01/03/14	1
Methyl methacrylate	80-62-6	100.12	0.200	0.820	< 0.20	< 0.82	TO-15	01/03/14	1
MTBE	1634-04-4	88.1	0.200	0.720	< 0.20	< 0.72	TO-15	01/03/14	1
Naphthalene	91-20-3	128	0.630	3.30	< 0.63	< 3.3	TO-15	01/03/14	1
2-Propanol	67-63-0	60.1	1.25	3.10	13.	32.	TO-15	01/03/14	1
Propene	115-07-1	42.1	0.400	0.690	< 0.40	< 0.69	TO-15	01/03/14	1
Styrene	100-42-5	104	0.200	0.850	< 0.20	< 0.85	TO-15	01/03/14	1
1,1,2,2-Tetrachloroethane	79-34-5	168	0.200	1.40	< 0.20	< 1.4	TO-15	01/03/14	1
Tetrachloroethylene	127-18-4	166	0.200	1.40	< 0.20	< 1.4	TO-15	01/03/14	1
Tetrahydrofuran	109-99-9	72.1	0.200	0.590	< 0.20	< 0.59	TO-15	01/03/14	1
Toluene	108-88-3	92.1	0.200	0.750	0.33	1.2	TO-15	01/03/14	1
1,2,4-Trichlorobenzene	120-82-1	181	0.630	4.70	< 0.63	< 4.7	TO-15	01/03/14	1
1,1,1-Trichloroethane	71-55-6	133	0.200	1.10	< 0.20	< 1.1	TO-15	01/03/14	1
1,1,2-Trichloroethane	79-00-5	133	0.200	1.10	< 0.20	< 1.1	TO-15	01/03/14	1
Trichloroethylene	79-01-6	131	0.200	1.10	< 0.20	< 1.1	TO-15	01/03/14	1
1,2,4-Trimethylbenzene	95-63-6	120	0.200	0.980	< 0.20	< 0.98	TO-15	01/03/14	1
1,3,5-Trimethylbenzene	108-67-8	120	0.200	0.980	< 0.20	< 0.98	TO-15	01/03/14	1
2,2,4-Trimethylpentane	540-84-1	114.22	0.200	0.930	< 0.20	< 0.93	TO-15	01/03/14	1
Vinyl chloride	75-01-4	62.5	0.200	0.510	< 0.20	< 0.51	TO-15	01/03/14	1
Vinyl Bromide	593-60-2	106.95	0.200	0.870	< 0.20	< 0.87	TO-15	01/03/14	1
Vinyl acetate	108-05-4	86.1	0.200	0.700	< 0.20	< 0.70	TO-15	01/03/14	1
m&p-Xylene	1330-20-7	106	0.400	1.70	< 0.40	< 1.7	TO-15	01/03/14	1
o-Xylene	95-47-6	106	0.200	0.870	< 0.20	< 0.87	TO-15	01/03/14	1
TPH (GC/MS) Low Fraction	8006-61-9	101	50.0	210.	< 50.	< 210	TO-15	01/03/14	1
1,4-Bromofluorobenzene	460-00-4				92.9	% Rec.	TO-15	01/03/14	1

RDL1 = ppbv , RDL2 = ug/m3

Note:

Units are based on (STP) - Standard Temperature and Pressure

The reported analytical results relate only to the sample submitted.

This report shall not be reproduced, except in full, without the written approval from ESC.

Reported: 01/06/14 11:06 Printed: 01/06/14 12:15



12065 Lebanon Rd.
 Mt. Juliet, TN 37122
 (615) 758-5858
 1-800-767-5859
 Fax (615) 758-5859

Tax I.D. 62-0814289

Est. 1970

REPORT OF ANALYSIS

Jon Hinkel
 MSA Professional Services
 301 West First St. Ste 408
 Duluth, MN 55802

January 06, 2014

Date Received : December 30, 2013
 Description : Junction F-N-F
 Sample ID : SUB-SLAB AIR SAMPLE
 Collected By : Jon Hinkel
 Collection Date : 12/26/13 08:52

ESC Sample # : L676046-03
 Site ID :
 Project # : R-00625001

Parameter	Cas#	Mol Wght	RDL1	RDL2	ppbv	ug/m3	Method	Date	Dil.
Volatile Organics									
Acetone	67-64-1	58.1	1.25	3.00	15.	36.	TO-15	01/03/14	1
Allyl chloride	107-05-1	76.53	0.200	0.630	< 0.20	< 0.63	TO-15	01/03/14	1
Benzene	71-43-2	78.1	0.200	0.640	0.71	2.3	TO-15	01/03/14	1
Benzyl Chloride	100-44-7	127	0.200	1.00	< 0.20	< 1.0	TO-15	01/03/14	1
Bromodichloromethane	75-27-4	164	0.200	1.30	< 0.20	< 1.3	TO-15	01/03/14	1
Bromoform	75-25-2	253	0.600	6.20	< 0.60	< 6.2	TO-15	01/03/14	1
Bromomethane	74-83-9	94.9	0.200	0.780	< 0.20	< 0.78	TO-15	01/03/14	1
1,3-Butadiene	106-99-0	54.1	2.00	4.40	< 2.0	< 4.4	TO-15	01/03/14	1
Carbon disulfide	75-15-0	76.1	0.200	0.620	2.7	8.4	TO-15	01/03/14	1
Carbon tetrachloride	56-23-5	154	0.200	1.30	< 0.20	< 1.3	TO-15	01/03/14	1
Chlorobenzene	108-90-7	113	0.200	0.920	< 0.20	< 0.92	TO-15	01/03/14	1
Chloroethane	75-00-3	64.5	0.200	0.530	< 0.20	< 0.53	TO-15	01/03/14	1
Chloroform	67-66-3	119	0.200	0.970	< 0.20	< 0.97	TO-15	01/03/14	1
Chloromethane	74-87-3	50.5	0.200	0.410	< 0.20	< 0.41	TO-15	01/03/14	1
2-Chlorotoluene	95-49-8	126	0.200	1.00	< 0.20	< 1.0	TO-15	01/03/14	1
Cyclohexane	110-82-7	84.2	0.200	0.690	< 0.20	< 0.69	TO-15	01/03/14	1
Dibromochloromethane	124-48-1	208	0.200	1.70	< 0.20	< 1.7	TO-15	01/03/14	1
1,2-Dibromoethane	106-93-4	188	0.200	1.50	< 0.20	< 1.5	TO-15	01/03/14	1
1,2-Dichlorobenzene	95-50-1	147	0.200	1.20	< 0.20	< 1.2	TO-15	01/03/14	1
1,3-Dichlorobenzene	541-73-1	147	0.200	1.20	< 0.20	< 1.2	TO-15	01/03/14	1
1,4-Dichlorobenzene	106-46-7	147	0.200	1.20	< 0.20	< 1.2	TO-15	01/03/14	1
1,2-Dichloroethane	107-06-2	99	0.200	0.810	< 0.20	< 0.81	TO-15	01/03/14	1
1,1-Dichloroethane	75-34-3	98	0.200	0.800	< 0.20	< 0.80	TO-15	01/03/14	1
1,1-Dichloroethene	75-35-4	96.9	0.200	0.790	< 0.20	< 0.79	TO-15	01/03/14	1
cis-1,2-Dichloroethene	156-59-2	96.9	0.200	0.790	< 0.20	< 0.79	TO-15	01/03/14	1
trans-1,2-Dichloroethene	156-60-5	96.9	0.200	0.790	< 0.20	< 0.79	TO-15	01/03/14	1
1,2-Dichloropropane	78-87-5	113	0.200	0.920	< 0.20	< 0.92	TO-15	01/03/14	1
cis-1,3-Dichloropropene	10061-01-5	111	0.200	0.910	< 0.20	< 0.91	TO-15	01/03/14	1
trans-1,3-Dichloropropene	10061-02-6	111	0.200	0.910	< 0.20	< 0.91	TO-15	01/03/14	1
1,4-Dioxane	123-91-1	88.1	0.200	0.720	< 0.20	< 0.72	TO-15	01/03/14	1
Ethanol	64-17-5	46.1	2.52	4.80	28.	53.	TO-15	01/04/14	4
Ethylbenzene	100-41-4	106	0.200	0.870	5.2	23.	TO-15	01/03/14	1
4-Ethyltoluene	622-96-8	120	0.200	0.980	< 0.20	< 0.98	TO-15	01/03/14	1
Trichlorofluoromethane	75-69-4	137.4	0.200	1.10	< 0.20	< 1.1	TO-15	01/03/14	1
Dichlorodifluoromethane	75-71-8	120.92	0.200	0.990	0.34	1.7	TO-15	01/03/14	1
1,1,2-Trichlorotrifluoroethane	76-13-1	187.4	0.200	1.50	< 0.20	< 1.5	TO-15	01/03/14	1
1,2-Dichlorotetrafluoroethane	76-14-2	171	0.200	1.40	< 0.20	< 1.4	TO-15	01/03/14	1
Heptane	142-82-5	100	0.200	0.820	0.29	1.2	TO-15	01/03/14	1
Hexachloro-1,3-butadiene	87-68-3	261	0.630	6.70	< 0.63	< 6.7	TO-15	01/03/14	1
n-Hexane	110-54-3	86.2	0.200	0.710	< 0.20	< 0.71	TO-15	01/03/14	1
Isopropylbenzene	98-82-8	120.2	0.200	0.980	0.22	1.1	TO-15	01/03/14	1
Methylene Chloride	75-09-2	84.9	0.200	0.690	< 0.20	< 0.69	TO-15	01/03/14	1
Methyl Butyl Ketone	591-78-6	100	1.25	5.10	< 1.3	< 5.1	TO-15	01/03/14	1

RDL1 = ppbv , RDL2 = ug/m3

Note:

Units are based on (STP) - Standard Temperature and Pressure

The reported analytical results relate only to the sample submitted.

This report shall not be reproduced, except in full, without the written approval from ESC.

Reported: 01/06/14 11:06 Printed: 01/06/14 12:15



12065 Lebanon Rd.
 Mt. Juliet, TN 37122
 (615) 758-5858
 1-800-767-5859
 Fax (615) 758-5859

Tax I.D. 62-0814289

Est. 1970

REPORT OF ANALYSIS

Jon Hinkel
 MSA Professional Services
 301 West First St. Ste 408
 Duluth, MN 55802

January 06, 2014

Date Received : December 30, 2013
 Description : Junction F-N-F
 Sample ID : SUB-SLAB AIR SAMPLE
 Collected By : Jon Hinkel
 Collection Date : 12/26/13 08:52

ESC Sample # : L676046-03
 Site ID :
 Project # : R-00625001

Parameter	Cas#	Mol Wght	RDL1	RDL2	ppbv	ug/m3	Method	Date	Dil.
2-Butanone (MEK)	78-93-3	72.1	1.25	3.70	3.0	8.8	TO-15	01/03/14	1
4-Methyl-2-pentanone (MIBK)	108-10-1	100.1	1.25	5.10	< 1.3	< 5.1	TO-15	01/03/14	1
Methyl methacrylate	80-62-6	100.12	0.200	0.820	< 0.20	< 0.82	TO-15	01/03/14	1
MTBE	1634-04-4	88.1	0.200	0.720	< 0.20	< 0.72	TO-15	01/03/14	1
Naphthalene	91-20-3	128	0.630	3.30	< 0.63	< 3.3	TO-15	01/03/14	1
2-Propanol	67-63-0	60.1	1.25	3.10	18.	44.	TO-15	01/03/14	1
Propene	115-07-1	42.1	0.400	0.690	< 0.40	< 0.69	TO-15	01/03/14	1
Styrene	100-42-5	104	0.200	0.850	0.60	2.6	TO-15	01/03/14	1
1,1,2,2-Tetrachloroethane	79-34-5	168	0.200	1.40	< 0.20	< 1.4	TO-15	01/03/14	1
Tetrachloroethylene	127-18-4	166	0.200	1.40	0.22	1.5	TO-15	01/03/14	1
Tetrahydrofuran	109-99-9	72.1	0.200	0.590	10.	29.	TO-15	01/03/14	1
Toluene	108-88-3	92.1	0.200	0.750	14.	53.	TO-15	01/03/14	1
1,2,4-Trichlorobenzene	120-82-1	181	0.630	4.70	< 0.63	< 4.7	TO-15	01/03/14	1
1,1,1-Trichloroethane	71-55-6	133	0.200	1.10	< 0.20	< 1.1	TO-15	01/03/14	1
1,1,2-Trichloroethane	79-00-5	133	0.200	1.10	< 0.20	< 1.1	TO-15	01/03/14	1
Trichloroethylene	79-01-6	131	0.200	1.10	< 0.20	< 1.1	TO-15	01/03/14	1
1,2,4-Trimethylbenzene	95-63-6	120	0.200	0.980	0.40	2.0	TO-15	01/03/14	1
1,3,5-Trimethylbenzene	108-67-8	120	0.200	0.980	< 0.20	< 0.98	TO-15	01/03/14	1
2,2,4-Trimethylpentane	540-84-1	114.22	0.200	0.930	< 0.20	< 0.93	TO-15	01/03/14	1
Vinyl chloride	75-01-4	62.5	0.200	0.510	< 0.20	< 0.51	TO-15	01/03/14	1
Vinyl Bromide	593-60-2	106.95	0.200	0.870	< 0.20	< 0.87	TO-15	01/03/14	1
Vinyl acetate	108-05-4	86.1	0.200	0.700	< 0.20	< 0.70	TO-15	01/03/14	1
m&p-Xylene	1330-20-7	106	0.400	1.70	6.7	29.	TO-15	01/03/14	1
o-Xylene	95-47-6	106	0.200	0.870	1.8	7.8	TO-15	01/03/14	1
TPH (GC/MS) Low Fraction	8006-61-9	101	50.0	210.	110	450	TO-15	01/03/14	1
1,4-Bromofluorobenzene	460-00-4				92.5	% Rec.	TO-15	01/03/14	1

RDL1 = ppbv , RDL2 = ug/m3

Note:

Units are based on (STP) - Standard Temperature and Pressure

The reported analytical results relate only to the sample submitted.

This report shall not be reproduced, except in full, without the written approval from ESC.

Reported: 01/06/14 11:06 Printed: 01/06/14 12:15



YOUR LAB OF CHOICE

MSA Professional Services
Jon Hinkel
301 West First St. Ste 408

Duluth, MN 55802

Quality Assurance Report
Level II

L676046

12065 Lebanon Rd.
Mt. Juliet, TN 37122
(615) 758-5858
1-800-767-5859
Fax (615) 758-5859

Tax I.D. 62-0814289

Est. 1970

January 06, 2014

Analyte	Result	Laboratory Blank		Limit	Batch	Date Analyzed
		Units	% Rec			
1,1,1-Trichloroethane	< .2	ppb			WG699990	01/02/14 10:43
1,1,2,2-Tetrachloroethane	< .2	ppb			WG699990	01/02/14 10:43
1,1,2-Trichloroethane	< .2	ppb			WG699990	01/02/14 10:43
1,1,2-Trichlorotrifluoroethane	< .2	ppb			WG699990	01/02/14 10:43
1,1-Dichloroethane	< .2	ppb			WG699990	01/02/14 10:43
1,1-Dichloroethene	< .2	ppb			WG699990	01/02/14 10:43
1,2,4-Trichlorobenzene	< .63	ppb			WG699990	01/02/14 10:43
1,2,4-Trimethylbenzene	< .2	ppb			WG699990	01/02/14 10:43
1,2-Dibromoethane	< .2	ppb			WG699990	01/02/14 10:43
1,2-Dichlorobenzene	< .2	ppb			WG699990	01/02/14 10:43
1,2-Dichloroethane	< .2	ppb			WG699990	01/02/14 10:43
1,2-Dichloropropane	< .2	ppb			WG699990	01/02/14 10:43
1,2-Dichlorotetrafluoroethane	< .2	ppb			WG699990	01/02/14 10:43
1,3,5-Trimethylbenzene	< .2	ppb			WG699990	01/02/14 10:43
1,3-Butadiene	< 2	ppb			WG699990	01/02/14 10:43
1,3-Dichlorobenzene	< .2	ppb			WG699990	01/02/14 10:43
1,4-Dichlorobenzene	< .2	ppb			WG699990	01/02/14 10:43
1,4-Dioxane	< .2	ppb			WG699990	01/02/14 10:43
2,2,4-Trimethylpentane	< .2	ppb			WG699990	01/02/14 10:43
2-Butanone (MEK)	< 1.25	ppb			WG699990	01/02/14 10:43
2-Chlorotoluene	< .2	ppb			WG699990	01/02/14 10:43
2-Propanol	< 1.25	ppb			WG699990	01/02/14 10:43
4-Ethyltoluene	< .2	ppb			WG699990	01/02/14 10:43
4-Methyl-2-pentanone (MIBK)	< 1.25	ppb			WG699990	01/02/14 10:43
Acetone	< 1.25	ppb			WG699990	01/02/14 10:43
Allyl chloride	< .2	ppb			WG699990	01/02/14 10:43
Benzene	< .2	ppb			WG699990	01/02/14 10:43
Benzyl Chloride	< .2	ppb			WG699990	01/02/14 10:43
Bromodichloromethane	< .2	ppb			WG699990	01/02/14 10:43
Bromoform	< .6	ppb			WG699990	01/02/14 10:43
Bromomethane	< .2	ppb			WG699990	01/02/14 10:43
Carbon disulfide	< .2	ppb			WG699990	01/02/14 10:43
Carbon tetrachloride	< .2	ppb			WG699990	01/02/14 10:43
Chlorobenzene	< .2	ppb			WG699990	01/02/14 10:43
Dibromochloromethane	< .2	ppb			WG699990	01/02/14 10:43
Chloroethane	< .2	ppb			WG699990	01/02/14 10:43
Chloroform	< .2	ppb			WG699990	01/02/14 10:43
Chloromethane	< .2	ppb			WG699990	01/02/14 10:43
cis-1,2-Dichloroethene	< .2	ppb			WG699990	01/02/14 10:43
cis-1,3-Dichloropropene	< .2	ppb			WG699990	01/02/14 10:43
Cyclohexane	< .2	ppb			WG699990	01/02/14 10:43
Dichlorodifluoromethane	< .2	ppb			WG699990	01/02/14 10:43
Ethanol	< .63	ppb			WG699990	01/02/14 10:43
Ethylbenzene	< .2	ppb			WG699990	01/02/14 10:43
Heptane	< .2	ppb			WG699990	01/02/14 10:43
Hexachloro-1,3-butadiene	< .63	ppb			WG699990	01/02/14 10:43
Isopropylbenzene	< .2	ppb			WG699990	01/02/14 10:43
m&p-Xylene	< .4	ppb			WG699990	01/02/14 10:43
Methyl Butyl Ketone	< 1.25	ppb			WG699990	01/02/14 10:43
Methyl methacrylate	< .2	ppb			WG699990	01/02/14 10:43
MTBE	< .2	ppb			WG699990	01/02/14 10:43
Methylene Chloride	< .2	ppb			WG699990	01/02/14 10:43
n-Hexane	< .2	ppb			WG699990	01/02/14 10:43
Naphthalene	< .63	ppb			WG699990	01/02/14 10:43
o-Xylene	< .2	ppb			WG699990	01/02/14 10:43
Propene	< .4	ppb			WG699990	01/02/14 10:43
Styrene	< .2	ppb			WG699990	01/02/14 10:43
Tetrachloroethylene	< .2	ppb			WG699990	01/02/14 10:43
Tetrahydrofuran	< .2	ppb			WG699990	01/02/14 10:43

* Performance of this Analyte is outside of established criteria.

For additional information, please see Attachment A 'List of Analytes with QC Qualifiers.'



YOUR LAB OF CHOICE

MSA Professional Services
Jon Hinkel
301 West First St. Ste 408

Duluth, MN 55802

Quality Assurance Report
Level II

L676046

12065 Lebanon Rd.
Mt. Juliet, TN 37122
(615) 758-5858
1-800-767-5859
Fax (615) 758-5859

Tax I.D. 62-0814289

Est. 1970

January 06, 2014

Analyte	Result	Laboratory Blank		Limit	Batch	Date Analyzed
		Units	% Rec			
Toluene	< .2	ppb			WG699990	01/02/14 10:43
TPH (GC/MS) Low Fraction	< 50	ppb			WG699990	01/02/14 10:43
trans-1,2-Dichloroethene	< .2	ppb			WG699990	01/02/14 10:43
trans-1,3-Dichloropropene	< .2	ppb			WG699990	01/02/14 10:43
Trichloroethylene	< .2	ppb			WG699990	01/02/14 10:43
Trichlorofluoromethane	< .2	ppb			WG699990	01/02/14 10:43
Vinyl acetate	< .2	ppb			WG699990	01/02/14 10:43
Vinyl Bromide	< .2	ppb			WG699990	01/02/14 10:43
Vinyl chloride	< .2	ppb			WG699990	01/02/14 10:43
1,4-Bromofluorobenzene		% Rec.	90.20	60-140	WG699990	01/02/14 10:43
Ethanol	< .63	ppb			WG700175	01/03/14 13:17
1,4-Bromofluorobenzene		% Rec.	90.80	60-140	WG700175	01/03/14 13:17

Analyte	Units	Laboratory Control Sample		% Rec	Limit	Batch
		Known Val	Result			
1,1,1-Trichloroethane	ppb	3.75	3.37	90.0	70-130	WG699990
1,1,2,2-Tetrachloroethane	ppb	3.75	4.22	113.	70-130	WG699990
1,1,2-Trichloroethane	ppb	3.75	3.83	102.	70-130	WG699990
1,1,2-Trichlorotrifluoroethane	ppb	3.75	3.55	94.6	70-130	WG699990
1,1-Dichloroethane	ppb	3.75	3.72	99.3	70-130	WG699990
1,1-Dichloroethene	ppb	3.75	3.73	99.4	70-130	WG699990
1,2,4-Trichlorobenzene	ppb	3.75	4.37	116.	59.7-155	WG699990
1,2,4-Trimethylbenzene	ppb	3.75	4.02	107.	70-130	WG699990
1,2-Dibromoethane	ppb	3.75	3.80	101.	70-130	WG699990
1,2-Dichlorobenzene	ppb	3.75	4.03	107.	70-130	WG699990
1,2-Dichloroethane	ppb	3.75	3.75	99.9	70-130	WG699990
1,2-Dichloropropane	ppb	3.75	4.07	108.	70-130	WG699990
1,2-Dichlorotetrafluoroethane	ppb	3.75	3.65	97.4	70-130	WG699990
1,3,5-Trimethylbenzene	ppb	3.75	3.95	105.	70-130	WG699990
1,3-Butadiene	ppb	3.75	3.86	103.	70-130	WG699990
1,3-Dichlorobenzene	ppb	3.75	3.95	105.	70-130	WG699990
1,4-Dichlorobenzene	ppb	3.75	3.96	106.	70-130	WG699990
1,4-Dioxane	ppb	3.75	4.36	116.	70-130	WG699990
2,2,4-Trimethylpentane	ppb	3.75	3.81	102.	70-130	WG699990
2-Butanone (MEK)	ppb	3.75	3.98	106.	70-130	WG699990
2-Chlorotoluene	ppb	3.75	3.93	105.	70-130	WG699990
2-Propanol	ppb	3.75	4.07	109.	62.2-137	WG699990
4-Ethyltoluene	ppb	3.75	3.99	106.	70-130	WG699990
4-Methyl-2-pentanone (MIBK)	ppb	3.75	4.40	117.	51.3-144	WG699990
Acetone	ppb	3.75	3.75	100.	70-130	WG699990
Allyl chloride	ppb	3.75	3.92	105.	70-130	WG699990
Benzene	ppb	3.75	3.89	104.	70-130	WG699990
Benzyl Chloride	ppb	3.75	4.52	121.	70-130	WG699990
Bromodichloromethane	ppb	3.75	3.76	100.	70-130	WG699990
Bromoform	ppb	3.75	3.88	103.	70-130	WG699990
Bromomethane	ppb	3.75	3.72	99.3	70-130	WG699990
Carbon disulfide	ppb	3.75	3.74	99.9	70-130	WG699990
Carbon tetrachloride	ppb	3.75	3.30	87.9	70-130	WG699990
Chlorobenzene	ppb	3.75	3.77	101.	70-130	WG699990
Dibromochloromethane	ppb	3.75	3.71	99.0	70-130	WG699990
Chloroethane	ppb	3.75	4.01	107.	70-130	WG699990
Chloroform	ppb	3.75	3.58	95.5	70-130	WG699990
Chloromethane	ppb	3.75	4.00	107.	70-130	WG699990
cis-1,2-Dichloroethene	ppb	3.75	3.66	97.7	70-130	WG699990
cis-1,3-Dichloropropene	ppb	3.75	3.94	105.	70-130	WG699990
Cyclohexane	ppb	3.75	3.70	98.6	70-130	WG699990

* Performance of this Analyte is outside of established criteria.

For additional information, please see Attachment A 'List of Analytes with QC Qualifiers.'



YOUR LAB OF CHOICE

MSA Professional Services
 Jon Hinkel
 301 West First St. Ste 408
 Duluth, MN 55802

Quality Assurance Report
 Level II

L676046

12065 Lebanon Rd.
 Mt. Juliet, TN 37122
 (615) 758-5858
 1-800-767-5859
 Fax (615) 758-5859

Tax I.D. 62-0814289

Est. 1970

January 06, 2014

Analyte	Units	Laboratory Control Sample		% Rec	Limit	Batch
		Known Val	Result			
Dichlorodifluoromethane	ppb	3.75	3.64	96.9	70-130	WG699990
Ethanol	ppb	3.75	4.52	121.	52.6-145	WG699990
Ethylbenzene	ppb	3.75	3.91	104.	70-130	WG699990
Heptane	ppb	3.75	4.16	111.	70-130	WG699990
Hexachloro-1,3-butadiene	ppb	3.75	4.21	112.	55.7-144	WG699990
Isopropylbenzene	ppb	3.75	3.94	105.	70-130	WG699990
m&p-Xylene	ppb	7.5	7.56	101.	70-130	WG699990
Methyl Butyl Ketone	ppb	3.75	4.61	123.	36.5-155	WG699990
Methyl methacrylate	ppb	3.75	3.96	106.	70-130	WG699990
MTBE	ppb	3.75	3.58	95.5	70-130	WG699990
Methylene Chloride	ppb	3.75	3.64	97.1	70-130	WG699990
n-Hexane	ppb	3.75	3.92	104.	70-130	WG699990
Naphthalene	ppb	3.75	4.51	120.	53.4-158	WG699990
o-Xylene	ppb	3.75	3.96	106.	70-130	WG699990
Propene	ppb	3.75	4.00	107.	70-130	WG699990
Styrene	ppb	3.75	4.13	110.	70-130	WG699990
Tetrachloroethylene	ppb	3.75	3.59	95.7	70-130	WG699990
Tetrahydrofuran	ppb	3.75	4.00	107.	70-130	WG699990
Toluene	ppb	3.75	3.85	103.	70-130	WG699990
TPH (GC/MS) Low Fraction	ppb	150	158.	105.	70-130	WG699990
trans-1,2-Dichloroethene	ppb	3.75	3.69	98.4	70-130	WG699990
trans-1,3-Dichloropropene	ppb	3.75	3.90	104.	70-130	WG699990
Trichloroethylene	ppb	3.75	3.78	101.	70-130	WG699990
Trichlorofluoromethane	ppb	3.75	3.42	91.3	70-130	WG699990
Vinyl acetate	ppb	3.75	4.09	109.	70-130	WG699990
Vinyl Bromide	ppb	3.75	3.80	101.	70-130	WG699990
Vinyl chloride	ppb	3.75	3.96	106.	70-130	WG699990
1,4-Bromofluorobenzene				95.30	60-140	WG699990
Ethanol	ppb	3.75	4.38	117.	52.6-145	WG700175
1,4-Bromofluorobenzene				94.40	60-140	WG700175

Analyte	Units	Laboratory Control Sample Duplicate			Limit	RPD	Limit	Batch
		Result	Ref	%Rec				
1,1,1-Trichloroethane	ppb	3.35	3.37	89.0	70-130	0.760	25	WG699990
1,1,2,2-Tetrachloroethane	ppb	4.28	4.22	114.	70-130	1.40	25	WG699990
1,1,2-Trichloroethane	ppb	3.86	3.83	103.	70-130	0.810	25	WG699990
1,1,2-Trichlorotrifluoroethane	ppb	3.56	3.55	95.0	70-130	0.400	25	WG699990
1,1-Dichloroethane	ppb	3.76	3.72	100.	70-130	1.03	25	WG699990
1,1-Dichloroethene	ppb	3.68	3.73	98.0	70-130	1.21	25	WG699990
1,2,4-Trichlorobenzene	ppb	4.44	4.37	118.	59.7-155	1.63	25	WG699990
1,2,4-Trimethylbenzene	ppb	4.11	4.02	110.	70-130	2.16	25	WG699990
1,2-Dibromoethane	ppb	3.80	3.80	101.	70-130	0.0500	25	WG699990
1,2-Dichlorobenzene	ppb	4.09	4.03	109.	70-130	1.45	25	WG699990
1,2-Dichloroethane	ppb	3.70	3.75	99.0	70-130	1.32	25	WG699990
1,2-Dichloropropane	ppb	4.08	4.07	109.	70-130	0.170	25	WG699990
1,2-Dichlorotetrafluoroethane	ppb	3.66	3.65	98.0	70-130	0.150	25	WG699990
1,3,5-Trimethylbenzene	ppb	4.01	3.95	107.	70-130	1.54	25	WG699990
1,3-Butadiene	ppb	3.89	3.86	104.	70-130	0.820	25	WG699990
1,3-Dichlorobenzene	ppb	4.03	3.95	107.	70-130	1.90	25	WG699990
1,4-Dichlorobenzene	ppb	4.04	3.96	108.	70-130	1.99	25	WG699990
1,4-Dioxane	ppb	4.30	4.36	115.	70-130	1.29	25	WG699990
2,2,4-Trimethylpentane	ppb	3.79	3.81	101.	70-130	0.370	25	WG699990
2-Butanone (MEK)	ppb	4.10	3.98	109.	70-130	2.85	25	WG699990
2-Chlorotoluene	ppb	3.99	3.93	106.	70-130	1.55	25	WG699990
2-Propanol	ppb	4.03	4.07	107.	62.2-137	0.990	25	WG699990
4-Ethyltoluene	ppb	4.06	3.99	108.	70-130	1.64	25	WG699990

* Performance of this Analyte is outside of established criteria.

For additional information, please see Attachment A 'List of Analytes with QC Qualifiers.'



YOUR LAB OF CHOICE

MSA Professional Services
Jon Hinkel
301 West First St. Ste 408

Duluth, MN 55802

Quality Assurance Report
Level II

L676046

12065 Lebanon Rd.
Mt. Juliet, TN 37122
(615) 758-5858
1-800-767-5859
Fax (615) 758-5859

Tax I.D. 62-0814289

Est. 1970

January 06, 2014

Analyte	Units	Laboratory Control Sample Duplicate			Limit	RPD	Limit	Batch
		Result	Ref	%Rec				
4-Methyl-2-pentanone (MIBK)	ppb	4.40	4.40	117.	51.3-144	0.190	25	WG699990
Acetone	ppb	3.78	3.75	101.	70-130	0.770	25	WG699990
Allyl chloride	ppb	3.98	3.92	106.	70-130	1.56	25	WG699990
Benzene	ppb	3.91	3.89	104.	70-130	0.480	25	WG699990
Benzyl Chloride	ppb	4.61	4.52	123.	70-130	1.83	25	WG699990
Bromodichloromethane	ppb	3.76	3.76	100.	70-130	0.0300	25	WG699990
Bromoform	ppb	3.97	3.88	106.	70-130	2.45	25	WG699990
Bromomethane	ppb	3.74	3.72	100.	70-130	0.580	25	WG699990
Carbon disulfide	ppb	3.73	3.74	99.0	70-130	0.480	25	WG699990
Carbon tetrachloride	ppb	3.34	3.30	89.0	70-130	1.27	25	WG699990
Chlorobenzene	ppb	3.78	3.77	101.	70-130	0.160	25	WG699990
Dibromochloromethane	ppb	3.69	3.71	98.0	70-130	0.530	25	WG699990
Chloroethane	ppb	4.03	4.01	108.	70-130	0.640	25	WG699990
Chloroform	ppb	3.54	3.58	94.0	70-130	1.25	25	WG699990
Chloromethane	ppb	3.98	4.00	106.	70-130	0.500	25	WG699990
cis-1,2-Dichloroethene	ppb	3.69	3.66	98.0	70-130	0.700	25	WG699990
cis-1,3-Dichloropropene	ppb	3.95	3.94	105.	70-130	0.260	25	WG699990
Cyclohexane	ppb	3.69	3.70	98.0	70-130	0.130	25	WG699990
Dichlorodifluoromethane	ppb	3.62	3.64	96.0	70-130	0.560	25	WG699990
Ethanol	ppb	4.37	4.52	116.	52.6-145	3.56	25	WG699990
Ethylbenzene	ppb	3.96	3.91	106.	70-130	1.47	25	WG699990
Heptane	ppb	4.17	4.16	111.	70-130	0.310	25	WG699990
Hexachloro-1,3-butadiene	ppb	4.26	4.21	113.	55.7-144	1.18	25	WG699990
Isopropylbenzene	ppb	4.01	3.94	107.	70-130	1.72	25	WG699990
m&p-Xylene	ppb	7.69	7.56	102.	70-130	1.66	25	WG699990
Methyl Butyl Ketone	ppb	4.58	4.61	122.	36.5-155	0.730	25	WG699990
Methyl methacrylate	ppb	4.00	3.96	106.	70-130	0.970	25	WG699990
MTBE	ppb	3.53	3.58	94.0	70-130	1.32	25	WG699990
Methylene Chloride	ppb	3.68	3.64	98.0	70-130	1.17	25	WG699990
n-Hexane	ppb	3.93	3.92	105.	70-130	0.240	25	WG699990
Naphthalene	ppb	4.57	4.51	122.	53.4-158	1.17	25	WG699990
o-Xylene	ppb	3.97	3.96	106.	70-130	0.130	25	WG699990
Propene	ppb	3.93	4.00	105.	70-130	1.74	25	WG699990
Styrene	ppb	4.17	4.13	111.	70-130	0.920	25	WG699990
Tetrachloroethylene	ppb	3.58	3.59	95.0	70-130	0.250	25	WG699990
Tetrahydrofuran	ppb	4.02	4.00	107.	70-130	0.280	25	WG699990
Toluene	ppb	3.84	3.85	102.	70-130	0.340	25	WG699990
TPH (GC/MS) Low Fraction	ppb	160.	158.	107.	70-130	1.64	25	WG699990
trans-1,2-Dichloroethene	ppb	3.70	3.69	99.0	70-130	0.330	25	WG699990
trans-1,3-Dichloropropene	ppb	3.94	3.90	105.	70-130	0.890	25	WG699990
Trichloroethylene	ppb	3.80	3.78	101.	70-130	0.560	25	WG699990
Trichlorofluoromethane	ppb	3.45	3.42	92.0	70-130	0.750	25	WG699990
Vinyl acetate	ppb	4.17	4.09	111.	70-130	1.90	25	WG699990
Vinyl Bromide	ppb	3.77	3.80	100.	70-130	0.660	25	WG699990
Vinyl chloride	ppb	3.98	3.96	106.	70-130	0.530	25	WG699990
1,4-Bromofluorobenzene				94.70	60-140			WG699990
Ethanol	ppb	4.27	4.38	114.	52.6-145	2.59	25	WG700175
1,4-Bromofluorobenzene				94.00	60-140			WG700175

Batch number /Run number / Sample number cross reference

WG699990: R2873463: L676046-01 02 03
WG700175: R2873805: L676046-02 03

* * Calculations are performed prior to rounding of reported values.
* Performance of this Analyte is outside of established criteria.
For additional information, please see Attachment A 'List of Analytes with QC Qualifiers.'



YOUR LAB OF CHOICE

MSA Professional Services
Jon Hinkel
301 West First St. Ste 408

Duluth, MN 55802

Quality Assurance Report
Level II

L676046

12065 Lebanon Rd.
Mt. Juliet, TN 37122
(615) 758-5858
1-800-767-5859
Fax (615) 758-5859

Tax I.D. 62-0814289

Est. 1970

January 06, 2014

The data package includes a summary of the analytic results of the quality control samples required by the SW-846 or CWA methods. The quality control samples include a method blank, a laboratory control sample, and the matrix spike/matrix spike duplicate analysis. If a target parameter is outside the method limits, every sample that is effected is flagged with the appropriate qualifier in Appendix B of the analytic report.

Method Blank - an aliquot of reagent water carried through the entire analytic process. The method blank results indicate if any possible contamination exposure during the sample handling, digestion or extraction process, and analysis. Concentrations of target analytes above the reporting limit in the method blank are qualified with the "B" qualifier.

Laboratory Control Sample - is a sample of known concentration that is carried through the digestion/extraction and analysis process. The percent recovery, expressed as a percentage of the theoretical concentration, has statistical control limits indicating that the analytic process is "in control". If a target analyte is outside the control limits for the laboratory control sample or any other control sample, the parameter is flagged with a "J4" qualifier for all effected samples.

Matrix Spike and Matrix Spike Duplicate - is two aliquots of an environmental sample that is spiked with known concentrations of target analytes. The percent recovery of the target analytes also has statistical control limits. If any recoveries that are outside the method control limits, the sample that was selected for matrix spike/matrix spike duplicate analysis is flagged with either a "J5" or a "J6". The relative percent difference (%RPD) between the matrix spike and the matrix spike duplicate recoveries is all calculated. If the RPD is above the method limit, the effected samples are flagged with a "J3" qualifier.

DULUTH CITY DIRECTORY EXCERPTS
ST. LOUIS COUNTY ASSESSOR RECORD



LOCAL AND LONG DISTANCE MOVING OF HOUSEHOLD GOODS SECURITY STORAGE CO.

PALLET VAULT STORAGE

106 LAKE AVE. SOUTH

LOCAL TRUCKING

PHONE RAndolph 2-7428

Consult
the
**CLASSIFIED
LISTS
of the
DIRECTORY**

If You
Would Find
What You
Wish to
Buy

**PARK
ELECTRIC
CO. INC.**

ELECTRIC
CONTRACTORS

COMMERCIAL
INDUSTRIAL
RESIDENTIAL

ESTIMATES
WITH NO
OBLIGATION
PROMPT SERVICE

522 E.
4th St.

Tel. RAndolph
2-5866

After Hrs.
RAndolph 2-8906
RAndolph 4-6662

LICENSED
BONDED

MICHIGAN W—Contd
3917ΔMyhrman John M
⊙
ΔFlack John
3920ΔCraven Jas L ⊙
3921ΔMyhrman Anna K
Mrs ⊙
ΔErickson Ethel F
3922 Ridgely Wm E ⊙
3927ΔHomewood Harry B
⊙
**40th av inter-
sects**
**41st av inter-
sects**
4113 Peterson Alex E
ΔJanczak Frank P
4117ΔAnderson Gunvor A
Mrs ⊙
4118ΔGauthier Dale R ⊙
4121ΔPeterson Ragna M
Mrs ⊙
Tiseth Mary Mrs
4122ΔChallstrom Nell
Mrs ⊙
4126ΔJohnson Roy A ⊙
**42d av inter-
sects**
4206ΔSchublom Jacob W
4210ΔIsaacson Harry O ⊙
4215ΔNelson Albert E ⊙
4220 Vacant
4222ΔLuoma Wayne J ⊙
4226 No return
4228ΔCuff Ralph E ⊙
ΔCarlson Chas A

**43d av inter-
sects**
**44th av inter-
sects**
4407 Babcock Irene Mrs
⊙
**45th av inter-
sects**
4512ΔHasforth Emil A ⊙
ΔHasforth Upholstery
Shop
4524ΔNorlin Emma O
Mrs
ΔNyquist Lloyd G ⊙
**46th av inter-
sects**
4601ΔDulinski Chas J ⊙
4605ΔPelander Henrietta
Mrs ⊙
4609ΔGradine Edwin A ⊙
4610ΔSwanbum Lennette
H Mrs ⊙
ΔLee Paul J ⊙
4611 Fougner Jeanette
4613ΔAsp Albert A
ΔTolley Donald D
4617ΔGundry Herbert D
⊙
Tjosvold Gordon W
4618ΔBlack Thos A ⊙
4621 Anderson Albert A
⊙
4622ΔMickelson Fred ⊙
4623ΔHogberg Robt
4625ΔFarquharson Alec
⊙
4626ΔJohnson Arth F ⊙
4631ΔBerggren Wilbert
M ⊙
4632ΔZhorela Albert G ⊙
**47th av inter-
sects**
4701ΔSeehus Victor R ⊙
4705ΔReite Melvin H ⊙
4708ΔAnderson Lillian
B Mrs ⊙
4709ΔSampson Hilda M
Mrs ⊙

4711ΔJohnson Adolph E ⊙
4712ΔJohnson Eric E ⊙
4714ΔTridgell Reginald
H ⊙
4715ΔMichaels Clayton
E ⊙
4716ΔOlson Walton C ⊙
4725ΔEdstrom Selem R
⊙
4729ΔGustafson Aug ⊙
ΔFant Lisa Mrs
ΔGranlund John A
4731ΔBritton Claire Mrs
ΔOlson David C
**48th av inter-
sects**
4801ΔAronson Aug ⊙
ΔJudy Skillman F
4803ΔNewell Robt G
ΔEklund Matt L ⊙
4806 Danielson Alma S
Mrs ⊙
ΔJohnson Paul E
**49th av inter-
sects**

**MICHIGAN AV—From
Carlton north to Well-
ington, 2 west of
Grand Forks av and
29th av W**
Zone 6
166ΔLundstrom Elvin S
⊙
170ΔRadek Jessie Mrs
⊙
174ΔVieau Walter R ⊙

**Gilbert inter-
sects**
206ΔSevertson Virginia
F ⊙
**Chestnut
intersects
3d intersects**
19
**Vernon inter-
sects**
315ΔLangseth Christ P
⊙
317ΔBooth Clifford J
⊙
319ΔPrice Robt J ⊙

**Restormel inter-
sects**
351ΔLarson Sargent W ⊙
352ΔAbrahamson Clyde
⊙
416ΔTessier Bertha J
Mrs ⊙
417 Watten Ivar ⊙
ΔLarson Oscar L
418ΔNordstrom Augusta
Mrs ⊙
Nordstrom Stanley
R
419ΔHanson Henry ⊙
ΔOlson Ralph R
421ΔErickson Cecilia J
Mrs ⊙
423ΔTranvik Isaac ⊙
424ΔCarlson Emma K
Mrs ⊙
**Devonshire inter-
sects**
510ΔMcDonnell Flora-
belle Mrs ⊙
**Exeter inter-
sects**
**Wicklow inter-
sects**
**Wellington inter-
sects**

**MIDDLE—From Everett
north to north line of
Homeland Div, 1 east
of Morningside av
Zone 3**

**MIDDLE RD—From Ken-
wood av west to Howard-
Gnesen rd, 1 north of
South rd
Zone 11**

1407ΔLeGarde Gerald L
1415ΔLeppala Johan F ⊙
1420ΔHanson Orville H ⊙
1425ΔCeaglske Alvin B
1548 Vacant
1608ΔSalo Elina Mrs ⊙
1626ΔKozloski Felix A ⊙
1803ΔStiles Frank L ⊙
1809ΔBlais Ralph P ⊙

**MIDWAY AV—From Or-
chard to Lawn, 1 east
of Boundary (Bay View
Gardens)
Zone 10**

**MIDWAY AV—From St-
Marie north to Arrow-
head rd, 4 west of
Woodland av
Zone 11**

**MIDWAY AV—From Nor-
ton north to Lawn**
301ΔJohnston Robt G ⊙
303ΔAhala Henry J ⊙
307ΔHagberg Cecelia
Mrs ⊙
309ΔRinker Edna M Mrs
⊙
312ΔErickson Alfred R ⊙
313ΔCheney Edwin D ⊙
314ΔShovein Edw T ⊙

**MIDWAY PK—A settle-
ment on Ugstadt rd, 1
mile west of Proctor
Zone 10**
(For names see
Proctor)

**MILES AV (FDL)—From
StLouis River west
to limits
Zone 9**

**MILFORD—From S 70th
av W, west to 72d av,
11th south of Main
(WD)
Zone 7**

**MILL—From Terminal
av east to Bessemer
av, 2 north of Anchor
(Steel Plant Div)
Zone 8**
10th intersects
11th intersects

**MILLER TRUNK HIGH-
WAY (Also known as
Central Entrance)—
From N 6th av E and
9th, west and south-
west to Mesaba av and
10th, thence north
and west to Trinity rd
Zone 11**

502ΔCarl Edw ⊙
1301 Fourteenth Reser-
voir Water Dept
ΔHighland Supper
Club
1723ΔCozy Corner
Grocery
1725ΔHorak Jas J ⊙
2000ΔSpindler Herb Co
trailer
2130ΔBergson Herbert W
2521ΔDenno Wm E ⊙
2765ΔSirois Edw T ⊙
ΔSunrise Motel
2767ΔO'Leary Susan Mrs
⊙

2793ΔSobaledwsk Max J
2809ΔLarson Fritz Weld-
ing & Mach Wks
ΔLarson Fritz ⊙
2925ΔTwining Jane
2950ΔHerbs Sports &
Hobby Center
2954ΔSkyline Bowling
Lanes
ΔSkyline Coffee Shop
restr
2959ΔOlder Constr Co
contrs
ΔBarndt Steph
ΔAnduaga Arias
Roger F
ΔWilliams David

2967ΔBill's Cities Service
gas sta
2990ΔAir View Heating &
Air Conditioning
sht mtl wks
2992ΔZimm A L ⊙
3120ΔAirliner Motel
3231ΔBenson's Store gro
ΔBenson Robt E ⊙
Baski Drilling Inc
3242ΔAhern Mobile Homes
trailers
3261ΔCarlson Bertil C ⊙
3270ΔFoley's Trailer Pk
ΔFoley Geo A
ΔRindal Gerald O ⊙
3375ΔSkarp Edw E
3420ΔGallagher's restr
3519ΔArrowhead Oil Co
ΔOettel Robt W

3693ΔJunction Mileage
gas sta
3697ΔNelson's Diner
restr
Nelson Bernard ⊙
3736ΔHansen Olaf ⊙
3744ΔGilson Peter D ⊙
3748ΔCarlson Carl M ⊙
3752ΔArrowhead Concrete
Wks
3755ΔMerritt Herbert H ⊙
3761ΔSandstrom Roy V ⊙
3769ΔCarlson Hjalmer
C ⊙
3774ΔPhillips Harold C
⊙

3781ΔFossum Alf R ⊙
3807 Vacant
3811ΔJohnson Eug J
3818ΔYax Wm F ⊙
justice of the
peace
3824 Westron Carl E

1960 City
Directory



**DUNNING
&
DUNNING
CO.**



**ALL FORMS
OF
INSURANCE
AND BONDS**



**W.E.B.C. BLDG.
PHONE
722-0802**

**The Alphabetical Section to
get Complete Information on
a person or firm.**

U S E

MARSH & McLENNAN

OF MINNESOTA INC.
INSURANCE AND BONDS

OUR 95th YEAR
306 W SUPERIOR

912 ALWORTH BLDG.

TEL. 722-6373

- MILLER TRUNK HWY--CONT'D
- 3079 ROYAL ROOST DRIVE INN
RESTR 727-6705
DAHL EUG W • 722-9901
- 3080 SKY LINE DRIVE IN THEATRE
727-3661
- 3102 JOHNSON ALICE M MRS •
722-8861
- 3103 WOLFF DEAN W 727-3742
LUNDIE WM M 722-3613
- 3109 HEBERT JOHN J • 722-0173
- 3114 BENSON MARIE MRS •
722-2049
- BENSON ROY M 727-6137
- 3119 BERG RALPH • 722-8751
- 3120 AIRLINER MATCH 722-6628
KURLA JOHN • 722-2481
- 3152 VACANT LOWER
VACANT UPPER
- 3154 BURKES ERNEST 727-6382
- 3160 BLOOM REUBEN L • 727-3961
- 3178 ABRAHAMSON ELROY E ACCT •
727-7879
- 3188 NELSON ARTH E • 722-9964
- 3198 BURES DALE V • 727-6740
- 3204 NELSON PAUL N GARBAGE
COLL • 722-7223
- 3219 CHIPPEWA CAMPING
OUTFITTERS ANOE CAMPING
OUTFITTERS 727-5880
- 3220 AIRBASE MARKET GRO
727-5767
- NELSON EINAR F • 727-5682
- CHRISTENSEN HARRY C
DOWNEY MAX
- HAVLICEK ROBT U 727-4154
- HOCKING LESTER G 722-1964
- ROMERO PAUL 722-0152
- SECRIST HARRY H 727-7935
- SULLIVAN FRANK
WEIL THOS
- 3227 HOLT'S MOBILE SERVICE GAS
STA 727-9811
- 3231 BENSON'S PURE OIL STATION
GAS STA 722-0831
- BENSON'S STORE GRO
722-0831
- NATIONAL TRAILER CONVOY
INC TRAILER TRANS SERV
722-2270
- U-HAUL CO (BR) TRAILER
RENTAL 722-0831
- BENSON'S TRAILER COURT
722-0831
- BENSON ROBT E • 722-0831
- ABERNETHY DONALD J
722-8711
- ANDERSON NORMAN 722-1641
- BERG ARTH W 727-5581
- BRONERSKY JOSEPH 722-4385
- BROUSE TERENCE P
727-2527
- FUNKE OTTO C • 722-8742
- MARSHALL MILDRED F MRS
722-6131
- MIKKELSON WAYNE M
727-5877
- SHOWALTER WM E
- VOLEK EDW M 727-5961
- WILEY JAMES R 722-4170
- 3239 MAKI TOIVO A 727-5417
- 3240 JACKSON CLUB INC SGC
- 3241 FOWLER CONSTRUCTION &
ENGINEERING CO BRIDGE
CONTR 727-8531
- 3250 ABRAHAMSON, MOTEL &
RESTAURANT 722-9806
- ABRAHAMSON LESLIE R •
722-9800
- 3251 BERNTSEN RAYMOND E •
722-8748
- 3261 CARLSON BERTIL C •
727-4032
- REAR BERNTSEN THOS • 727-5768
- 3269 BERNTSEN WALTER M •
722-8858
- 3270 BASKI ROY E • 727-4891
BROWN HARRY 722-4682
RANDALL IRVING L 727-6552
- 3275 HERRICK GED W • 727-6713
- 3309 VACANT
HAMMOND EDGAR C •
727-5617
- 3333 DAHL JOHN A • 722-0170
- 3341 ANDERSON ROBT V •
727-6967
- 3357 UNITED TRUCK BODY INC
TRUCK EQUIP 727-7223
- 3363 WATTS GEC W JR • 727-4146
- 3367 ANDERSON F ROBT JR •
727-3868
- ANDERSON ROBT F 727-3868
- 3375 SKARP EDW E • 727-2192
- 3398 WARGIN RICH D • 722-8774
- 3399 SULLIVAN DAVID P •
722-8849
- 3407 JOHNSON RUEBEN C •
722-8845
- 3420 GALLAGHER'S RESTR
727-9678
- GALLAGHER HUGH • 727-9678
- 3519 ARROWHEAD REFINING CO
727-2484
- GOPHER STATE GIL CO WHOL
MTR OIL 727-2000
- 3582 FORSELL FRED •
- 3600 DULUTH SADDLE CLUB
(ARENA)
- 3608 HEIMSTADT PAUL W 722-9217
- 3610 WILHELM RICH D •
727-2844
- 3644 GRACE LUTHERAN CHURCH
722-9449
- 3680 MC DONALD MYRON M •
722-8497
- 3688 MC DONALD ESSIE MRS •
722-2230
- 3693 JUNCTION MILEAGE GAS STA
727-9808
- 3696 MC DONALD THOS J JR •
722-5656
- 3697 NELSON ANNA B MRS •
729-7569
- 3736 HANSEN OLAF • 729-8061
- 3744 GIBSON PETER D • 729-8380
- 3745 NELSON DALE R • 729-7589
- 3748 CARLSON CARL M • 729-7556
- 3752 ARROWHEAD CONCRETE WORKS
BLOCK MFRS 729-8274
- 3755 HERB'S SPORTS & SUPPLY
SPORTS EQUIP 729-8276
- MERRITT HERBERT H •
729-8276
- 3761 SANDSTROM ROY V •
729-8817
- 3766 SHAW FRANCIS D 729-7885
- 3769 CARLSON HJALMAR C •
729-8929
- 3770 NO RETURN
- 3772 RUZICH JOHN • 729-6403
- 3773 HANNER DAVID L REV
729-7320
- 3781 FOSSUM ALF • 729-8504
- 3801 CURTIS-THORALDSON GIL CO
OIL DIST 729-8241
- 3809 BROWN ROBT W
- 3811 JOHNSON EUG J 729-8116
- 3814 YAX'S KING KOIN KLEENETTE
LNDRS & DRY CLN 727-9184
- 3818 YAX WM F JUSTICE OF THE
PEACE • 729-7354
- 3824 WESTROM CARL E • 729-8052
- 3825 GAZETT DANL M • 729-7380
- 3830 AMENDOLA THOS • 729-7153
- 3840 BANICK GUS • 729-8921
THOMAS RICH D •
- 3846 WAHLBERG E WAYNE •
729-8687
- 3853 LUGMA EDWIN O • 729-8602
- 3859 PRAHL WALTER A • 729-7356
- 3862 CARSRUD OSCAR • 729-8453
- 3864 AHO FRED J • 729-7889
- 3865 LUGMA ELMER W • 729-7492
- 3868 GALESKI FRANK J •
729-7641
- 3872 KANESKI DOROTHY MRS •
729-8565
- 3875 VACANT
- 3876 CARTER PERRY B
- 3878 ERICKSON HUGH G •
729-7198
- 3879 GUPPIES DRINE-IN RESTR
- 3881 RANGEWAY MARINE BOATS &
MARINE SUPS 729-7360
- 3882 PIKE LAKE GAMBLE STORE
RET HDW 729-7345
- 3885 DUBLA'S DRAPERY AND
UPHOLSTERY SHOP 729-7551
- 3886 PAULSON'S SUPER VALUE GRC
729-7364
- 3893 BROMME'S STORE GIFTS &
LUNCH 729-8215
- 3895 RANGEWAY STANDARD SERVICE
GAS STA 727-9491
- 3897 ARTHUR BROS FRUIT-A-RAMA
FRUIT STAND
- 3903 COUNTY FIFTH DIST TOOL
HSE 729-8224
- 3913 ANDERSON ARTH O •
729-8917
- VACANT UPPER
- 3944 SANITARY SEPTIC TANK
PUMPING CLN 729-8231
- MC KEOWN VICTOR H •
729-8231
- 3946 PREMO PETER J BARBER
- 3947 LARSEN LARS M REV
729-7962
- 3952 ANDERSON LOUIS A •
729-8093
- 3964 SANDSTROM TURRE A •
729-8521
- 3968 LIND CURTIS H • 729-7479
- 3970 MATTON NORMAN • 729-7844
- 3974 SANDSTROM DONALD L •
729-7291
- 3978 POPPENBERG DELBERT H •
729-7339
- 3981 GOLEN LEONARD L •
729-7849
- 3984 HEDENQUIST HAROLD W •
729-7389
- 3998 JOHNSON OSCAR R •
729-8952
- 4006 ZENTNER DAVID F 729-7588
- 4012 VACANT
- 4028 JENSON ROY K • 729-7335
- 4029 RONNING JANET M MRS •
729-7662
- 4034 AMENDOLA FRANK • 729-8366
- 4035 AMENDOLA FRANK JR
729-7515
- 4040 GODMARE WM L • 729-7850
- 4046 BOSTROM RICH D •
729-7684
- 4052 STARK LAWRENCE H 729-7506
- HABLE RUDOLPH J JR
729-7512
- 4060 HALTLI OLINA MRS •
729-8598
- 4061 SPICER STEVE • 729-7836
- 4063 DUNAISKY EDW L • 729-8586
- 4070 ADAMICH PAUL J • 729-8249
- 4080 LAYER VICTOR E • 729-8078
- 4086 ANDERSON CHRISTOPHER •
729-8059
- 4088 GENEVIEVE'S PIKE LAKE
BEAUTY SALON 729-7922
- MARTIN GEO 729-7534
- 4092 REY & GEN'S MOTEL
727-9883
- ANDERSON REYNOLD E •
727-9734

1965 City Directory

MILLER TRUNK HWY—Contd

Cook Laurence E 729-6583
 Brown Clifford E Jr 729-6314
 Nesseth John C 729-6757
 Erickson Robt G © 729-9443
 3235 U S Agri Stabilization & Conservation
 Serv 727-6692
 3237 U S Soil Conservation 727-6692
 3239 Hermantown Federal Credit Union
 729-7733
 Hansen Harlan G 729-7055
 3240 Jackson Club Inc
 3241 Fowler Construction & Engineering Co
 bridge contr 729-6800
 3250 Abrahamson Edgetown Motel 729-9806
 Elliott Dudley S © 729-9806
 3251 Berntsen Raymond E © 729-9381
 Rear Berntsen Thos 729-6713
 3261 Carlson Bertil C © 729-6018
 3269 Berntsen Walter M © 729-9274
 3270 Brown's Trailer Court 729-6084
 Miller Chester A 729-6563
 Lapinski Scott 729-8685
 Highum Peter A 729-6941
 Loomis Michl 729-8268
 Mathieu Ronald A 729-9098
 Rogus George 729-6325
 O'Melia Earl 729-6084
 Reasoner James A © 729-9654
 Viche Thos 729-6261
 3275 Herrick Geo W © 729-6763
 3309 Hammond Edgar C © 729-9166
 3333 Dahl John A © 729-9206
 3341 Anderson Robt V © 729-6056
 3357 United Truck Body Inc truck equip
 729-6000
 3363 Williams Ted © 729-6132
 3367 Anderson F Robt © 729-7796
 Anderson Robt A © 729-7796
 3375 Skarp Edw E © 729-6998
 3387 Johnson Ethel P Mrs © 729-7716
 3398 Wargin Richd O © 729-6353
 3399 Sullivan David P © 729-6615
 3407 Johnson Rueben C © 729-6517
 3419 Miller Trunk Veterinary Clinic
 729-7959
 3420 Gallagher's restr 729-9925
 Mart's Cabin Court motel
 Gallagher Hugh © 729-6273
 3519 Arrowhead Refining Co oil dlr
 729-6122
 Gopher State Oil Co whol mtr oil
 729-6030
 3600 Vacant
 3606 Pike Lake Sports 729-7777
 3608 Larson Curtis J 729-7045
 3609 Abrahamson Hilding C © 729-6826
 3610 Wilhelm Richd H © 729-6013
 3644 Grace Lutheran Church 729-9054
 3660 Golf Tee 729-9909
 3680 Mc Donald Myron M © 729-6203
 3687 Gibraltar Homes Inc 729-7176
 3688 Mc Donald Jean C © 729-6405
 3693 Junction Service 729-9927
 3696 Mc Donald Thos J Jr © 729-6572
 3699 Luoma's Custom Kitchens 729-9110
 3736 Hansen Olaf © 729-8061
 3744 Gibson Peter D © 729-8380
 3745 Nelson Dale R © 729-7589
 3748 Carlson Carl M © 729-7556
 3749 Watters Keith © 729-7493
 3752 Arrowhead Concrete Works block mfrs
 729-8274
 3755 Herb's Sports & Supply 729-8276
 Merritt Herbert H © 729-8276
 3761 Vacant
 3766 No Return
 3769 Carlson Hjalmar C © 729-8929
 3772 Ruzich John © 729-8403
 3773 Stevenson Philip G © 729-7041
 3781 Lee Robt E © 729-7699
 3801 Curtis-Tharaldson Oil Co oil distr
 729-8241
 3809 Vacant
 3811 Johnson Eug J 729-8116
 3814 Yax's King Koin Klennette Indrs &
 dry chn
 3818 Yax Wm F justice of the peace ©
 729-7354
 3824 Westrom Carl E © 729-8052
 3825 Henson Glen N 729-9430

Thomas Richd ©

3846 Wahlberg E Wayne © 729-8687
 3853 Luoma Edwin O © 729-8602
 3859 Prah Walter A © 729-7356
 3862 Carsrud Norma E © 729-8453
 3863 Sather Oscar
 3864 Goyette David J © 729-6818
 3865 Erickson Glifford H © 729-7492
 3868 Gifford Charles C ©
 3870 Pavola Construction Co 729-8264
 3872 Kaneski Dorothy Mrs © 729-8565
 3875 Guppy's Pike Lake Drive In 729-7100
 3878 Erickson Hugh G © 729-7198
 3881 Pike Lake Service Center motor
 repairs 729-7630
 3882 Pike Lake Gamble Store ret hdw
 729-7880
 3884 Pike Lake Clothing Inc 729-9090
 3885 Debutant The beauty shop 729-9100
 Frankie's Barber Shop 729-9100
 Dubla Joseph C © 729-6520
 3886 Paulson's Super Valu gro 729-7364
 3893 Jerre's Pike Lake Shoppe gifts &
 coffee shop 729-8215
 Mesenbourg Jerome E 729-8215
 3895 Rangeway Standard Service 729-9935
 3903 County Fifth Dist Tool Hse 729-8224
 3913 Anderson Arth O © 729-8917
 Sargent Robt S 729-8253
 3944 Sanitary Septic Tank Pumping cln
 729-8231
 Mc Keown Victor H © 729-8231
 3947 Lundeen Ronald A Rev 729-7642
 3952 Anderson Louis A © 729-7928
 3958 Mc New Wm V © 729-9556
 3960 Shute Trevor W 729-6305
 3964 Kimball Terry ©
 3968 Tuhkanen Ole © 729-7818
 3970 Radick Dushie © 729-7318
 3974 Sandstrom Donald L © 729-7655
 3978 Carlberg Dean L © 729-7001
 3981 Golen Leonard L © 729-7849
 3984 Hedenquist Harold W © 729-7389
 3994 Sandstrom Shirley © 729-7685
 3998 Johnson Oscar R © 729-8952
 4006 Brenna S Clark
 4012 Vacant
 4028 Pinther Donald E © 729-6531
 4029 Dearborn Chester E © 729-8833
 4034 Amendola Frank S © 729-8366
 4035 Mc Calvin Ralph 729-8497
 4040 Godmare Wm L © 729-7850
 4046 Bostrom Richd W © 729-7684
 4052 Mc Donald Leo J © 729-7422
 4060 Haltli Olina Mrs © 729-8598
 4061 Cafferty James E © 729-7383
 4063 Dunaisky Edw L © 729-8076
 4070 Adamich Paul J © 729-8249
 4080 Layer Clara E Mrs © 729-8078
 4086 Andersen Christopher © 729-8059
 4088 Anderson Genevieve Mrs © 729-7683
 Sanderson James J 729-7757
 4092 Rey & Gen's Motel 729-9971
 Anderson Reynold E © 729-9971

**MILWAUKEE AV —FROM W AUSTIN
NORTH, 6 WEST OF WOODLAND AV****ZIP CODE 55803**

11 Olson Donald T © 728-2726
 15 Coles Marie D Mrs © 724-5721
 19 Carlson Allan D © 724-9359
 23 Tapa Lloyd E © 728-1778
 27 Beasley Richd E © 728-2714
 29 Olinek Andrew well driller © 724-4441

**MINERAL ST —FROM PLEASANT AV
WEST, 2 NORTH OF BOULEVARD****ZIP CODE 55810**

7416 Johnson Wilfred E © 624-5117
 7430 Vacant

**MINNEAPOLIS AV —FROM 2700
WOODLAND AV NORTH****ZIP CODE 55803**

6 No Return

20 Ryan Mary A © 724-7642
 21 Pontlana Helen L Mrs © 724-4444
 22 Micheau Merle J © 724-0256
 24 Foster Grace L Mrs © 728-1534
 26 Lundquist Mamie E Mrs © 724-5849
 29 Cook A Nathan © 724-4385
 34 Rickard Mayme Mrs © 724-7540
 35 Barber Florence M Mrs © 724-1343
 38 Loukes James R © 724-7679
 43 Bayha Ella L Mrs © 724-2916
 44 Prudhomme Alf J © 724-0105
 102 Engel Lawrence N © 724-2526
 109 Gilcrest Richard © 724-4074
 114 Smitke Alice Mrs © 728-3238
 115 Lilya Lee E © 724-0980
 116 Watts Patricia Mrs © 724-8293
 118 Carter Margt Mrs 728-4345
 119 Howard Harland © 728-1578
 120 Kennedy Leo J 728-1670
 122 Spornick Joyce Mrs 728-3142
 123 Clements Frank T © 724-4885

WADENA ST INTERSECTS

201 Fjelstad Thea Mrs © 724-6489
 208 Davern Dennis J © 728-4514
 210 Arthur John L © 724-7369
 211 Kruger Eug L © 728-3387
 218 Walker Ralph R © 724-2010
 219 Kernan Wm J ©

OSAKIS ST INTERSECTS

301 Carl Albert G © 724-6192
 302 Hoivik Egil © 728-2915
 305 Snyder Earl W © 724-4590
 306 Nelson Richd M © 724-3644
 309 Grosso Jeffrey L 728-2309
 310 Jeanetta Kathryn F Mrs © 728-2544
 313 Plourde Louis F © 724-7219
 314 Kyröla Geo H 724-2811
 318 Davis Lawrence E © 728-1780
 321 Wittich Glenn C © 724-4880

ISANTICI ST INTERSECTS

401 Mendoza Donald © 728-3480
 402 Sanders Douglas O © 724-1631
 409 Bielli Theo A © 724-5868
 415 Esse Howard L © 724-1177
 416 Smith Everett B © 724-2701
 418 Makela Anthony L © 724-0549
 419 Redepenning Roland C © 724-5531
 422 Stahl Phillip M © 724-3509

ANOKA ST INTERSECTS

508 Little Wayne G © 724-2061
 517 Higgins Robt M © 724-3638
 519 Zabrocki Harry F © 728-4745
 602 Bergman Elow © 728-4338
 608 Swanson Jac G © 728-4778
 614 Faust Marcel J © 724-6700
 618 Ledingham Alex © 724-5897

BELLIS ST INTERSECTS

701 Hoyum Jean G Mrs ©
 709 Beaudry Wm © 724-2271
 710 Prudhomme Lawrence J © 724-8078
 716 West Oscar W © 724-1978
 717 Kalland Roger O © 724-9402
 806 Smith James R © 724-4035
 815 City Water Gas Sewage Treatment
 Dept (Pump Sta)

816 Walkowiak Jane I Mrs © 724-6716
 818 Jenkins Richd H © 724-8288

MANKATO ST INTERSECTS

901 Chesney John G © 724-4743
 906 Schubert Roy S © 724-9187
 918 Walline Edw W © 724-5074
 1005 Spring Robt G © 728-3514
 1006 Morwood Chas L © 724-6015
 1015 Benson Irving L © 724-8446
 1016 Gorny Edw J © 728-2075
 1104 Kovach Frank J ©
 1107 Swanstrom Edw C ©
 1110 Kovach David J ©
 1117 Kangas Henry W © 724-0880
 1202 Kniep Dora C 724-3459
 1206 Berntson Julien H © 724-9451
 1207 Ostrander Alma Mrs © 724-7475
 1215 Carlson Helmer B © 724-0545
 1302 Landre Charles E © 724-0407
 1309 Adams Christopher R © 724-3779
 1312 Keller Wm R ©
 1313 Harris Glenn L © 728-5687
 1401 Koski Wilbert © 728-3811
 1414 Befera Frank P © 724-1058
 1415 Westin Vern Builders & Realtors
 724-0001

1970
 City
 Directory

- 114 Benson Auto Service repr 729-6370
Benson John E Jr @ 729-9284
- 119 Berg Ralph @ 729-6083
- 120 Airliner Motel 729-6628
Cozzi Frank C @ 729-6628
- 130 Billman's Home Center custom home
bldrs 729-8232
Tim's Custom Cabinet cabtmkrs
729-6044
- 136 Vacant
- 140 Benson Trailer Sales campers
729-8033
- 1160 Sagen's Tradition House home
furnishings 729-7755
- 1178 Abrahamson Elroy E pub acct @
729-6822
Hansten Wm M @ 729-9064
- 1181 Rogers' Honda Village 729-6161
- 1185 Asphalt Of Duluth Inc paving contrs
729-9050
Schober Roger A acct 729-9050
Schober-Amys Inc genl contrs
729-9050
- 3188 Nelson Arth E @ 729-6649
- 3189 Jay En Inc radio communication
equip 729-9300
- 3191 Allied Van Lines Inc furn movers
729-6116
Security Storage Co moving vans
729-6116
Reach All crane mfg 728-5138
- 3195 Christensen's Heating & Insulation Co
contrs 729-9000
- 3198 Bures Dale V @ 729-9829
- 3204 Johnson Paul N garbage coll @
729-9213
- 3216 Mc Donald Duane dentist 729-9810
- 3219 Rogers Honda Village (Whse) 729-6161
King Of The Hill Sports snowmobile
sls 729-6151
- 3220 Airbase Market Inc 729-6110
Nelson Gregory @ 729-6637
Lots
1★Nyhholm Mary Ann 729-6319
2★Lockhart Isaac
3★Des Lorgchamps Geo
4 Vacant
5★Carter Danny R 729-8649
6★Smith Arvin
7★Whitney Larry
8 Riggio John R 729-9575
9★Anesi Thos N 729-6372
10★Christianson Harry
11★Swenson Carl 729-6181
- 3227 Schelin Service gas sta 729-6623
- 3229a Hermantown Federal Credit Union
729-7733
- 3229b American Family Insurance genl ins
729-6900
- 3229 Lucky's Sales & Service 729-7397
- 3231 Benson Robt E @ 729-6778
- 3235 U S Agrl Stabilization & Conservation
Serv 727-6692
- 3237 Patch & Ball sports shop 729-7764
U S Soil Conservation Service
727-6692
- 3240 Jackson Club Inc
- 3241 Fowler Construction & Engineering Co
genl contr 729-6800
- 3250 Edgetown Motel 729-9806
Blaede Steph W @ 729-6250
- 3251 Berntsen Raymond E @ 729-9381
- Rear Berntsen Martha Mrs 729-6713
- 3261 Carlson Bertil C @ 729-6018
- 3269 Berntsen Walter M @ 729-9274
- 3270 Brown's Trailer Court 729-8571
Brown Harry @ 729-8571

MILLER TRUNK HWY—Contd

- Lots
- 1 Pugh Russell 729-6925
- 2★Buase David
- 3★Hubbard Barbara 729-6186
- 4 Bagan Douglas E 729-6996
- 5★Aili Tom 729-7679
- 6 Schrader Ronald
- 7★Kolquist Timothy A 729-8177
- 8 Pfeifer Walter T
- 9 Remund Lonnie L 729-9139
- 10★Kari Gregory
- 11★Smith Dean R 729-9683
- 12★Moen Jerry
- 13★Johnson Leon 729-8581
- 3275 Herrick Geo W @ 729-6763
- 3309 Hammond Helga Mrs @ 729-9166
- 3333 Dahl John A @ 729-9206
- 3341 Anderson Robt V @ 729-6056
- 3357 United Truck Body Inc truck equip
729-6000
- 3363 Vacant
- 3367 Anderson F Robt @ 729-7796
- 3375 Skarp Edw E @ 729-6998
- 3387 Johnson Ethel B Mrs @ 729-7716
- 3398 Wargin Richd O @ 729-6353
- 3399 Sullivan David P @ 729-6615
- 3407 Johnson Rueben C @ 729-6517
- 3419 Miller Trunk Veterinary Clinic
729-7959
- 3420 Gallagher's restr 729-9925
Gallagher Hugh @ 729-6273
Gallagher James M 729-6284
★Neff Elrose 729-9895
- 3519 Arrowhead Refining Co oil dlr
729-6122
- 3600 Vacant
- 3605 Sandstrom Carl & Sons Inc painting
& dry wall 729-7906
- 3606 Vacant
- 3608 Vacant
- 3609 Abrahamson Hilding C @ 729-6826
- 3610 Lundgren Jack 729-7174
- 3611 Concord Homes Inc home bldrs
729-9400
- 3644 Grace Lutheran Church 729-9054
- 3660 Vacant
- 3680 Mc Donald M M Construction Co Inc
bldg contrs 729-6203
Mc Donald Myron M @ 729-6203
- 3688 Mc Donald Jean C @ 729-6405
- 3693 Miller Trunk Faagas gas sta 729-9980
- 3696 Vacant
- 3736 Vacant
- 3744 Gibson Peter D @ 729-8380
- 3745 Nelson Dale R @ 729-7589
- 3748★Seline Alan R 729-7750
- 3749★Holte David 729-7279
- 3752 Arrowhead Concrete Works 729-8274
- 3755 Herb's Sports & Supply 729-8276
Merritt Herbert H @ 729-8276
- 3761 Grierson Gary @ 729-9843
- 3766 Vacant
- 3769 Carlson Hjalmar C @ 729-8929
- 3772 Ruzich John @ 729-8403
- 3773 Stevenson Philip G @ 729-7041
- 3781 Atwell Glenn D 729-9890
- 3801 Pike Lake Superamerica gas sta
729-9950
- 3814 Yax Electric Inc contrs 729-8400
Yax's King Koin Kleenette Indrs
- 3818 Yax Isabell M Mrs @ 729-7354
- 3824★Urban James M @ 729-7839
- 3825 Hansen Glenn N @ 729-9430
- 3830 Yax Wm F II @ 729-8103
- 3838★Soufflet Robt B 729-9238
- 3840 Banick Gus @ 729-8921

- Pliml Wm 729-7238
- 3846 Wahlberg E Wayne @ 729-8687
- 3853 Luoma Edwin O @ 729-8602
- 3858 National Painting & Sandblasting
729-6999
Pavola Construction Co bldg contrs
729-8264
Vacant
- 3859 Prahl Walter A @ 729-7356
- 3862 Carsrud Norma E @ 729-8453
- 3863 Sather Oscar @ 729-9073
- 3864 Goyette David J @ 729-6818
- 3865 Erickson Glifford H @ 729-7492
- 3868 Vacant
- 3872 Kaneski Dorothy B Mrs @ 729-8565
- 3875 Guppy's Pike Lake Drive In restr
729-7100
- 3878 Erickson Hugh G @ 729-7198
- 3881 Pike Lake Service Center motor
repairs 729-7630
- 3882 Pike Lake Gamble Store ret hdw
729-7880
- 3884 Skogmos family clo 729-9090
- 3885 Debutant The beauty shop 729-9100
Johnson Carter F dentist 729-7270
- 3886 Paulson's Super Valu gro 729-7364
- 3893 County House & Kitchen restr
729-9911
Lipinski Dale F @ 729-9911
- 3895 Rangeway Standard Service 729-9935
- 3903 County Fifth Dist Tool Hse 729-8224
- 3904 Northern States Steel Builders Inc
portable bldgs 729-6543
- 3913 Sterling Richd N @ 729-6876
★Van Dake Bruce 729-9212
- 3944 Sanitary Septic Tank Pumping cln
729-8231
Mc Keown Victor H @ 729-8231
- 3947 Gamache Ray J @ 729-6391
- 3952 Anderson Louis A @ 729-7928
- 3958 Hage Warrens @ 729-7237
- 3960 Mc Greevy James V 729-8016
- 3964 Kimball Sherald @ 729-7028
- 3968 Tuhkanen Olaf O @ 729-7818
- 3970 Johnstone Edwin @ 729-8201
- 3974 Sandstrom Donald L @ 729-7655
- 3978 Carlberg Dean L @ 729-7001
- 3981 Golen Leonard L @ 729-7849
- 3984★Nelson Carter R @ 729-6021
- 3994 Sandstrom Shirley @ 729-7586
- 3995 Sandstrom Turre A @ 729-8521
- 3998 Johnson Oscar R @ 729-8952
- 4006★Palcher Bernard J 729-6351
- 4012 Vacant
- 4028 Pinther Donald E @ 729-6531
- 4029 Brouse Robt J
- 4034 Amendola Frank S @ 729-8366
- 4035★Kacer Joseph W 729-6720
- 4040 Godmare Wm L @ 729-7850
- 4046★Lillmars Paul W @ 729-6837
- 4052 Mc Donald Leo J @ 729-7422
- 4060 Haltli Olina Mrs @ 729-8598
- 4061 Cafferty Gail E Mrs @ 729-7383
- 4063 Dunaisky Edw L @ 729-8076
- 4070 Adamich Paul J @ 729-8249
- 4080 Layer Clara E Mrs @ 729-8078
- 4086 Joplin Glenn H @ 729-7213
- 4088 Vacant
- 4092 Rey's Shop & Efficiency Apartments
729-9361
Anderson Reynold E @ 729-9361

- 11 Olson D
- 15 Vacant
- 19 Carlson
- 23 Lodholz
- 27 Beasley
- 29 Olinek

MINERAL WEST 2

- ZIP COD
- 7416 Vacar
- 7430 Krisk

MINNEAP WOODL

- ZIP COD
- 6 Paulucci
- 10 Krupp I
- 18 Langley
- 20 Ryan A
- 21 Pontliar
- 22 Michea
- 24 Foster (
- 26★Lundq
- 29 Wolfent
- 34 Ohlin A
- 35 Barber
- 38 Loukes
- 43 Bayha I
- 44 Prudhor
- 102 Engel
- 109 Johnsc
- 114 Smitke
- 115 Lilya I
- 116 Fresten
- 118★Farke
- 119 Howar
- 120 Rhines
- 122 Ellings
- 123 Basset
- WADEN
- 205★Matt
- 208 Daver
- 210 Wooda
- 211 Kruge
- 218 Walke
- 219 Kerna
- OSAKIS
- 301 Carl A
- 302 Hoivik
- 305 Snyder
- 306 Bolos
- 309★Halli
- 310 Braasc
- 313 Plourd
- 314 Berg
- 318 Davis
- 321 Wittici
- ISANTI
- 401 Mendc
- 402 Sande
- 409 Bielli
- 415 Esse I
- 416 Smith
- 418★Make
- 419 Redep
- 422 Stahl
- ANOKA
- 508 Pawla
- 517 Higgir
- 519 Zabro
- 602 Bergr
- 608 Swans

**MILWAUKEE AV —FROM W AUSTIN
 NORTH 6 WEST OF WOODLAND AV**

ZIP CODE 55803

EMS **OS** **DEMPSTER SYSTEMS**
 ment/Consultants
Telephone 624-7448

REALTOR® **FOUR SEASONS** **REALTOR** 1975
1610 Maple Grove Rd.
City Directory

DULUTH CAMERA EXCHANGE

THE AREA'S MOST COMPLETE PHOTOGRAPHIC CENTER

321 W. SUPERIOR ST. (DULUTH)

TEL. 727-2225

178

- MILLER TRUNK HWY—Contd**
 Schober Roger A cpa 729-9050
 Schober-Amys Inc genl contrs 729-9050
- 3188 Nelson Violet E Mrs @ 729-6649
 3189 Jay En Inc radio communication equip 729-9300
 3191 Security Storage Co moving 729-6116
 Reach-All Sales & Service Inc crane mfg 729-9591
 3195 Christensen's Heating Co contrs 729-9000
 A-1 Insulation Co contr 729-8111
 Solar Stor North solar heat prod sls 729-9000
- 3198 Bures Dale V @ 729-9829
 3204 Johnson Paul N @ 729-9213
 3216 Miller Trunk Dental Building
 Harper Eaton Peterson & Overom 729-5413
 Sirois Bob Contracting Inc home bldrs 729-6373
 Mc Donald Duane dentist 729-9810
 Dahlgren Steven dentist 729-9810
- 3219 Fire Safety Products Inc fire protection equip sls
 3220 Honda Village mtrcycle dlr 729-6161
 Nelson Einar 729-6637
 Lots
 1 Vacant
 2 Vacant
 3 Ugstad Lynn 729-7595
 4*Butler Meredith
 5 Vacant
 6*Supina Robt D @ 729-5464
 7 Mc Donald Dale R @ 729-7053
 8 Johnson
 9*Audres Wm R 729-6989
 10 Grew Judy
 11 Vacant
- 3227 Lucky's Sales & Service serv sta 729-7397
 3228 Triad Systems computer sls 729-5457
 Hermantown Federal Credit Union 729-7733
 3229a Uptown Glass & Mirror Inc 729-6020
 3229b American Family Insurance genl ins 729-6900
- 3230 Blaedde Steph W 729-6250
 3231*Runzel Albert R 729-7891
 Benson Auto Service 729-6370
 3233 Evie's Craft Supplies 729-7559
 3235 U S Agrl Stabilization & Conservation Serv 727-6692
 3237 U S Soil Conservation Service 727-6692
 Hermantown T V 729-8511
- 3239*Pecor Lonnie
 3240 Jackson Club Inc
 3241 Todd Signs 729-6800
 Johnson E Todd @ 729-9668
- 3250 Edgetown Motel 729-9806
 Aulwes Herbert W @ 729-9806
- 3251 Berntsen Raymond E @ 729-9381
 3261 Carlson Bertil C @ 729-6018
 3269 Berntsen Walter M @ 729-9274
 3270 Brown's Trailer Court 729-8571
 Brown Harry @ 729-8571
 Lots
 1*Gaffke Gordon
 2*Sundberg James
 3*Carlson Mike
 4*Regoni Gayle L
 5 Aili Thos @ 729-7679
 6*Carpenter Roland
 7 Elam Bruce 729-6276
 8*Anderson Jas J @ 729-5326
 9*Martin Sandra L
 10 Ness Sandra 729-8146
 11 Minor James
 12*Williams Betty
 14 Peterson Mark K 729-6184
- 3275 No Return
 3309 Hammond Helga Mrs @ 729-9166
- 3333 Dahl John A @ 729-9206
 3341 Anderson Robt V @ 729-6056
 3357 United Truck Body Inc truck equip 729-6000
- 3363 Galleria Schwinn sls & serv 729-9704
 3367 Vacant
 3375 Skarp Edw E @ 729-6998
 3387 Johnson Ethel B Mrs @ 729-7716
 3398 Wargin Richd O @ 729-6353
 3399 Sullivan Beatrice M Mrs @ 729-6615
 3407 Johnson Rueben C @ 729-6517
 3420 Gallagher's restr 729-9925
 Gallagher Hugh @ 729-6273
 Gallagher James M 729-6284
 Neff Elrose 729-9895
- 3421 Miller Trunk Veterinary Clinic 729-7959
 3512 Pet Lodge Inc
 3518 Swor Realty 729-9187
 Swor Homes modular home 729-9187
- 3519 Gopher Oil Co oil dlr 729-9600
 3554 Vacant
 3600 Arrowhead Outdoor Products recreation sls & serv 729-6982
- 3605 Sandstrom Carl & Sons Inc painting dry wall & plastering 729-7906
- 3608 Peterson Delores Mrs @ 729-6322
 3609 Abrahamson Hilding C @ 729-6826
 3610 Lundgren Jack L @ 729-7174
 3611 Concord Homes Inc home bldrs 729-9400
- 3633 Model Home
 3644 Grace Lutheran Church 729-9054
 Hermantown Montessori School & Day Care Center 729-6577
 Montessori Learning Center 729-6577
- 3680 Mc Donald M M Construction Co Inc bldg contrs 729-6203
 Mc Donald Myron M @ 729-6203
- 3687 Arrow Homes Inc mobile home sls 729-6030
 3688 No Return
 3693 Jet gas sta 729-8256
 3699 Clarklift Of Duluth fork lifts sls-serv 729-6081
- 3701 Twin Ports Asphalt Inc contr 729-9289
 Twin Ports Seal Systems water proofing contr 729-9289
 C P M Enterprises Inc 729-9289
 Tropical Pool swimming pools contr 729-9289
- 3744 Gibson Peter D @ 729-8380
 3745 Nelson Dale R @ 729-7589
 3748 Carlson Gerald E 729-6886
 3749 Holte David @ 729-7279
 3752 Arrowhead Concrete Works 729-8274
 3755 Herb's Sports & Supply 729-8276
 Merritt Herbert H @ 729-8276
- 3761 Nollet Edw J @ 729-7424
 3766 Larson Bruce A 729-8993
- 3769 No Return
 3772 Vacant
 3773 Stevenson Philip G @ 729-7041
 3781 Severance James F @ 729-6725
 3801 Pike Lake Superamerica gas sta 729-9950
- 3810 Vacant
 3814 Country Hearth Inc The fire place sls 729-7632
- 3824*Yax Bill 729-8400
 3825*Tiili Dale A @ 729-6981
 3830*Larson David
 3838 Vacant
 3840 Banick Gus @ 729-8921
 3846 Vacant
 3853 Luoma Edwin O @ 729-8602
 3858 National Painting & Sandblasting Inc 729-6999
 Pavola Construction genl contr 729-8264
- 3859 Adams Richd @ 729-8569
 3862 Carsrud Norma E @ 729-8453
 3864 Jackson Bruce A @ 729-6028
- 3868 No Return
 3872 Pike Lake Motors 729-8258
 3875 Guppy's Pike Lake Drive In restr
 3878 Erickson Hugh G @ 729-7198
 3881 Pike Lake Service Center engine repairs 729-7630
- 3882 Pike Lake Hardware ret 729-7880
 3884 Pike Lake Clothing 729-9090
 3885 Debutant The House Of Hair beauty shop 729-9100
 Prahl Oil Co Inc (stand oil prod) 729-7356
- 3886 Paulson's Super Valu gro 729-7364
 3893 Corner Cafe
 Vacant
- 3895 Rangeway Standard Service 729-9935
 3903 County Road & Mtce Dept (Fifth Dist Tool Hse) 729-8224
- 3904 Northern States Steel Builders Inc steel erectors 729-6543
- 3913 Sterling Richd N @ 729-6876
 Pfeifer Walter T 729-6993
- 3944 Ace Septic Tank Pumping cln 729-8231
 Mc Keown Victor H @ 729-8231
- 3947 Gamache Ray J @ 729-6391
 3952 Anderson Louis A @ 729-7928
 3958 Hage Warren S @ 729-7237
 3960*Aamohd Curtiss
 3964 Nesgoda Clarence D @ 729-4758
 3968 Zuhars Raymond H @ 729-7717
 3970 Johnstone Edwin @ 729-8201
 3974 Sandstrom Donald L @ 729-7655
 3978 Carlberg Dean L @ 729-7001
 3981 Golen Leonard L @ 729-7849
 3984*Gronseth Charles @ 729-5045
 3994 Sandstrom Shirley @ 729-7586
 3995 Sandstrom Turre A @ 729-8521
 3998 Johnson Oscar R @ 729-8952
 4006 Gvurcynski John
 4012 Vacant
 4028 Pinther Donald E @ 729-6531
 4029 Love Alva @ 729-9741
 4034 Amendola Frank S @ 729-8366
 4035 Spicer Diane R Mrs
 4040*Godmare Wm L @ 729-7850
 4046 Lamb Harold H @ 729-6837
 4052 Mc Donald Leo J @ 729-7422
 4060 Heltli Oliver P @ 729-8598
 4061*Pearson-Smith Gail E Mrs @ 729-8578
- 4063 Dunaisky Edw L @ 729-8076
 4070 Adamich Paul J @ 729-8249
 4080 Layer Claire E Mrs @ 729-8078
 4086 Hughes Mary O @ 729-6279
 4088 Vacant
 4092 Rey's Shop cabin rentals 729-9361
 Anderson Reynold E @ 729-9361
 Cabins
 1 Perkins Bruce 729-8853
 2 Vacant
 4*Vejar Vickie
 5*Strand Dan
 6 Saridinsky John
 7*Gundarson Lora
 8*Bendick Lee
 10 Godmare Craig W 729-7764
 11*Bendick Neal
 12 Russe Terry
 13*Russe Jerry

52

MILWAUKEE AV —FROM W AUSTIN
 NORTH 6 WEST OF WOODLAND AV

- ZIP CODE 55803
 11 Gandrud Marlowe C @ 724-2720
 15 Geving Glen N @ 724-4107
 19 Carlson Allan D @ 724-9359
 23 Carlson Gary A @ 724-2588
 27 Beasley Richd E @ 728-2714
 28 Olmick Andrew @ 724-4441

FEATURING ITALIAN & SEAFOOD ENTREES
 ON & OFF SALE
 636-9964
 DULUTH, SUPERIOR, WISCONSIN

De Gideo's
 The Italian Fisherman



- MILLER TRUNK HWY—Contd**
- 312 U S Soil Conservation Serv fld ofc st louis lk-cook cnty 727-6692
 - 314 U S D A Farmers Home Admn 727-6692
 - 317 Vacant
 - 319 Vacant
 - 325 Shangri-La health & fitness 723-1605
 - 326 Apartments
 - 1★Nelson Jordis 722-4528
 - 2 Turbin Nick S 723-2349
 - 3 Zinda Russell 722-3257
 - 4★Platt Randy
 - 927 Apartments
 - ★Olson C 723-1778
 - 929 Twin City Monument 722-5962
 - 930 Skyline Court Motel 727-1563
 - Berg Manson © 722-2827
 - Lots
 - 1 Hauptert Gordon
 - 2 Headrich Wm C
 - 3★Shelton Roger
 - 4★Larson Curtis E © 723-8367
 - 5 Wilkins Florence F © 727-7555
 - 6★Pitoscia Laura
 - 7 Johnson Douglas R 727-0308
 - 8 Vacant
 - 9 Wietman Leslie A © 722-1543
 - 10 Kubis Donald C © 727-7820
 - 11★Beatty Bruce T 722-7680
 - 12 Vacant
 - 14 Johnson Roberta 722-6107
 - 15 Vacant
 - 16 Swanson Myles A 723-1746
 - 17 Quade Phillip Q 722-9715
 - 18 Hjerpe Thos K
 - 19 Archambeau Dorothy 722-1212
 - 20 Bynum Wm R 727-3991
 - 948 Duluth Clinic Ltd-Hermantown 727-8119
 - 949 Anderson Gertrude E Mrs © 722-9472
 - 950 Dave's Pizza 727-5298
 - 951 Vacant
 - 953 Perkins Geo C © 722-5216
 - 954 Skyline Bowling Lanes Inc 727-8555
 - Skyline Coffee Shop 727-8555
 - Skyline Lounge 727-8555
 - 959 Northwest Home Care hosp sups 722-3503
 - Vacant
 - Servicemaster Of The North Inc cln serv 727-3611
 - Hudson Mark J 726-0842
 - Transportation Dept (Resident Office Hwy Constn) 723-4868
 - Hermantown Chiropractic Clinic 723-1291
 - Vacant
 - 999 Gordy's Farm Market 722-8666
 - 3000 Talarico's Sales Inc mobile home sls 729-9210
 - T & T Enterprises Of Duluth Inc mobile home park 729-9210
 - Moe Alyce Mrs © 729-9333
 - Inland Auto Body
 - K & S Arms & Leather Inc firearms & horse equip 729-9200
 - S S Electronics electronic serv 729-8394
 - 3002 Budget Rent A Car 729-6884
 - 3008 Sonju Duluth 729-5873
 - Sonju Leasing Co Inc auto 729-5882
 - 3016 R J Sport & Cycle 729-5150
 - 3065 Bullyan Mobile Homes & Recreation Center 729-9111
 - 3075 Birchwood Mobile Estates 729-6675
 - 3079★Iverson Marion F 729-5783
 - 3080 Skyline Drive-In-Theatre 729-6080
 - 3102 Gregoire Earl B © 729-6346
 - 3113 Curtis Oil Co 729-8241
 - Curtis Tire Co 729-8241
 - Miller Trunk Food & Fuel 729-9993
 - 3114 Easy Housing Of Duluth Inc mobile home sls 729-8001
 - 3119 Food & Fuel 729-5500
 - 3120 Airliner Motel 729-6628
 - Cozzi Dorothy M Mrs © 729-6628
 - 3130 Billmans Home Center bldg center 729-8232
 - Billmans 729-8233
 - Billman Realty 729-7567
 - 3140 Vern's Trailer Sales 729-8033
 - 3152 Skyline Motors Inc used cars 729-9360
 - 3152½ Frederick Herb C 729-5892
 - 3160 Tradition House home furnishings 729-7755
 - 3178 Abrahamson Betty M Mrs © 729-6822
 - 3181 Pella Products Of Duluth (Div Nomeco Bldg Splst) planning cntr 729-7120
 - 3185 Asphalt Of Duluth Inc paving contrs 729-9050
 - Vacant
 - Schober Roger A acct 729-9050
 - Schober-Amys Inc genl contrs 729-9050
 - 3188 Nelson Violet E © 729-6649
 - 3189 Jayen Inc telephone equip & sys 729-9300
 - 3191 Security Storage Co moving 729-6116
 - Reach All Sales-Service mfg 729-9591
 - 3195 Vacant
 - 3198 Bures Dale V © 729-6011
 - 3204 Johnson Paul N © 729-9213
 - 3210 Mc Donald M M Construction Co Inc bldg contrs 729-6203
 - Mac's Rental & Sales 729-6203
 - 3212 Mc Donald Landscaping 729-5763
 - 3216 Miller Trunk Dental Building 729-9810
 - Mc Donald Duane F dentist 729-9810
 - Dahlgren Stephen dentist 729-9810
 - Vacant
 - 3219 Fire Safety Products Inc 729-6200
 - 3220 Ania Gift & Consignment Shop 729-9222
 - Luiten's Trailer Court 729-7581
 - ★Luiten Angeline 729-6976
 - 1 Vacant
 - 2 Anderson Steven © 729-5349
 - 3★Nelson Einor F 729-6637
 - 4 Vacant
 - 5 Novak Shirley C © 729-9128
 - 6 Burcar Ronald F 729-7743
 - 7 No Return
 - 8★Grant Jennifer
 - 9 Andres Wm R 729-6989
 - 10★Steele Steven
 - 12 No Return
 - 3225 North Country Business Products mach tech 729-5070
 - 3227 Miller Trunk Mobil 729-5155
 - 3228 Hermantown Federal Credit Union 729-7733
 - 3229 Vacant
 - 3229b American Family Insurance 729-6900
 - 3230 Datafax Systems genl ledger servs 729-5380
 - Blaede Steph W © 729-6250
 - 3231 No Return
 - Skerbinc Marlene D Mrs 729-5320
 - Benson Auto Service 729-6370
 - Benson Trailer Court 729-6778
 - Benson Robt
 - 3233 Wood Magic 729-7175
 - 3235 Vacant
 - 3237 Vacant
 - 3239 Johnson Kelly D 729-8649
 - 3240 Jackson Club Inc
 - 3241 Todd Signs 729-6800
 - Johnson E Todd
 - 3250 Edgetown Motel 729-9806
 - Campbell Christopher © 729-8745
 - Berntsen Raymond E © 729-9381
 - 3261 Carlson Bertil C © 729-6018
 - 3269 Berntsen Walter M © 729-9274
 - 3270 Brown's Trailer Court 729-8571
 - Brown Harry © 729-8571
 - 1 Engen John W 729-9312
 - 2 Sundberg James W 729-5598
 - 3 Ridgeway Bryan 729-9278
 - 4 Thoreson Nels A © 729-5827
 - 5 No Return
 - 6 Vacant
 - 7 Vacant
 - 8 Rosas Douglas © 729-6947
 - 9 Hanson Randy A 729-5887
 - 10 Ness Sandra R 729-8146
 - 11★La Vigne Nancy
 - 12 Schiefelbein Donna Mrs 729-5404
 - 13 Cole Rex D 729-5663
 - Herrick George 729-6763
 - 3275 Vacant
 - 3325 Edstrom Al E © 729-9725
 - 3333 Dahl John A © 729-9206
 - 3341 Anderson Robt V © 729-6056
 - 3357 United Truck Body Co Inc 729-6000
 - 3363 Galleria Schwinn sls & serv 729-9704
 - 3367 Maple Hill Health & Recreation 729-7435
 - 3375 Skarp Edw E © 729-6998
 - Carson Joan M © 729-8430
 - 3387 Johnson Ethel B Mrs © 729-7716
 - 3398 Wargin Richd O © 729-6353
 - 3399 Sullivan Beatrice M Mrs © 729-6615
 - 3407 Van Reese Richd V © 729-7519
 - 3420 Gallagher's restr 729-6273
 - Gallagher Hugh C © 729-6273
 - ★Nelsen Robt L 729-9895
 - Neff Elrose 729-9895
 - 3421 Miller Trunk Veterinary Clinic 729-7959
 - 3512 Mc Kinnon Brothers Auto Parts 729-8393
 - 3517 Ye Olde Body Shoppe 729-9260
 - 3518 Olson Dennis R acct 729-9727
 - 3519 Gopher Oil Co 729-9600
 - 3542 Leisure Distributing Inc spa-saunas-hot tubs 729-5060
 - Tubby Checker Pool & Spa Center Inc 729-7414
 - 3554 Lucky's Sales And Service 729-7397
 - Ahlers Wm P © 729-7394
 - 3600 Minnesota Outdoor Recreation garden & lawn implements dlrs 729-6982
 - 3605 Vacant
 - 3608 Peterson Delores Mrs © 729-6322
 - 3610 Lundgren Jack L © 729-7174
 - 3611 Vacant
 - 3630 Vacant
 - 3633 Prop Shop propeller reprs 729-8304
 - ★Breiland Donald O © 729-8304
 - 3644 Grace Lutheran Church 729-9054
 - Hermantown Head Start 729-6698
 - 3680 Mc Donald Myron M © 729-5854
 - 3688★Mc Donald John E 729-6405
 - 3693 Food N Fuel gas sta 729-8256
 - 3696 Whalen Kathy 729-5499
 - 3699 Arrowhead Sales And Service Inc 729-5911
 - 3702 Dougherty Thos A © 729-7379

- MILLER TRUNK HWY**
- 3744 Gibson Peter D (
 - 3745 Truesdale Kathle
 - 3748 Carlson Gerald F
 - 3749 Carlson Sandy J
 - 3752 Arrowhead Concr
 - 3755 Herb's Sports & Merritt Herbert)
 - 3761 Nollett Edw J ©
 - 3766 Kinetz Roger 729
 - 3769 Carlson Hjalmar
 - 3772 Vacant
 - 3773 Stevenson Philip
 - 3781 Severance James
 - 3801 Pike Lake Supere 729-5084
 - 3810 Bowen Chas A 72
 - 3814 Puglisi Family St
 - 3824★O'Neill John 729-
 - 3825 Tiili Dale A © 72
 - 3830 Larson C David ©
 - 3838 Pliml Barbara B (
 - 3840 Banick Gus © 72
 - 3846 Wahlberg Dean S
 - 3853 Luoma Raymond
 - 3858 National Painting 729-6999
 - Pavola A R Const 729-8264
 - 3859 Adams Richd I
 - 3862 Carsrud Norma E
 - 3864 Jackson Bruce A
 - 3865 Hogan Richd J ch
 - 3868 Pike Lake Profess 729-7270
 - Pike Lake Dental dentists
 - Johnson Carter F
 - Idziorek Robt J d
 - Insurance Capitol
 - 3872 Pike Lake Motors
 - 3875 Guppy's Pike Lak 729-7100
 - 3878 Erickson Hugh G
 - 3881 Fisherman's Corne shop 729-5369
 - Van Valkenberg S
 - 3882 Daugherty's Pike 729-5091
 - 3884 Crossroads Clothin
 - 3885 Irving Marty Golf retail 729-6925
 - 3886 Paulson's Super V
 - 3888 Pike Lake Pharme
 - 3893 Grannys Corner re
 - 3895 Pike Lake Fuel 72
 - 3903 County Road & B: Dist Tool Hse) 72
 - 3904 Northern States S steel constn 729-6
 - 3913 County Land Dept 729-8480
 - 3944 Mc Keown Victor
 - 3947 Gamache Ray J ©
 - 3949 Gamache Gary ©
 - 3952 Anderson Louis A
 - 3958 Hage Mark N ©
 - 3960 No Return
 - 3964 Nesgoda Clarence
 - 3968 Zuhars Raymond I
 - 3970 Johnstone Edwin (
 - 3974 Frestedt Wm G ©
 - 3978 Carlberg Dean L (
 - 3981 Golen Leonard L (
 - 3984 Fietek Michl J ©
 - 3994 No Return
 - 3995 Sandstrom Turre /

SILVERNESS
PLUMBING, HEATING AND EXCAVATING, INC.
 (218) 722-0880
 Don Silverness 727-4465, Donnie Silverness 722-8274

1985
 City
 Directory
 TV
 110 E. 1st STREET (DU



**Blue Shield
Blue Plus**
of Minnesota

722-3371 OR 722-4685

405 W. Superior St.

MILLER TRUNK HWY—Contd

- 5195 Edstrom Al E ● 729-9725
- 5205 Dahl Beatrice C ● 729-9206
- 5211 Anderson Virginia R Mrs ● 729-6056
- 5219 United Truck Body Co Inc 729-6000
- 5225 Galleria Sales bicycle sls & serv 729-9704
- 5237 Vacant
- 5241 Skarp Ruth C ● 729-6998
Carson Joan M ●
- 5249 Johnson Ethel B Mrs ● 729-7716
- 5270 Wargin Richd O ● 729-6353
- 5265 Sullivan Beatrice M Mrs ● 729-6615
- 5281 Van Reese Richd V ● 729-7519
- 5298 Gallagher's Efficiency Apartments 729-5636
Gallagher Hugh C ● 729-5636
101 Odden Jeffrey D
102 Paszak Dale B
103 Vacant
104 Mc Donald Darrell R 729-9661
105 Serendinski John J 729-7674
1 Jieswietter Steve
2 Kramer Tony
3a Wood Steph R 729-9238
3b Skurla Michl
4 Olsen Richd R 729-5185
5a Nelsen Evelyn M Mrs 729-8354
3 Neff Elrose 729-9895
- UGSTAD RD INTERSECTS
LA VAGUE BY-PASS INTERSECTS
- 5285 Miller Trunk Veterinary Clinic 729-7959
- 5320 Mc Kinnon Brothers Auto Parts 729-8393
- 5313 Smitty's Automotive repr
- 5330 Apartments
Lower Vacant
Upper Ruse Debra A 729-5336
Leisure Distributing Inc hot tubs & spas 729-5060
- 5315 Gopher Oil Co 729-9600
- 5334 Tubby Checker Pool & Spa Center 729-7414
- 5340 Lucky's Sales & Service Inc automotive repr-wrecker serv 729-7397
Ahlers Wm P ● 729-7397
- 5350 Minnesota Outdoor Recreation garden-marine lawn implements 729-6982
- 5391 Economy Garages Inc 729-5106
- 5396 Peterson Doloris M ●
- 5398 Lundgren Jack L ● 729-7174
- 5405 Carlson Harold J 729-7109
- 5409 Wittenborg Andrew W 729-6620
- 5433 Prop Shop propeller reprs 729-8304
Hoglund Eric S ● 729-9858
- 5454 Grace Lutheran Church 729-9054
Early Childhood Family Education 729-9563
- 5480 Mc Donald Myron M ● 729-5854
- 5488 Mc Donald John E 729-6405
- 5493 Food N Fuel convenience store 729-8256
- 5492 Heide Kimberly A 729-6993
- 5497 Northern Fabrication Fire Apparatus & Equip Inc 729-8207
- 5498 Dougherty Thos A ● 729-7379
- 5541 No Return
- 5545 Mc Govern John D ● 729-9683
- 5560 Nygaard Mark K 729-7955
- 5557 B & G Outboard 729-8400
- 5572 Arrowhead Concrete Works 729-8274
- 5567 Herb's Supply 729-8276
Merritt Herbert H ● 729-8276
- 5573 Tafs Bradley G ● 729-5640
- 5580 Hanson Adam P 729-7810

- 5585 Carlson Clara E ● 729-8929
- 5589 Stevenson Philip G ● 729-7041
5691 Vacant
- 3781 Severance James F ● 729-6725
VAUX RD INTERSECTS
- 5601 Pike Lake Super America gas sta 729-5084
Maple Hill Meats 729-6917
Dave's Pizza & Sub Shop-Pike Lake restr 729-7704
U S Postal Station (Pike Lake Br) govt ofc 729-5084
- 5612 Vacant
- 5616 Watsick Motors used autos 729-5442
- 5620 Mister Qwik Wrench rv sls & serv 729-5196
- 5624 Tammen Dennis R 729-9129
- 5625 Tihl Dale A ● 729-6981
- 5632 Larson C David ●
- 5638 Pliml Barbara B ● 729-7238
- 5640 Pliml Deal A ● 729-8921
Under Lock & Key mini-storage 729-5360
- 5646 Wahlberg Dean S ● 729-5360
- 3853 Luoma Raymond R ● 729-8015
- 5660 Vacant
- 5661 Adams K A ● 729-8569
- 5666 Carsrud Norma E ● 729-8453
- 5668 Jackson Bruce A ● 729-6028
SATHERS DR INTERSECTS
- 5663 Pike Lake Chiropractic 729-8936
Hady Jeffrey F chiro 729-8936
- 5670 Pike Lake Professional Building 729-7270
Pike Lake Dental Health Center dentists 729-7270
Johnson Carter F dentist 729-7270
Somrock Jeffrey K dentist 729-7270
Insurance Capitol The 729-5226
- 5672 Pike Lake Motors auto dlrs 729-8258
- 5671 Country Cafe restr 729-7100
- 5678 Erickson Hugh G ● 729-7198
- 5675 Fisherman's Corner The bait tackle shop 729-5369
- 5684 Daugherty's Pike Lake Hardware 729-5091
- 5686 Vacant
- 5687 Irving Mary Custom Club golf sup whol 729-6925
Alternative Communications sls & repr elec goods 729-5074
- 5698 Paulson's Super Valu gro 729-7364
- 5688 Pike Lake Pharmacy Inc 729-6464
- 5692 Pike Lake Video rentals 729-9123
Pike Lake Dairy Queen restr 729-8756
- 5693 Grannys Corner restr & bar 729-5057
- 5694 Saginaw Construction Inc genl contrs
- 5699 Pike Lake Amoco 729-5689
- 5700 Northern States Steel Builders Inc steel constn 729-6543
- 5702 Arrowhead Economic Opportunity Agcy (Field Ofc) 729-5509
- 5713 County Land Dept (Area Ofc) 729-8480
- 5718 American Plywood Association test & insp agcy-wd prods 729-5703
- 5740 Mc Keown Victor H ● 729-8231
- 5743 Kscicinski Jean M ● 729-6391
- 5751 Gamache Gary R ● 729-6795
- 5754 Anderson Louis A ● 729-7928
- 5758 Anderson F Robt ● 729-6867
Anderson F Robt public acct 724-8888
- 5760 Vacant
- 5766 Nesgoda Clarence D ● 729-6758
- 5768 Wolter Steven M ● 729-7708
- 5774 Johnstone Edwin ● 729-8201
- 5776 Frestedt Wm G ● 729-9462

- 5778 Carlberg Dean L ● 729-7001
- 5785 Golen Leonard L ● 729-7849
- 5784 Fietek Michl J ● 729-7007
- 5790 No Return
- 5791 No Return
- 3998 Johnson Oscar R ● 729-8952
DANIELS RD INTERSECTS
- 5802 Hedburg Robt P ● 729-6253
- 5808 Vacant
- 5815 Brekke John ● 729-7305
- 5818 Pinther Donald E ● 729-6531
- 5821 Lyons Owen M ● 729-7557
- 5826 Amendola Frank S ● 729-8366
- 5831 Spicer Diane R ● 729-7186
SOUTH SHORE DR INTERSECTS
- 5834 Godmare Wm L ● 729-7850
- 5838 Mortinsen Clyde E ● 729-9121
- 5844 Mc Donald Leo J ● 729-7422
Lisnak Roxanne 729-5245
- 5852 Garrick Emmett M ● 729-5906
- 5853 Hinnenkamp Steven M ● 729-8994
- 5859 Dunaisky Edw L ● 729-8076
- 5864 Adamich Ronald P ● 729-7287
- 5870 Vacant
- 4086 Hughes Mary O ● 729-6279
- 5886 Pappas Gene R ● 729-9081
- 5880 Campbell's Pike Lake Motel cabin rentals
Cabins
1 Vacant
2 Vacant
3 Vacant
4 Vacant
5 Vacant
6 Vacant
7 Vacant
8 Vacant
9 Vacant
10 Vacant
11 Vacant
12 Vacant
13 Vacant
- SOLWAY RD INTERSECTS

**MILWAUKEE AV -FROM W AUSTIN
NORTH 6 WEST OF WOODLAND AV**

- ZIP CODE 55803
- NUMBERS IRREGULAR
- 4731 Udd John K ● 728-4950
- 15 Walker Scott 724-4107
- 4721 Carlson Allan D ● 724-9359
- 4719 Crain Patk A ● 724-4015
- 4715 Beasley Richd E 724-2714
- 4709 Robison Scott D 724-4411

**MINERAL ST -FROM PLEASANT AV
WEST 2 NORTH OF BOULEVARD**

- ZIP CODE 55810
- 7416 Grage Suzanne M
- 7430 Bangsund Wm M 628-2455

**MINNEAPOLIS AV -FROM 2700
WOODLAND AV NORTH**

- ZIP CODE 55803
- 6★Nelson Scott G 724-1293
- 10★Dougherty Bill ●
- 18 Mellin Peter R ● 724-3657
- 20 Doty Gary L ● 724-2683
- 21 Ross Floyd H ● 728-2487
- 22 Hillman Eric D 724-6801
- 24 Wolleat Richd J ● 728-1338

All New in 1990: 102 New Rooms, Suites, Domed Pool and Recreation Area
LONDON RD., DULUTH
(218) 728-3601, 1-800-777-7925



Bergson
Realty Services
1726 LONDON RD.
DULUTH 55812
218-728-6843

B

BLOOD DONORS, INC.

Suite 110, Amendola Building • 405 East Superior Street
Duluth, Minnesota 55802 • 218-722-7401 • FAX 218-722-2997

Independent
Insurance
Agent
55807

1990
City
Directory



MILLER TRUNK HWY (H) cont'd
 SKYLINE BOWLING LANES INC..... 727-8555
 SKYLINE LOUNGE..... 727-9179
 4891 WOODRIDGE BUILDING
 Suites Irregular
 101 HERMANTOWN DENTAL ASSOCIATES
 722-7770
 101 IDZIOREK ROBT J dentist..... 722-7770
 103 SUPERIOR AIR air filtration sys
 722-0003
 SUPERIOR AIR addl space
 200 AMERICAN FAMILY INSURANCE
 727-7080
 102 HERMANTOWN CHIROPRACTIC
 CLINIC 723-1291
 102 TOMANEK TERESA M chiro..... 723-1291
 203T JEANETTE TRAVEL ravel agcy
 720-4838
 207 AMERICAN FAMILY INSURANCE ins
 agcy 722-6313
 208 SMALL BUSINESS SERVICES &
 CONSULTANTS busn servs & income
 tax prep 726-0721
 204 SLEEK DESIGN int dsgnrs..... 723-1993
 206 B S I OF DULUTH (B E A M-T V)
 wireless subscription t v 722-4760
 205 Not Verified
 4899 GORDY'S FARM MARKET & GIFT SHOP
 produce-ret & gift shop..... 722-8666
 • **STERNER RD INTERSECTS**
 4910 ARROWHEAD WINDOW & DOOR CO INC
 windows & doors 729-9000
 HERMANTOWN HYDRAULICS hydraulic
 components 729-6812
 DULUTH INNER SPACE SCUBA CNTR
 diving equip 729-9028
 FILIPOVICH & ASSOCIATES appraisals
 729-9493
 REALTY RESOURCES real est conslts
 729-9493
 4904 AUTO LUBE auto lubrication 729-8227
 4908 ATTRACTIONS HAIR DESIGN..... 729-6670
 4912* Holly Elmer L Jr & Susan M
 729-5150
 4918 R J SPORT & CYCLE rec sup sls & servs
 729-5150
 4945 BULLYAN RECREATION CENTER. 729-9111
 • **BIRCHWOOD DR INTERSECTS N**
 4955* Retzlaff Dean D & Kim K..... 729-0172
 4956 BULLYAN MOBILE HOMES..... 729-9143
 BIRCHWOOD MOBILE ESTATES..... 729-9143
 4970 Forcell Merlin V & Diane M [M] [C]..... 729-5595
 Poissant Michael J & Kristi M [M]..... 729-5595
 4995 CURTIS OIL CO..... 729-8241
 CURTIS TIRE CO..... 729-8241
 4991 MILLER TRUNK FOOD & FUEL..... 729-7993
 4978 EASY HOUSING OF DULUTH INC
 mobile
 & modular home sls..... 729-8001
 4997 FOOD N FUEL (busn ofc)..... 729-5500
 5002 AIRLINER MOTEL..... 729-6628
 Cozzi Frank [M] [C]..... 729-6628
 5010 BILLMAN HOME CNTR bldg center
 729-8232
 BILLMAN REALTY..... 729-7567
 BILLMAN CONSTRUCTION INC genl contr
 729-7570
 5014 KOLAR-BUICK G M C INC auto sls
 729-7668
 5018 U M D natural res resear institute. 720-4294
 • **AIRPORT DR INTERSECTS N**
 5020 SKYLINE MOTORS INC used autos 729-9360
 5022 Frederick Herbert C [M] [C]..... 729-5892
 5028 Vacant
 5040 NORTHSIDE TRUCK SALES & SERVICE
 INC trucking-sl & serv 729-7315
 5038 PELLA WINDOW STORE OF DULUTH
 windows doors sunrms..... 729-7120
 5041 SCHOBER ROGER A cpa..... 729-9050
 5043 TURBO-DIESEL INJECTION SERVICE fuel
 injection repr 729-5366
 5048 Vacant
 5051 JAY EN OF DULUTH INC tel equip & sys-
 dtrs..... 729-9300
 5061 SECURITY STORAGE CO moving... 729-6116
 ALLIED VAN LINES..... 729-6116
 5065 MINERS INCORPORATED (corp ofc)
 729-5882
 5068 WATKINS PRODUCTS spices extracts clng
 prods 729-8589

MILLER TRUNK HWY (H) cont'd
 5071 MERRY MAIDS PROFESSIONAL HOME
 CLEANERS..... 729-9291
 5074 Johnson Paul N & Gladys L [M] [C]..... 729-9213
 5082 LAKELAND CAMPERS whse
 5083 CUSTOM COACH AUTO BODY collision rpr
 cntr..... 729-5554
 5086 MILLER TRUNK DENTAL BUILDING ofc
 bldg
 MC DONALD DUANE F dentist..... 729-9810
 DAHLGREN STEPH G dentist..... 729-9810
 5092 Vacant
 5094 SPA LAND spas & hot tub sls..... 729-7727
 ELECTRONICS electronic repr..... 729-6970
 5085 LAKELAND CAMPERS r v's & trk
 accessories..... 729-0284
 5087 HERMANTOWN RADIATOR..... 729-6717
 5097 HERMANTOWN SERVICE CENTER
 729-5189
 • **LA VAGUE RD INTERSECTS S**
 5106 SAMMY'S PIZZA restr..... 729-7227
 HERMANTOWN SPUR gas eta & convenience
 store 729-7227
 5116 HERMANTOWN FEDERAL CREDIT UNION
 729-7733
 5105 Office Building
 1 SCRATCH DOCTOR THE
 1 FINISHING TOUCH
 103 WOOD MAGIC INC addl space
 1 Mahke Chris
 2 Stromness Rebecca A [M]..... 729-7714
 D B ENTERPRISES antique shop..... 729-5956
 LINDA'S POOCHIE PARLOR dog groomers
 729-6404
 102 WOOD-MAGIC INCORPORATED gift
 shop 729-7175
 5118 Blaede Stephen W & Rosemarie A [M] [C]
 729-6250
 5109 BENSON TRAILER COURT recreation trlrs
 729-5087
 5115 Buerke Douglas C & Jody L [M] [C]..... 729-5087
 Buerke Peter D [M]..... 729-5087
 Buerke Michael Todd..... 729-5087
 5131 Knobel Richard W & Deborah J [M]..... 729-7004
 5147 TODD SIGNS sign fab-instlr..... 729-6800
 5141 Johnson E Todd & Janice M [M] [C]..... 729-9668
 5150 EDGETOWN MOTEL..... 729-9806
 5155 Berntsen Raymond E [M] [C]..... 729-9381
 5161 Carlson Bertil C & Virginia D [M] [C]..... 729-6018
 5169 Berntsen Walter M & Elsie V [M] [C]..... 729-9274
 • **COURTLYN LA INTERSECTS S**
 5152 BROWN'S TRAILER COURT..... 729-8571
 Brown Harry & Anna M [M] [C]..... 729-8571
 5187 Herrick George W & Arlaine [M] [C]..... 729-6763
 5195 Edstrom Al E & Marcella M [M] [C]..... 729-9725
 5205 Vacant
 5211 Anderson Terri L
 5219 UNITED TRUCK BODY CO INC..... 729-6000
 5225 GALLERIA SALES bike sls-serv woodwk &
 crafts..... 729-9704
 5237 MAPLE HILL PROFESSIONAL CENTER ofc
 bldg
 INDEPENDENT ORDER OF FORRESTERS f
 i c-lutdf 729-8882
 UNIVERSAL FITNESS CNTR..... 729-8888
 5237-5241 Vacant (3 Hoes)
 5241 Carson Joan M [M] [C]..... 729-7716
 5249 Johnson Ethel B [M] [C]..... 729-7716
 Johnson Verner R [M]..... 729-7716
 5270 Wargin Richard O & Beverly J [M] [C]
 729-8353
 5265 Sullivan Beatrice M [M] [C]..... 729-8615
 5281 Van Reese Richard V & Sally A [M] [C]
 729-7519
 5298 GALLAGHER'S EFFICIENCY APARTMENTS
 729-5636
 Gallagher Hugh C & Catherine R [M] [C]
 729-5636
 101 Bullyan Jody [M]
 102 SUNRISE DRYWALL drywall contr
 729-6230
 102 Peters Raymond & Carol L [M]..... 729-6230
 103* Frey Craig..... 729-0064
 104 Deers Robert [M]
 105-2 Vacant (3 Apts)
 3* Sehne Gary D..... 729-0460
 3A Vacant

MILLER TRUNK HWY (H) cont'd
 3B* Surla Michael
 4 Olsen Richard R [M]..... 729-5185
 5A Nelsen Evelyn M [M]..... 729-8354
 5285 MILLER TRUNK VETERINARY CLINIC
 729-7959
 • **LA VAGUE BY-PASS INTERSECTS N**
 • **S UGSTAD RD INTERSECTS**
 • **ROSE RD INTERSECTS SW**
 • **UGSTAD RD INTERSECTS**
 • **LA VAGUE BY-PASS INTERSECTS**
 • **ROSE RD INTERSECTS**
 5315 SMITTY'S AUTOMOTIVE auto repr 729-7541
 5317 Vacant
 5320 MC KINNON BROTHERS AUTO PARTS
 729-8393
 5330 Overlie Daniel & Mary [M]
 5334 LEISURE DISTRIBUTING INC hot tubs &
 spas..... 729-5060
 TUBBY CHECKER POOL & SPA CENTER
 729-7414
 5340 LUCKY'S SALES & SERVICE INC
 automotive repr-wrecker serv..... 729-7397
 Buchman Daniel J [M]..... 729-9709
 BREANNA & ASSOCIATES beauty shop
 729-7300
 T G C SERVICES roofing contr..... 729-6731
 5350 MINNESOTA OUTDOOR RECREATION
 garden-marine lawn implements..... 729-6982
 5389 ECONOMY OVERHEAD DOOR OF
 DULUTH INC garage doors..... 729-9608
 5391 ECONOMY GARAGES garage bldrs. 729-5106
 • **ABRAHAMSON RD N INTERSECTS**
 5396 Vacant
 5398 Lundgren Jack L & Tootie [M] [C]..... 729-7174
 5400 MILLER HILL STEEL steel fab..... 729-7675
 5405 Henckley Richard E & Jeanne M [M]
 729-5413
 5413 Lemon Thomas M & Leslie
 5433 PROP SHOP boat propeller reprs..... 729-8304
 Hoglund Eric S & Nancy J [M] [C]..... 729-9858
 Hoglund Brett E [M]..... 729-9858
 5454 GRACE LUTHERAN CHURCH..... 729-9054
 EARLY CHILDHOOD FAMILY EDUCATION
 729-9563
 HERMANTOWN PRESCHOOL PROGRAMS
 729-5748
 5468 MAC'S LANDSCAPING CENTER retail sls &
 contrs 729-6203
 5480 Mc Donald Myron M & Dorothy M [M] [C]
 729-5854
 5488 Not Verified
 5493 JUNCTION FOOD N FUEL convenience
 store-gas sta 729-8256
 5492 Vacant
 5497 RADCO TOPPERS & TRUCK
 ACCESSORIES sls & repr..... 729-5792
 • **LINDAHL RD INTERSECTS**
 • **MN HWY 194 INTERSECTS**
 5544 Sanders Terry [M]..... 729-6141
 5545 Mc Govern John D & Helen C [M] [C]
 729-9683
 Mc Govern Amanda M..... 729-9683
 5560* Doyle Patrick J & Cathie F..... 729-5349
 5557 B & G OUTBOARD sls & serv..... 729-8400
 5572 ARROWHEAD CONCRETE WORKS concrete
 products..... 729-8274
 5567 Vacant
 5567 Merritt Muriel F [M] [C]..... 729-8276
 5573 Not Verified
 5580 Vacant
 5585 Carlson Clara E [M] [C]..... 729-8929
 Carlson Mary E [M]..... 729-8929
 5589 Stevenson Philip G & Eula M [M] [C]..... 729-7041
 5595 Severance James F & Ruth A [M] [C]..... 729-6725
 5597 PLASTIC WELDING & FABRICATION OF
 DULUTH plastic repr..... 729-9276
 • **VAUX RD INTERSECTS N**
 5601 PIKE LAKE SUPER AMERICA convenience
 store-gas sta 729-5084
 MAPLE HILL SMOKEHOUSE & MEATS
 729-6917
 DAVE'S PIZZA & SUB SHOP-PIKE LAKE
 restr 729-7704
 U S POSTAL SERV pike lk br 729-5084
 5612 1 ROUFS COLOR CONCEPTS custom
 draperies blinds..... 729-6920
 ROUFS CLEANING CONCEPTS jan servs &
 coml res carp clng 729-6920

DAVID A. RAIMO SR., Agent
 Auto - Life - Health - Home and Business
 1605 Woodland Ave., Duluth, MN 55803
 Phone: Bus. 218-728-6419

3020 W. Superior St.
 Harbor City Oil
 Kolquist Bros., Owners
 218-624-3633
 Duluth MN 55806
 1995 City Directory

MILLER TRUNK HWY Cont'd
 2574 Loftquist Mike [3]218-729-3397
 2575 JAYEN OF DULUTH INC radio communication equip/sys218-729-9300
 2576 MINER'S INC grocers-retail218-729-5882
 2577 Bures Dale V & Grace E [16]218-729-9829
 2578 2ND WIND EXERCISE EQUIPMENT exercise equip- retail218-729-7700
 2579 Mahai Collin R [9]218-729-7700
 2580 STEPPING STONES FOR LIVING social serv & welfare org218-727-7450
 2581 COLIN'S COLLISION REPAIR auto body- rpr & painting218-729-6187
 2582 HERMANTOWN FRAME & ALIGNMENT wheel alignment- frame & axle218-729-0010
 2583 CUSTOM COACH COLLISION REPAIR auto body- rpr & painting218-729-5554
 2584 CELLULAR COMMUNICATIONS cellular telephones218-729-4884
 2585 FAST LINE GRAPHIX banners218-729-9150
 2586 DAHLGREN STEPHEN G DDS dentists218-729-9810
 2587 MC DONALD DUANE F DDS dentists218-729-9810
 2588 McDonald Dale R & Duane F [9]218-729-9810
 2589 TUBE 'N' HOSE FABRICATION hose & tubing- rubber & plastic218-729-5746
 2590 Parke Kevin R218-729-5189
 2591 TOTAL TAN tanning salons218-729-5746
 2592 HERMANTOWN SERVICE CTR auto rpr & serv218-729-5189
 2593 U-HAUL CO truck renting & lease218-729-4954
ZIP CODE 55811 CAR-RT C040
 2594 AUTO DENTS SPECIALISTS auto body- rpr & painting218-343-7000
 2595 Jankowski Steven & Tina218-729-9367
 2596 MULTI SPECIES FISHING ADVNTRS fishing parties218-343-7000
 2597 PARK BENCH seafood-retail218-729-5087
 2598 WOOD MAGIC KITCHEN CABINETS gift shops218-729-7175
 2599 Hermantown Spur [4]218-729-7227
 2600 SAMMY'S PIZZA & RESTAURANT pizza218-729-7227
 2601 Anderson David218-729-8209
 2602 Erickson Thomas L [7]218-729-5803
 2603 Gorny Edward [8]218-729-8723
 2604 KPARK RV CAMPING recreational vehicle parks218-723-1616
 2605 Loystad Marvin [7]218-729-0928
 2606 HERMANTOWN LIQUOR liquors-retail218-723-1616
 2607 ATLAS ALARMS burglar alarm sys218-729-4625
 2608 Wilson Lane D [2]218-729-4625
 2609 Wilson Stacy J218-729-4625
 2610 Bender Debrah L218-729-4625
 2611 Bender Debbie L218-729-4625
 2612 Johnson Janice M & Todd [16]218-729-9668
 2613 Johnson Elliot T [1]218-729-6800
 2614 TODD SIGNS signs218-729-6800
 2615 EDGE TOWN MOTEL hotels & motels218-729-9806
 2616 Bemisen Raymond E [21]218-729-9381
 2617 BUSINESS & ESTATE PLANS INC financial advisory serv218-722-8248
 2618 FIRST ASSOCIATED INVESTMENT financial planning consultants218-722-8248
 2619 Teberg Curtis A [8]218-722-8248
 2620 No Current Listing
 2621 ROUFS CLEANING CONCEPTS janitor serv218-729-6920
COURTYN LN INTERSECTS
 2622 MILLENIUM PUBLISHING publishers218-729-4423
 2623 TATTLETALE GOLF wholrs218-786-0314
 2624 Edstrom Al [21]218-729-9725
 2625 FURNACE FACTORY furnaces-heating218-729-0333
 2626 L & S PLUMBING & HEATING INC plumbing contractors218-729-0392
 2627 Landacky Joseph P [7]218-729-5161
 2628 UNITED TRUCK BODY CO truck canopies, caps & shells218-729-6000
 2629 GALLERIA SALES bicycles-dftrs218-729-9704
 2630 GALLERIA WOODWORKING SPECS woodworkers218-729-9704
 2631 McVean Robert W [9]218-729-6370
 2632 NORTH COUNTRY CHIROPRACTIC CTR chiropractors dc218-729-6370
 2633 GBIN INVESTMENTS & CONSULTING investments218-729-1511
 2634 TERRAZZO & CONCRETE REPAIR INC

MILLER TRUNK HWY Cont'd
 2585 MILLER TRUNK VETERINARY CLINIC veterinarians218-729-7959
+ UGSTAD RD INTERSECTS
 25298 Bush Jody [3]218-729-8354
 Nelsen Evelyn M [16]218-729-8354
+ ROSE RD INTERSECTS
 5315 KENLOR USED FURNITURE furniture-used218-729-8641
 5320 LINE-X MIDWEST coatings- protective-mfrs218-729-6194
 5322 DULUTH READY MIX INC concrete contractors218-722-5547
 5330 No Current Listing
 5340 LUCKY'S MINI STORAGE storage-household & commercial218-729-7399
 LUCKY'S SALES & SVC auto rpr & serv218-729-7399
 5350 LAKE COUNTRY RECREATION INC boat dfrs sales & serv218-729-6982
 MR QWIK WRENCH YOUR RV CTR nonclassified establishments218-729-5196
 5389 ECONOMY GARAGES garage builders218-729-5106
 ECONOMY MINI-STORAGE storage-household & commercial218-729-9846
 5391 TOMLINSON HOMES INC home builders218-729-4663
 5393 TAMARACK MATERIALS INC dry wall contrs equip/supl218-729-8075
 5398 Lundgren Jack L [13]218-729-7174
 5400 MILLER HILL STEEL INC steel-structural218-729-7675
 5405 - 5413 No Current Listing (2 Hses)
 5433 Hoglund Eric S & Nancy J [16]218-729-9858
 NORTHERN EXPOSURE docks218-729-6566
 PROP SHOP propellers-mfrs218-729-8304
 5454 GRACE LUTHERAN CHURCH churches218-729-9054
 5468 MAC'S LANDSCAPING CTR landscape contractors218-729-6203
+ LINDAHL RD INTERSECTS
 5480 McDonald Myron M & Dorothy M [16]218-729-5854
 5488 McDonald John E [16]218-729-6405
+ LINDAHL RD INTERSECTS
 5492 No Current Listing
 5493 HEARTH & HOME STORE fireplaces218-729-8256
 5497 RADCO TRUCK ACCESSORY CTR truck canopies, caps & shells218-729-5792
 5544 Sanders Terry C [16]218-729-6141
 5545 McGovern Helen C & John D [16]218-729-9683
+ VAUX RD INTERSECTS
 5567 No Current Listing
 5572 ARROWHEAD CONCRETE WORKS INC concrete- ready mixed218-729-8274
 5573 No Current Listing
 5580 Ward Christophe T [9]218-729-0590
 5585 Carlson Mary E & Hjalmar C [16]218-729-8929
 5589 Stevenson Philip G Jr & Eula M [21]218-729-7041
 5595 No Current Listing
 5601 Curtis Frederick J & Joan L [10]218-729-8327
 PIKE LAKE SUPER AMERICA serv stations-gasoline & oil218-729-4773
 REPUBLIC BANK banks218-729-6970
 SUBWAY SANDWICHES & GALADS restaurants218-729-0199
 5606 ARROWHEAD CONSULTING & TESTING envrmtl & ecolgl serv218-729-0987
 5608 MERRY MAIDS INC house cleaning218-729-9291
 5610 LINDA'S POOCHIE PARLOR pet washing & grooming218-729-6404
 5612 GREAT NORTHERN LENDING real estate loans218-724-1177
 NORTH SHORE ANALYTICAL INC envrmtl & ecolgl serv218-729-4658
 4 GROUND EFFECTS EXCAVATING INC excavating contractors218-729-6466
 5614 TOWN & COUNTRY BUILDERS INC garage builders218-729-7887
 5620 HAPPY DAYS RV INC recreational vehicles218-729-0044
 5624 Planting Gregory J & Kathleen L218-729-4891
+ OLD MILLER TRUNK HWY INTERSECTS
 5625 Tilli Dale A [16]218-729-6981
 5628 Osberg Lloyd218-729-6985
 5630 Larson Carl D & Nancy J [14]218-729-5338
 5632 No Current Listing
+ SEVILLE RD INTERSECTS
+ MIDWAY RD INTERSECTS

MILWAUKEE AVE Cont'd
+ E CALVARY RD INTERSECTS
 HOUSEHOLDS 6
MINE RD (ELY)
 • ZIP CODE 55731 CAR-RT H003
 154 Brooks Kimberly A [9]218-365-4551
 178 Rozman Mary A & Daniel F [9]218-365-4583
 180 - 184 No Current Listing (2 Hses)
 HOUSEHOLDS 4
MINERAL ST (DULUTH)-FROM 2499 GETCHELL RD WEST
 • ZIP CODE 55810 CAR-RT C037
 7416 No Current Listing
 7430 Bangsund William M Jr [27]218-628-2455
 Bangsund Isabelle218-628-2455
 HOUSEHOLDS 2
MINI POWER RD (DULUTH)-FROM 4901 LOCKWOOD LN
 • ZIP CODE 55803 CAR-RT R004
 4930 No Current Listing
 4938 Jezierski Daniel J [7]218-729-6143
 HOUSEHOLDS 2
MINK RD (COTTON)-FROM 6499 COMSTOCK LAKE RD NORTH
 • ZIP CODE 55724 CAR-RT H001
 9340 Van Evera Katharine [9]218-482-5241
 9379 No Current Listing
 HOUSEHOLDS 2
W MINK RD (COTTON)-FROM 1255 BLACKBURN DR NORTHEAST
+ CAMERON DR BEGINS
 • ZIP CODE 55724 CAR-RT H001
 1163 Proshok Robert218-482-3208
 Proshok Pat218-482-3208
 1168 PIKE & PIKE nonclassified establishments218-482-5252
 1182 Musburger Jeffrey M & Rebecca R [11]218-482-3737
 1185 Seward Jeannette P [13]218-482-5243
 1190 Bohren Calvin [3]218-482-5536
 1198 Averill Harland R & Janet S [7]218-482-3768
 1202 Christensen Brian D [13]218-482-3682
 1206 Dulinski Jeffery D & Shauna L [16]218-482-3646
 1214 No Current Listing
 1222 Noyes Vernon D & Ilene B [12]218-482-3312
 1224 Houle Jason A [3]218-482-3311
 1228 Hayes Jane [9]218-482-3311
 1230 Mercier Dennis J [6]218-482-5256
 1286 No Current Listing
 1288 Maher Betty J [13]218-482-3646
 Maher Roger L
+ BLACKBURN DR INTERSECTS
+ N WATER HEN RD ENDS
 BUSINESSES 1 HOUSEHOLDS 14
MINK LAKE RD (GRAND MARAIS)
+ TROUT LAKE RD CONTINUES
MINK RANCH RD (TOFTE)
 • ZIP CODE 55615 CAR-RT H003
 279 Hughes William J & Margaret [2]218-663-7970
 HOUSEHOLDS 1
MINNEAPOLIS AVE (DULUTH)-FROM 299 E FARIBAULT ST NORTH
+ WOODLAND AVE CONTINUES
 • ZIP CODE 55803 CAR-RT C038
 6 Bubar Ronald218-728-2884
 10 No Current Listing
 18 Stafne Thomas E [13]218-728-2884
 20 Lautzenhelsler Karl L & Jolaine C [3]218-724-3849
 21 Zbaracki Thomas J Jr & Mary A [13]218-724-4992
 22 Thlede Christophe R & Kathleen M218-525-1576
 24 Fuller Kathryn W [9]218-724-4508
 26 Worsfold Jason M [2]218-728-7902
 29 Bushnell Timothy J & Valerie J [26]218-724-5651
 34 Wronka Hans A & Reva [4]218-728-3967
 35 Greske David G218-724-5651
 38 Zorbas John F [26]218-728-3967
 43 Cohen Claudia L [24]218-728-3967
 44 No Current Listing
 102 Leino William M [4]218-728-2673
 Leino Anne218-728-2673
 109 Pell Louise A [17]218-724-0644
 114 No Current Listing
 115 Solberg Molly A [7]218-724-8473
 Solberg Shannon D218-724-8473
 119 Broman Paul K & Kari218-724-5065
 DeBoer Patrick J218-724-5065
 122 Ellingson Craig R & Barbara J [35]218-724-7220

MINNEAPOLIS AVE Cont'd
+ OSAKIS ST INTERSECTS
 301 Langenbrunner Susan M [13]218-7-302
 302 Holvik Egil & Gudrun S [30]218-7-305
 305 Diefenbacher Timothy L [22]218-7-306
 Diefenbacher Ruth L
 306 No Current Listing
 309 Halligan Linda J [23]218-7-310
 Halligan Barbara J
 310 Simmonds Jay E & Patrice M [11]218-7-313
 No Current Listing
 314 Grundtner Timothy B & Amy [9]218-7-318
 Beilke Joel R [5]218-7-321
 Johnson Julie A [5]218-7-321
 Wittich Glenn C & Norma J [2]218-7-401
+ ISANTI ST INTERSECTS
 401 FIRST ORIENTAL GROCERY oriental g Park John H [10]218-7-402
 Dunphy Bonnie L [10]218-7-409
 Irgang Nicole [3]218-7-415
 McDonnell Julie A [7]218-7-416
 Thistle Scott B [3]218-7-418
 Gunderson Joseph T & Kristy [3]218-7-419
 Campbell Kristen L218-7-422
 Velner Elizabeth A [5]218-7-422
 Stahl Phillip M [4]218-7-422
 Stahl Randolph M218-7-422
+ E ANOKA ST BEGINS
+ E ANOKA ST CONTINUES
 • ZIP CODE 55803 CAR-RT C041
 508 Thomson Robert W & Susan M [17]218-7-517
 Higgins Robert M [44]218-7-519
 Zabrocki Harry F & Pamela [21]218-7-602
 Broman Frederick J & May J [27]218-7-608 - 618
 No Current Listing (3 Hses)
+ BELLIS ST BEGINS
 701 Erickson Dean R & Mary C [13]218-7-710
 Edmunds Ryan G & Gwendalyn M [12]218-7-716
 Wettlaufer Janet L [2]218-7-717
 Kalland Roger O & Marilyn R [36]218-7-806
 Smith James R [43]218-7-816
 Williams Jack K [5]218-7-818
 Madson Michael C [5]218-7-901
+ E MANKATO ST ENDS
 901 McRandle Carol [17]218-7-906
 Furchert Michael [4]218-7-918
 Overland Rebecca L218-7-1005
 Klasnya Betty J [35]218-7-1006
 Chiodi Jeffrey J & Lisa A [14]218-7-1015
 No Current Listing
 1016 Holmstrom Eric R [2]218-7-1104
+ E OWATONNA ST INTERSECTS
 1104 Kovach David J [10]218-7-1107
 Spearman Matthew218-7-1110
 Perrett Brad W & Leslie D [15]218-7-1117
 No Current Listing
+ E FARIBAULT ST INTERSECTS
 1202 Teske William K [20]218-1204
 Linn Patrick A & Michelle R [8]218-1206
 Bemison Julian H [59]218-1207
 Stepan Clarence N [26]218-1215
 Carlson Helmer B [44]218-1302
+ E FARIBAULT ST INTERSECTS
 1302 Hooey Kim G & Michelle A [23]218-1309
 Daw Bruce K & Celeste A [14]218-1312
 No Current Listing
 1313 Harris Glenn L [36]218-1401
 Kuehl Douglas W & Meredith J [28]218-1414
 Belera Claire C [40]218-1415
 Belera Gina R218-1415
 Mlemckl Michael S & Cynthia C [33]218-1503
 Wendinger Patricia J & Michael J [2]218-1504
 Riggler Dirk D & Daphne A [11]218-1511
 Perrella Terry J [12]218-1608
 Perrella Alex218-1611
 Dahlquist Rodney S & Janine C [21]218-1814
+ E CHISHOLM ST CONTINUES
 • ZIP CODE 55803 CAR-RT C043
 1814 Christensen Thomas E & Patricia R [1]218-

NEW NEIGHBOR

MILLER TRUNK HWY - MINNEAPOLIS AVE

MILLER TRUNK HWY Cont'd

5046 No Current Listing
 5051 DULUTH ELECTRICAL CONTRNG INC electric contractors
218-724-5566
 LADYBUGS QUILT SHOP quilting materials & suppl
218-729-7801
 5065 MINER'S INC grocers-retail
 White Sue218-729-5882
 5068 Bures Dale V & Grace E [20] ▲
 5071 2ND WIND EXERCISE EQUIPMENT exercise equip- retail
218-729-7700
 5074 No Current Listing
 5075 STEPPING STONES FOR LIVING social serv & welfare org
218-727-7450
 5082 COLIN'S COLLISION REPAIR INC auto body- rpr & painting
218-729-6187
 HERMANTOWN FRAME & ALIGNMENT wheel alignment- frame
 & axle218-729-0010
 5083 CUSTOM COACH COLLISION REPAIR auto body- rpr & painting
218-729-5554
 5085 FASTLINE GRAPHIX banners218-729-9150
 MERRY MAIDS house cleaning218-729-9587
 5086 McDonald Duane F [9]218-729-9810
 McDonald Dale R218-729-9810
 MILLER TRUNK DENTAL dentists218-729-9810
 5087 ABS AUTO SOLUTIONS glass218-722-8713
 5094 A LE SALON beauty salons218-729-6367
 DO NORTH PIZZERIA pizza218-729-1800
 LANDING 53 bars218-729-5399
 MET LIFE insurance218-722-1676
 NORTH COUNTRY DRY CLEANERS cleaners218-729-8995
 POTTERY BARN furniture-dirs- retail218-729-0400
 REPUBLIC BANK banks218-729-6970
 SWARD CHRIS insurance218-733-3935
 TOP DOG BOUTIQUE dog breeders218-729-5511
 TOTAL TAN tanning salons218-729-5746
 5097 HERMANTOWN SERVICE CTR auto rpr & serv
 ZIP CODE 55811 CAR-RT C040218-729-5189
 5105 AUTO DENTS SPECIALISTS auto body- rpr & painting
218-343-7000
 MULTI SPECIES FISHING fishing parties218-348-7001
 Peizel David A & Lynn M [7]
 WOOD MAGIC KITCHEN CABINETS cabinets-mfrs
218-729-7175
 5106 HERMANTOWN SPUR serv stations- gasoline & oil
218-729-9883
 SAMMY'S PIZZA pizza218-729-7227
 5109 Erickson Thomas L [11] ▲
 5115 HERMANTOWN LIQUOR liquors-retail218-723-1616
 5116 GENERAL SECURITY SVC CORP security guard & patrol serv
218-726-1606
 5118 - 5131 No Current Listing (2 Hses)
 5141 Johnson Todd T [18] ▲218-729-9668
 Johnson Elliot T218-729-9668
 5147 TODD SIGNS signs218-729-6800
 5150 EDGETOWN MOTEL hotels & motels218-729-9806
 Raulito Deb
 Seafolk Jessica
 Wilton Lloyd H
 5152 SHRINE OFFICE fraternal org218-722-7486
 5155 KANUIT & BRAY LTD attorneys218-722-7722
 Kanuit Robert R [2] ▲
 5161 BUSINESS & ESTATE PLANS INC financial planning consultants
218-722-8248
 FIRST ASSOCIATED INVESTMENT financial advisory serv
218-722-8248
 Teberg Curtis A [10] ▲218-722-8248
 TEBERG FUND investment securities218-722-8248
 5169 No Current Listing
 5187 ROUFS CLEANING CONCEPTS janitor serv
 + COURTLYN LN INTERSECTS218-729-6920
 5191 HERMANTOWN LASER WASH car washing & polishing
218-729-9285
 HERMANTOWN MOLDING & MILLWORK cabinels
218-729-5373
 QUICK GYM health clubs studios/gymnasium218-729-3291
 5193 PURE PLEASURE miscellaneous retail stores218-729-1500
 5195 Edstrom Aloarn E [31] ▲218-729-9725
 5205 FURNACE FACTORY heating equip & sys218-729-0333
 L & S PLUMBING & HEATING plumbing contractors
218-729-0392
 Thompson Chelsey [3]
 5211 A WORLD OF FISH pet shops218-729-5161
 5219 UNITED TRUCK BODY CO INC truck canopies, caps & shells
218-729-6000
 5225 Edstrom Aloarn E [31] ▲
 GALLERIA SALES bicycles-dirs218-729-9704
 5237 FITNESS EDGE OF MINNESOTA health clubs studios/
 gymnasium218-348-7631
 McVean Robert W [13]218-729-6370
 NORTH COUNTRY CHIROPRACTIC CTR chiropractors dc
218-729-6370
 ODIN INVESTMENTS & CONSULTING investments
218-729-1511
 ROSE-CARLSON HEATHER psychotherapists
 5238 CARPENTERS labor org218-724-3297
 JERRY A LANDER TRAINING CTR training programs & serv
218-729-9003
 NORTH CENTRAL STATES REGL training programs & serv
218-724-6573
 Wrazidlo Clayton
 5241 Wilson Lane D [3] ▲
 Wilson Theresa L

MILLER TRUNK HWY Cont'd

5285 MILLER TRUNK VETERINARY CLINIC veterinarians
218-729-7959
 Shirley Mike K [16] ▲
 5298 Maki Steven N
 Nelsen Evelyn M [20]218-729-8354
 Noring Alden A218-729-8841
 + ROSE RD INTERSECTS
 5315 KENLOR USED FURNITURE furniture-used218-729-8641
 5320 LINE-IT MIDWEST INC coatings- protective-mfrs218-729-6194
 5334 VINE CREATIONS wine makers' equip/supl218-279-2706
 5340 LUCKY'S MINI STORAGE storage- household & commercial
218-729-7399
 LUCKY'S SALES & SVC auto rpr & serv218-729-7399
 ROADSIDE AUTO SALES INC auto dirs-used cars
218-729-5162
 5350 VACUUM EXPRESS & CARPET OUTLET carpet & rug dirs- new
 5389 ECONOMY GARAGES garage builders218-729-5106
 ECONOMY MINI-STORAGE storage- household & commercial
218-729-9846
 Michelson David ▲
 5391 TOMLINSON HOMES home builders218-729-4663
 5393 TAMARACK MATERIALS NORTHLAND dry wall contrs equip/
 supl218-729-8075
 5398 Lundgren Tootie [51] ▲218-729-7174
 Lundgren Jack L218-729-7174
 5400 Miller James A [6] ▲
 5405 - 5413 No Current Listing (2 Hses)
 5433 Hoglund Eric S & Nancy J [51] ▲218-729-9858
 NORTHERN EXPOSURE boat dirs sales & serv218-729-6566
 PROP SHOP propellers218-729-8304
 5454 GRACE LUTHERAN CHURCH churches218-729-9054
 5468 MAC'S LANDSCAPING CTR landscape contractors
218-729-6203
 + LINDAHL RD INTERSECTS
 5480 McDonald Myron M & Dorothy M [20] ▲218-729-5854
 5488 McDonald John E [51] ▲218-729-6405
 5492 Bracken Mary F [4] ▲
 5493 CASA LATTE LLC coffee shops218-729-7690
 5497 RADCO TRUCK ACCESSORY CTR truck canopies, caps & shells
218-729-5792
 ZIP CODE 55811 CAR-RT C026
 5501 MMT HEATING & COOLING air conditioning contrs & sys
218-729-1585
 ZIP CODE 55811 CAR-RT C040
 5544 Sanders Terry C [20] ▲218-729-6141
 5545 McGovern John D & Helen C [51] ▲218-729-9683
 5560 Degolier Connie L [2]
 + VAUX RD INTERSECTS
 5567 No Current Listing
 5572 ARROWHEAD CONCRETE WORKS INC concrete- ready mixed
218-729-8274
 5573 No Current Listing
 5577 Carlson Darlene E [6] ▲
 5580 No Current Listing
 5585 Carlson Hjalmar C & Mary E [20] ▲218-729-8929
 5589 Stevenson Philip G [51] ▲218-729-7041
 5595 No Current Listing
 5601 Curtis Frederick J & Joan L [51] ▲218-729-8327
 SUBWAY restaurants218-729-0199
 SUPER AMERICA serv stations- gasoline & oil218-729-5084
 5606 ARROWHEAD CONSULTING & TESTING envrmtl & ecolgcl
 serv218-729-0987
 5610 LINDA'S POOCHIE PARLOR pet washing & grooming
218-729-6404
 5612 DULUTH RANGE COMMUNICATION telephone equip & sys-
 serv/rpr218-729-8408
 5614 TOWN & COUNTRY BUILDERS INC garage builders
218-729-7887
 5620 Oftedal Gordon A [2] ▲
 5624 No Current Listing
 5625 Tiili Dale A [20] ▲218-729-6981
 5628 Keifer Malvern C [8] ▲
 Osberg Lloyd F [5] ▲
 5630 Larson David & Nancy J [18] ▲218-729-5338
 5632 No Current Listing
 + SEVILLE RD INTERSECTS
 BUSINESSSES 180 HOUSEHOLDS 84
 MILWAUKEE AVE (DULUTH)-FROM 343 W AUSTIN ST NORTH
 ZIP CODE 55803 CAR-RT C030
 4709 Robinson Scott D & Catherine J [20] ▲
 4715 Beasley Richard E & Norma J [21] ▲218-728-2714
 4719 Crain Katie E [51] ▲218-724-4015
 Crain Patrick A218-724-4015
 4721 No Current Listing
 4725 Kludinski Katherine M [16] ▲
 4731 Udd Darlene R [20] ▲218-728-4950
 + E CALVARY RD INTERSECTS
 HOUSEHOLDS 6
 MINE RD (ELY)
 ZIP CODE 55731 CAR-RT H003
 154 Johnson Linda S [2]218-365-4795
 Lakner Albert J [15]218-365-4077
 176 Rozman Mary A [11] ▲218-365-4583
 180 - 184 No Current Listing (2 Hses)
 HOUSEHOLDS 5
 MINERAL ST (DULUTH)
 ZIP CODE 55810 CAR-RT C037

MINERAL CENTER RD Cont'd

200 Hoaglund Richard [7] ▲218-475-239
 HOUSEHOLDS
 MINI POWER RD (DULUTH)-FROM 4901 LOCKWOOD LN
 ZIP CODE 55803 CAR-RT R004
 4930 No Current Listing
 4938 Jezierski Daniel J & Joyce [51] ▲218-729-614;
 HOUSEHOLDS :
 MINK RD (COTTON)-FROM 6501 COMSTOCK LAKE RD NORTH
 ZIP CODE 55724 CAR-RT H001
 9340 Van Evera Katharine [12] ▲218-482-360f
 Van Evera Evera K218-482-360f
 9379 Nelson Alan J [15] ▲
 Nelson Donna M
 HOUSEHOLDS ;
 W MINK RD (COTTON)
 ZIP CODE 55724 CAR-RT H001
 1102 ELLSBURG VOLUNTEER FIRE DEPT fire departments
218-482-3777
 + CAMERON DR BEGINS
 1163 Krienke Mark [2] ▲
 1166 Thies Charles & Nancy P [19] L218-482-3684
 1168 PIKE & PIKE nonclassified establishments218-482-5252
 Pike John F & Kim [13] ▲218-482-5252
 1182 Musburger Jeffrey M & Rebecca R [51] ▲218-482-3737
 1185 Bohlin Jamie A & Jennifer M ▲218-482-5566
 1192 Luczak Chester T [6]218-482-5277
 1193 Kinsley Kourtney218-482-3202
 Kinsley Bridget218-482-3202
 1194 Miller Steven W [6] ▲218-482-3417
 1198 Averill Harland R & Janet S [51] ▲218-482-3768
 1206 Duinski Jeffrey D [51] ▲218-482-3646
 1214 Anderson Reid R [23] ▲218-482-5535
 1222 Noyes Ilene B [16] ▲218-482-3280
 1224 Houle Jason A [51] ▲218-482-3312
 1230 Mercier Dennis J [10] ▲218-482-5256
 1286 No Current Listing
 1288 COUNTRY LIVING ADULT FOSTER foster care218-482-5589
 Maher Belty J & Roger L [51] ▲218-482-5589
 + BLACKBURN DR INTERSECTS
 + BLACKBURN DR CONTINUES
 + N WATER HEN RD ENDS
 BUSINESSSES 3 HOUSEHOLDS 16
 MINK LAKE RD (GRAND MARAIS)
 + TROUT LAKE RD CONTINUES
 MINK RANCH RD (TOFTE)
 ZIP CODE 55615 CAR-RT H003
 279 No Current Listing
 HOUSEHOLDS 1
 MINNEAPOLIS AVE (DULUTH)-FROM 301 E FARIBAULT ST NORTH
 + WOODLAND AVE CONTINUES
 ZIP CODE 55803 CAR-RT C038
 6 Bubar Ronald [4] ▲
 10 Boileau Jim E Jr [4] ▲
 Macgregor Heather
 18 Stafne Thomas E & Merlinda M [17] ▲218-728-2884
 20 Ridge Mark C ▲
 21 Zbaracki Thomas J Jr & Mary A [19] ▲218-724-4992
 22 No Current Listing
 24 Snider Andrew D ▲218-464-4449
 Snider Elyse C218-464-4449
 26 - 29 No Current Listing (2 Hses)
 34 Wronka Hans A [8] ▲218-728-7902
 Wronka Reva218-728-7902
 35 No Current Listing
 38 Zorbas John F [30] ▲218-724-5651
 43 Cohen Claudia L [20] ▲218-728-3967
 44 No Current Listing
 102 Leino William M [8] ▲218-728-2673
 109 Pell Louise A [21] ▲218-724-0644
 114 No Current Listing
 115 Solberg Molly A [51] ▲218-724-8473
 Solberg Shannon D218-724-8473
 119 Landstrom Brady L & Wendy M [11] ▲
 122 Ellingson Craig R & Barbara J [51] ▲218-724-7220
 123 Zagrabely Matthew P & Jodi M [10] ▲218-724-4529
 + WADENA ST INTERSECTS
 + WADENA ST CONTINUES
 201 - 208 No Current Listing (3 Hses)
 210 Eells Kevin A [10] ▲218-728-2706
 211 No Current Listing
 218 Korte Lisa M [2] ▲
 219 Beaulieu Dorian J & Julie A [14] ▲218-724-3059
 + OSAKIS ST INTERSECTS
 + OSAKIS ST CONTINUES
 301 Langenbrunner Susan M [17] ▲
 302 Hoivik Egil & Gudrun S [24] ▲218-728-2915
 305 - 306 No Current Listing (2 Hses)
 309 Halligan Linda J [51] ▲
 310 Simmonds Jay E [51] ▲218-728-4685
 313 Johnson Bradley A ▲218-728-1322
 314 Krivogorsky Bogdana A218-464-4123
 Krivogorsky V218-464-4123
 318 Mansson Michael J [3] ▲
 Mansson Sascha L
 321 Wittich Glenn C & Norma J [46] ▲218-724-4880
 + ISANTI ST INTERSECTS
 + ISANTI ST CONTINUES

2010
 City Directory

INQPCL
Data Set: PRD Production

Parcel Description

1/14/14
16:15:13

Parcel/Acct : 395-0010-00702 191855 Asmt/Tax year: 2013 2014 Type: RE
Pri. owner : 656559 Unit . . . : Hold tax stmt:
CURTIS FAMILY LIMITED PARTNERSHIP Emergency # :
Taxpayer . : 44712 FALCO: 5 OTHER Escrow . . . :
JUNCTION FOOD N FUEL Surveyed . . . : Notes :
Ref. parcel : Com district: 0 UDI . . : 100.00%
Lake #/Name : MH court nbr: Billing: P
Physical adr: TIF district: KD date:
User defined:
Acres . . . : .53 UTA-Twp/City: 395 CITY OF HERMANTOWN
Lot/Block . . : School . . . : 700 SCHOOL DIST. 0700
Plat/Desc . . : SCHL WORS SAND SPCL
Sec/Twp/Rge : 4 50.0 15 00 02 00 00
Description : PART OF SW 1/4 OF NW 1/4 BEGINNING AT A <--Version: 1
POINT ON NLY LINE OF HWY 163 53/100 FT
SE OF W LINE THENCE 90 DEG NELY 155 FT

more...

Press Enter to continue or enter new parcel/tax year: 395-0010-00702 2014
F1=Help F2=Trans History F3=Exit
F6=Parcel History F7=Name/Addresses F8=Legal F24=More keys

— ST. LOUIS COUNTY ASSESSOR
14TH JANUARY 2014

CSTIMPD-1 PRD Production Cost Approach CRV: Display 1/14/14

Parcel/Asmt yr: 395-0010-00702 2013 Imp schedule: 2009 Depreciation factors:
Improvement: 1 COM RETAIL STR Physical MARKET .99
House/Garage Asmt Rcd 1 %Cmp 1.00 Functional incurable .95
Construction Class/quality > C A %New Economic HRMCMT 1.00
Actual/Eff year built 1946 2008 Condition Additional00
Notes: OLD SERVICE STATION/C-STORE "CUTE" Total percent good: .941

2=Change 3=Copy 4>Delete 5=Display Eff Rate 1.00 RCNLD

O -- Characteristics/Areas -- Wid Len Units Str Fdt Wal O
005 STYLE/TYP RTL RETAIL ST
010 CLSS C EX O OTHER
011 CLSS D EX
012 CLSS P EX
013 CLSS S EX
020 INT WALLS F STUD FRAM
030 CEILING DRY DRYWALL
040 ELEC/LIGH S STANDARD

Eff BAS rate: 64.54 Grd floor area: 1164 Replacement cost new: 84051
Grs floor area: 1164 Less depreciation: -4959
Last calc date/value: 03/13/2013 79092 = RCNLD: 79092

F8=First area line F9=Sketch F10=Photo F24=More keys